

## INCLUDED IN KIT:

SHN1



X2

SHW1



X2

TPU1



X4

HRP1



X2

CP1



X2

CB15S



X12

NL38



X12

## TOOLS REQUIRED:

9/16" SOCKET WITH RATCHET TO SUIT or  
BOX WRENCH

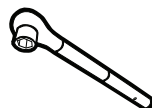

OR

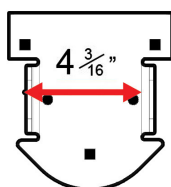

Narrow Mouth (SHN1)

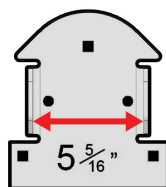

Wide Mouth (SHW1)

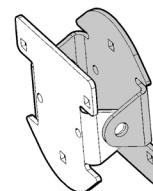
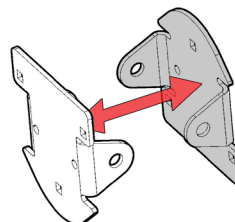

Each pair of hinges will be identified by a narrow and wide mouth (See above image).  
The narrow mouth bracket will fit into the wide bracket of each pair.

1

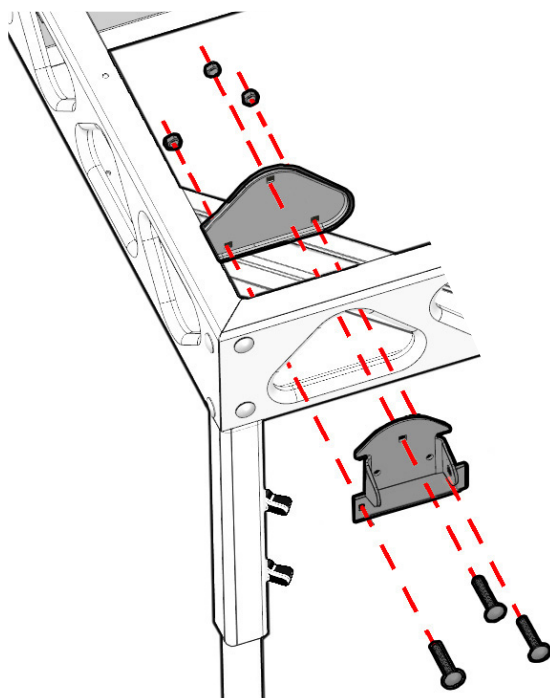

NL38



X3

TPU1



X1

SHN1



X1

CB15S



X3

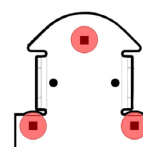
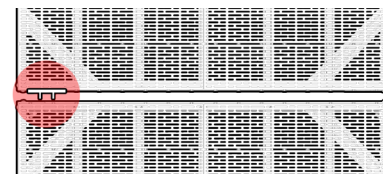

Connect the hinge assembly as shown above.

**PLEASE NOTE:** The decking has been removed from the above image and any proceeding images to better illustrate installation.

2

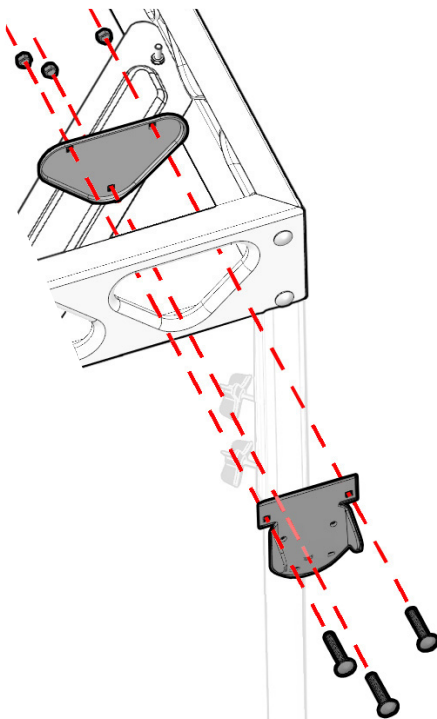

NL38



X3

TPU1



X1

SHW1



X1

CB15S



X3

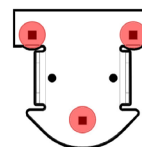
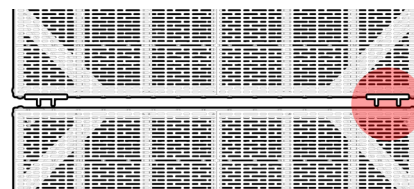

Connect the hinge assembly as shown above.

3

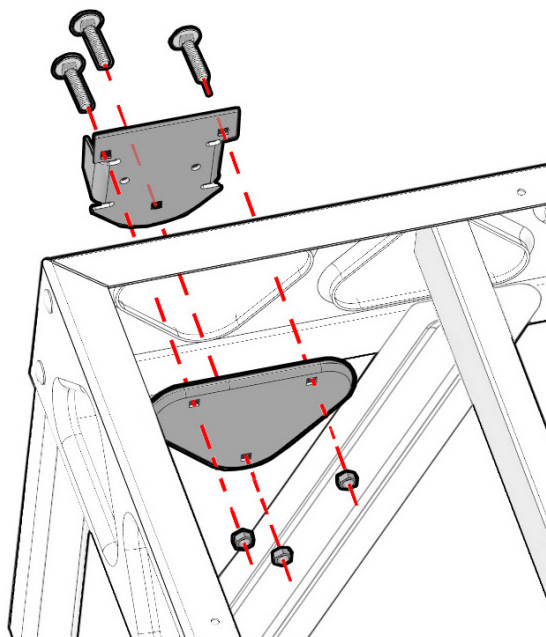

CB15S



X3

SHW1



X1

TPU1



X1

NL38



X3

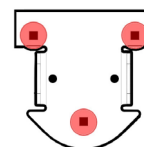
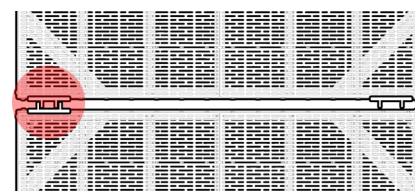

On the opposite dock connect hinge assembly as shown above.

4

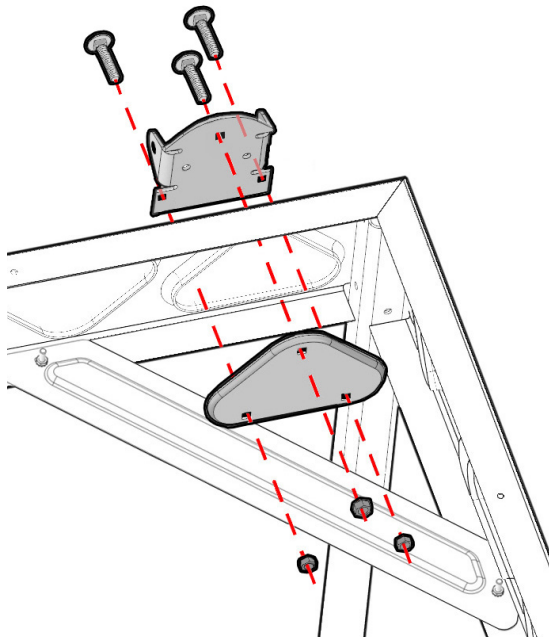

CB15S  X3

SHN1  X1

TPU1  X1

NL38  X3

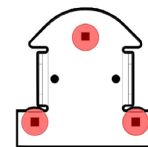
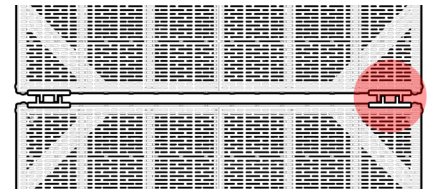

Connect the hinge assembly as shown above.

5

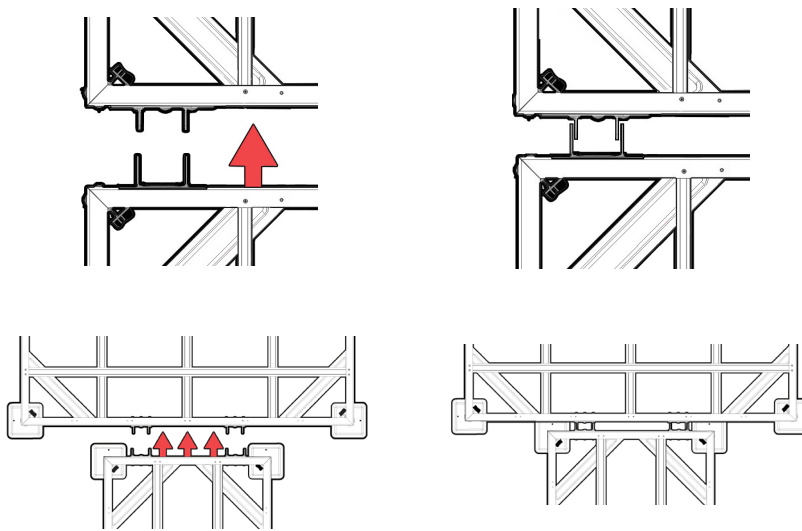

8x8 to 8x8

4x4 to 4x4

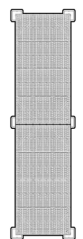
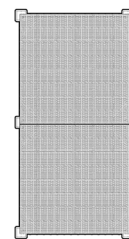

8x8 to 4x4

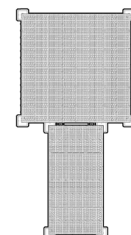

Once hinges (HP1) on both docks are assembled pull both docks close to each other. Place the docks so the edges of both docks are aligned with one another. Align the hinges on either side of the docks so they fit into each other (See images above). Ensure that the holes between both hinges line up with one another. Do the same for the hinges on the opposite side of both docks.

6

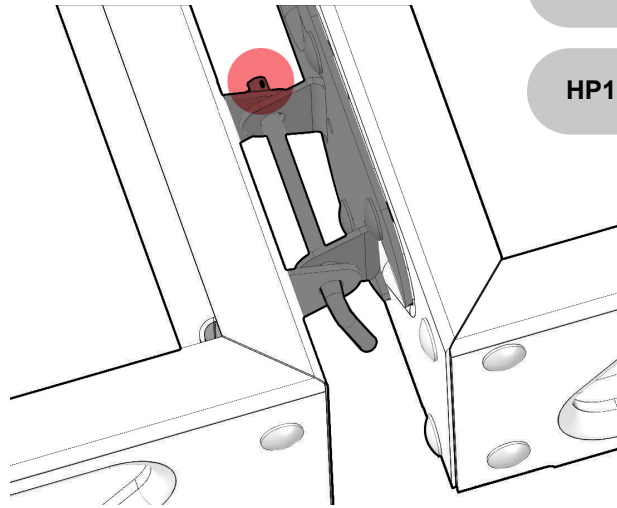
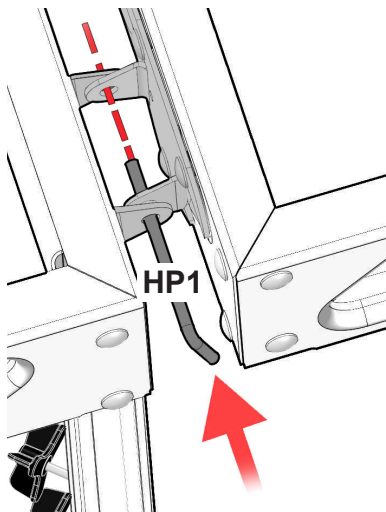

CP1  X2

HP1  X2

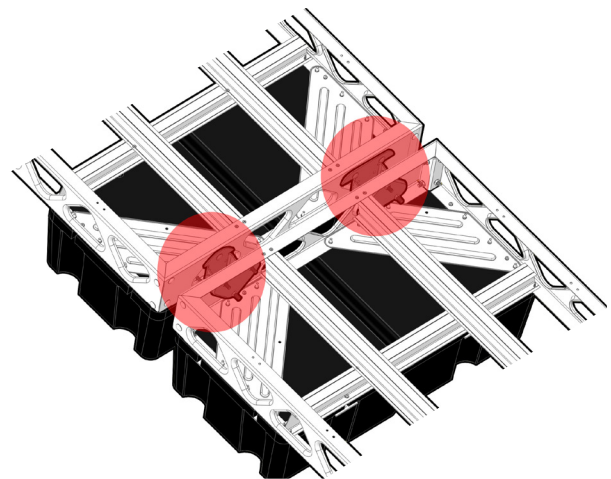
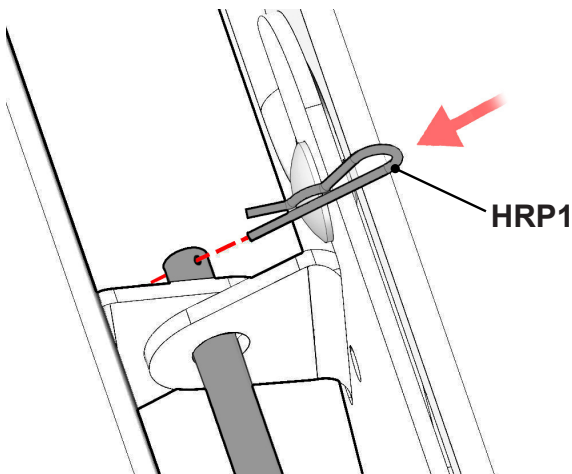

Fasten hinge as shown. Repeat **Step 6** for hinge assembly on the opposite end of the dock.

**PLEASE NOTE: It may be helpful to use locking pliers to insert the hair pin into the hinge pin.**

When separating dock sections follow the above directions in reverse removing the Hair Pin (CP1) and then removing the Hinge Pin(HP1) from between the hinges.