

INCLUDED IN HINGE KIT:

HC4 (4 Ft Hinge Cover)
HC8 (8 Ft Hinge Cover)

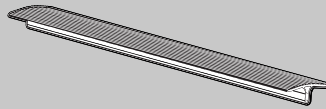

X1

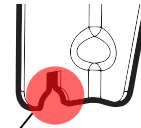

PLEASE NOTE: The notch cut-out at bottom of bracket indicates it is the right sided bracket

HBL1
(Left Sided)

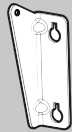

X1

HBR1
(Right Sided)

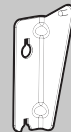

X1

B25125



X1

TOOLS NEEDED:



9/16" Box
Wrench

OR



Ratchet
with 9/16" Socket

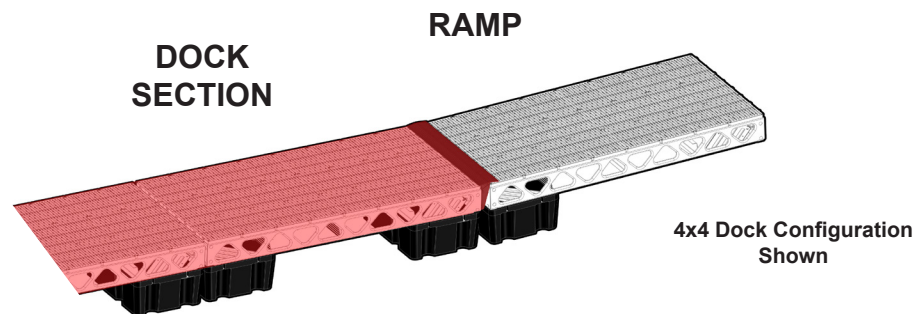

On dock systems that transition from same size docks
(4x8 to 4x8 docks or 8x8 to 8x8 docks)
ensure the hinge cover bracket is installed to the **dock section**.

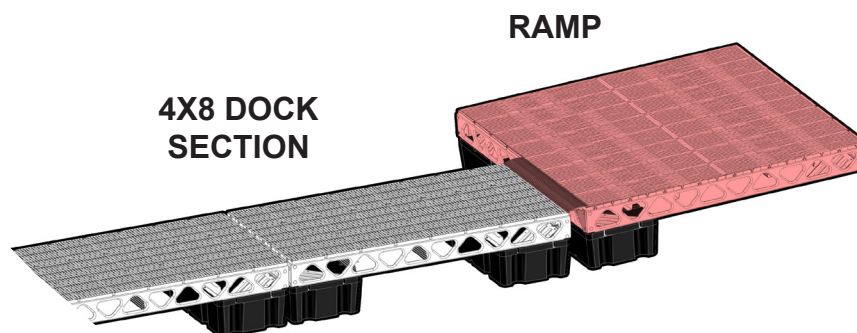

On dock configurations that transition between 4x8 and 8x8 docks
ensure the hinge bracket is installed to the **4x8 section**.

1

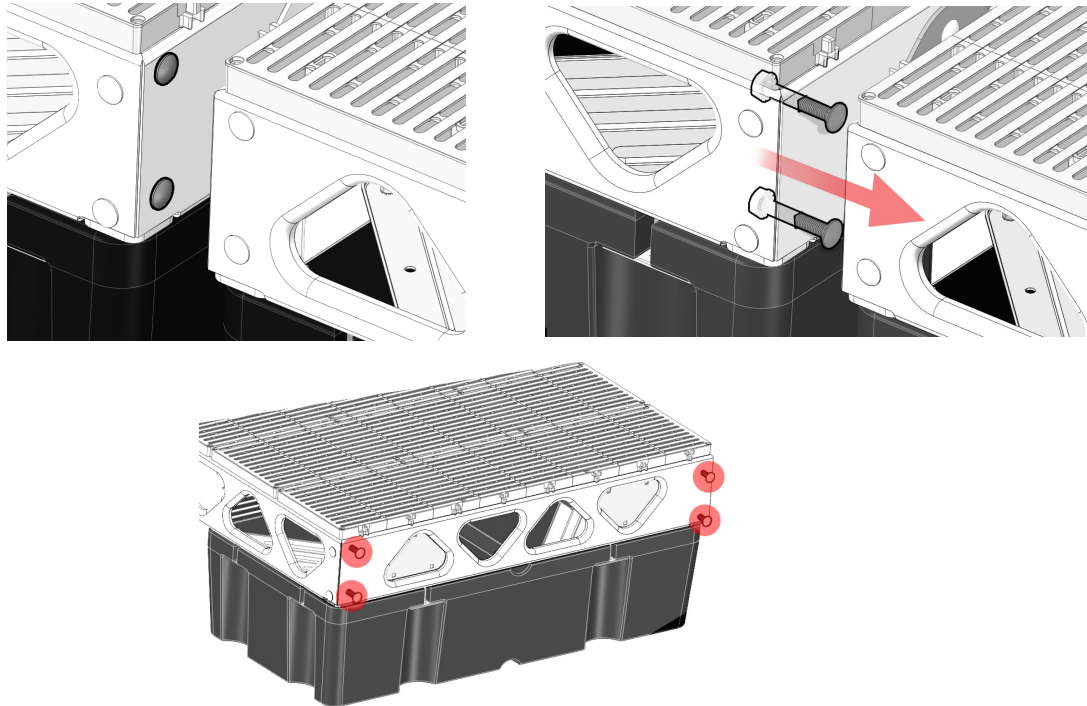

Using a socket/ratchet or box wrench, loosen carriage bolts on both dock or ramp that you will be attaching the hinge cover to (See image above for carriage bolt locations).

PLEASE NOTE: Some components have been removed from the following images to better illustrate assembly.

2

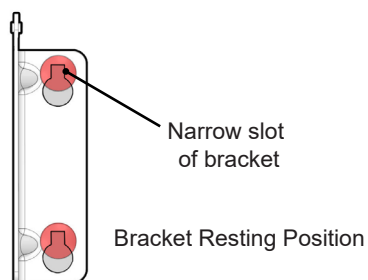

HBL1
(Left Sided)

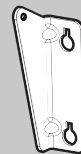

X1

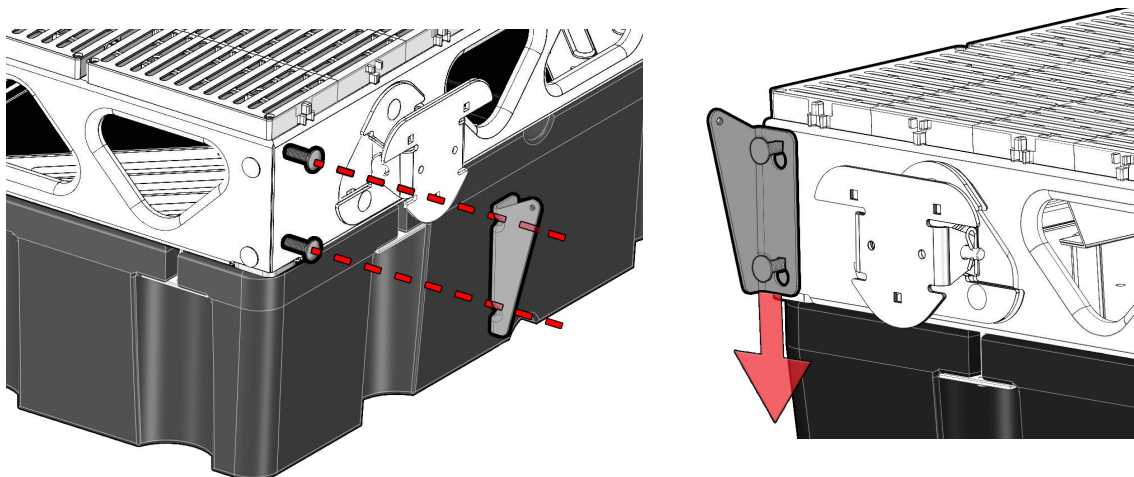

Attach the hinge cover bracket(HBL1) to the loosened carriage bolts at the end of the dock or ramp. Slide the hinge cover bracket(HBL1) down on the carriage bolts until they are seated in the narrow slots of the bracket.

3

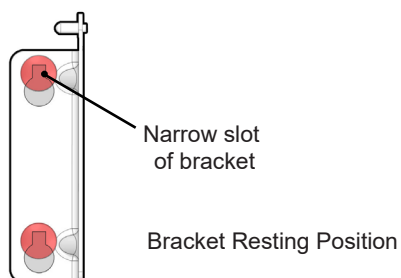

HBR1
(Right Sided)

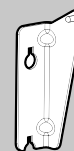

X1

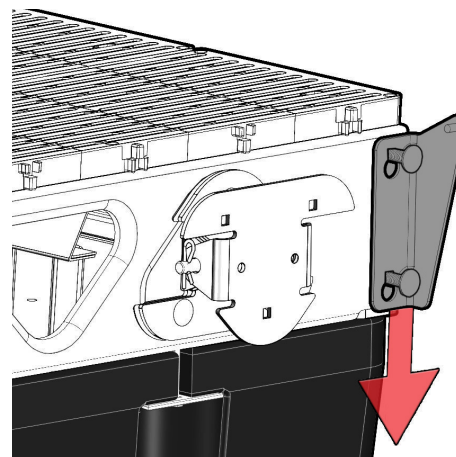
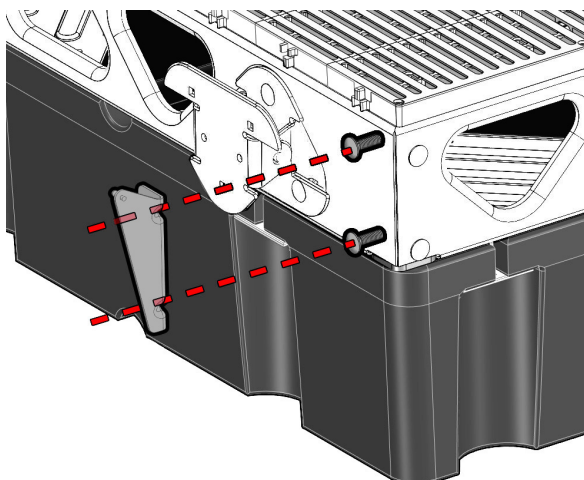

Attach the hinge cover bracket(HBR1) to the loosened carriage bolts at the end of the dock or ramp. Slide the hinge cover bracket(HBR1) down on the carriage bolts until they are seated in the narrow slots of the bracket.

4

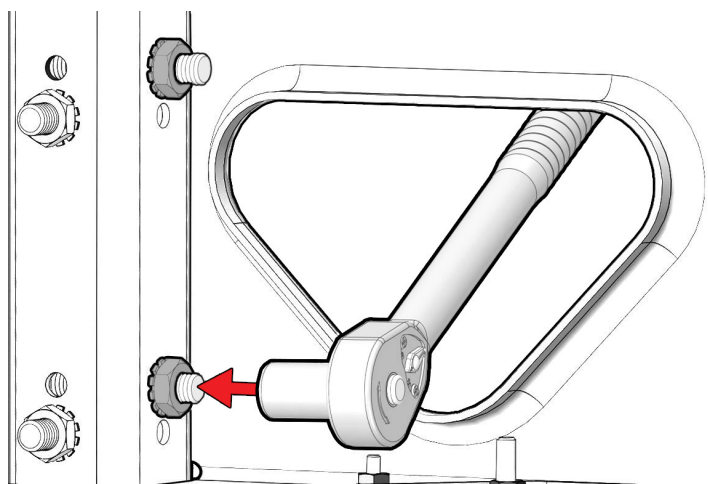

Retighten the carriage bolts on both brackets that were installed.

PLEASE NOTE: Some components have been removed from the image to better illustrate assembly.

5

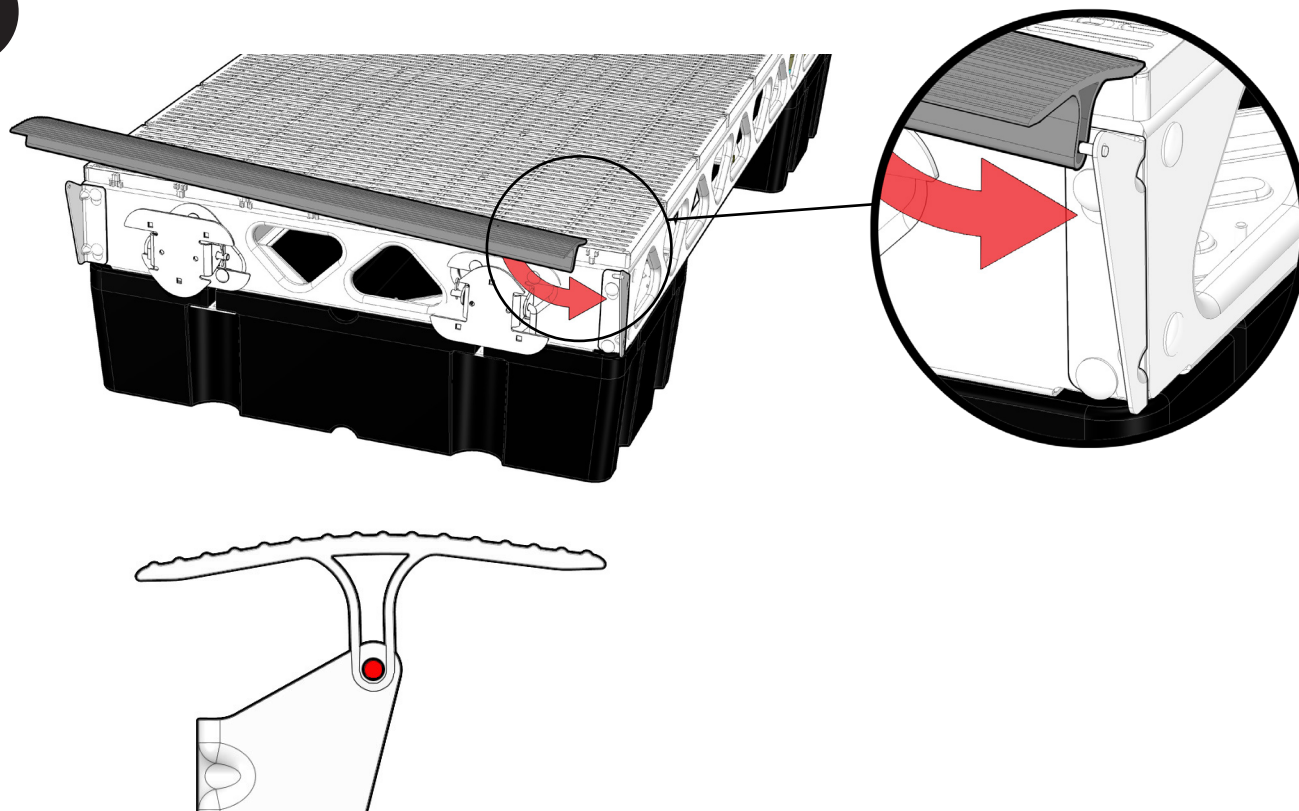

Position and slide the hinge cover onto the pin located at the top of the hinge cover bracket(HBR1).

6

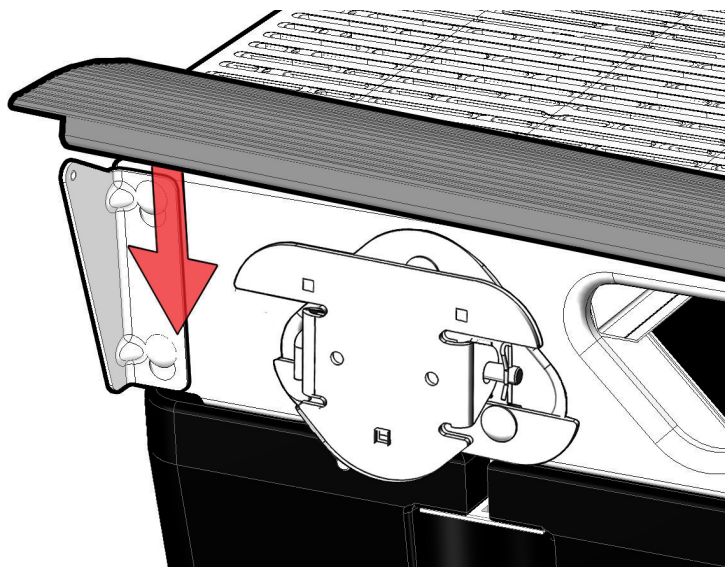

7

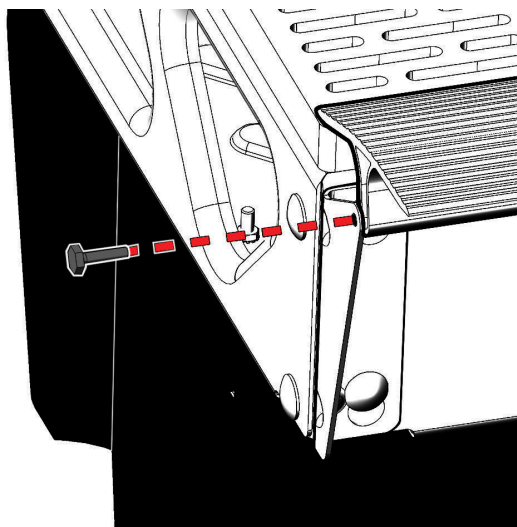

B25125



X1

8

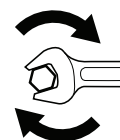
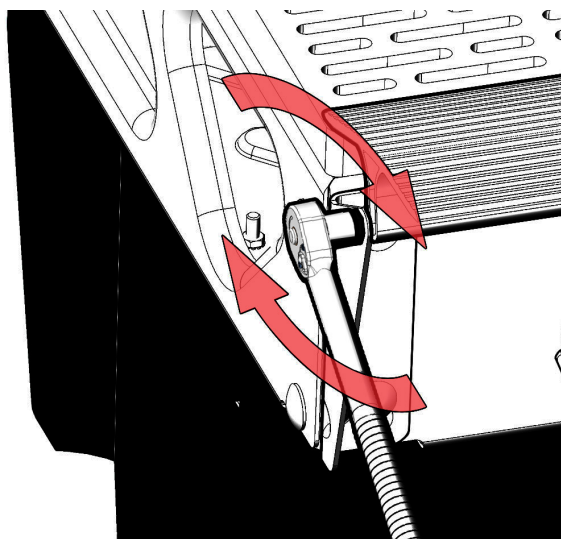

DO NOT OVERTIGHTEN

9

