



5.7L V10, 4.6L V8 AND 3.4L V6

200- 350HP

SeaPro™

RELIABLE, POWERFUL & EFFICIENT

- Engineered for maximum durability and reliability
- High-displacement powerheads make tackling tough conditions and moving heavy loads a breeze
- Lightweight design and Advanced Range Optimization maximize fuel economy at cruise

MORE INTUITIVE, MORE REFINED, MORE OPTIONS

- Exceptionally smooth, quiet and intuitive operation
- Intelligent battery-management technology and high-output alternators

LEARN MORE AT MERCURYMARINE.COM/SeaPro



 **MERCURY**
GO BOLDLY.™

EVERY DAY, EVEN IN THE TOUGHEST CONDITIONS, SEAPRO HIGH-HORSEPOWER OUTBOARDS ARE BUILT TO TACKLE THE BIGGEST JOBS.

ENGINEERED FOR EXTREME RELIABILITY AND DURABILITY

Heavy-duty components designed to handle the toughest conditions. Advanced corrosion-preventive finishes to withstand the rigors of saltwater. Sealed electrical connections to ward off the elements. Mercury SeaPro outboards are engineered to deliver performance you can count on.

You need an outboard that works as hard as you do. That's why Mercury engineered its high-horsepower SeaPro outboards to generate ample torque at low rpm levels, so you can work your outboard hard without placing excess stress on the engine.

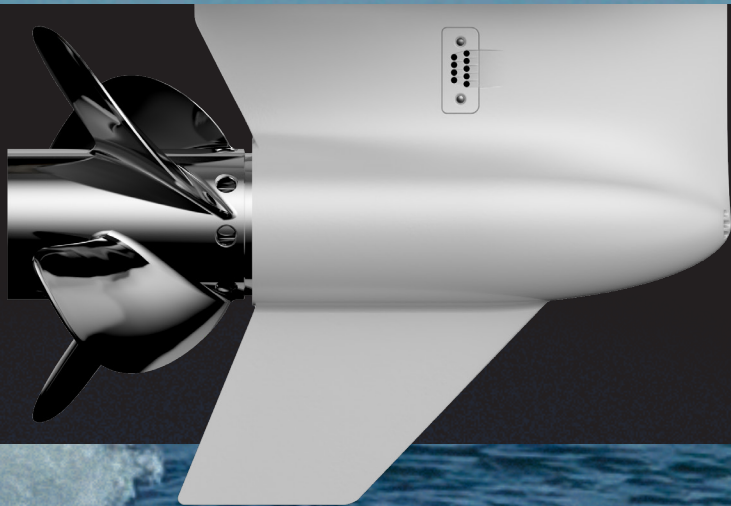
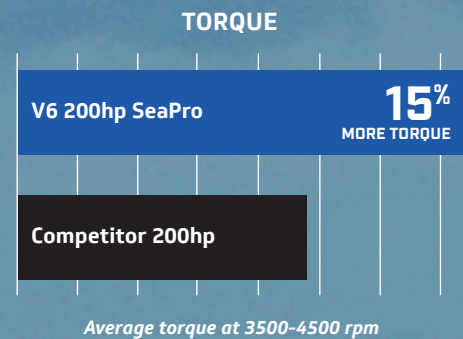

HEAVY-DUTY GEARCASE

- The 200 to 350hp SeaPro engine gearcases are validated at three times the lifespan of a recreational gearcase.
- The V10 SeaPro engine features a durable 6.4-inch gearcase with advanced hydrodynamics for efficiency and control.

HIGH DISPLACEMENT IN A LIGHTWEIGHT, COMPACT PACKAGE

Lightweight and powerful, the 5.7L V10 350hp SeaPro engine delivers class-leading acceleration and exceptionally quiet performance. It's also capable of mounting on 26-inch centers for easy repower installation in single- or multi-engine applications.

With their high-displacement powerheads, V8 and V6 SeaPro outboards provide plenty of muscle to get the job done. And each Conventional MidSection (CMS) 200-300hp model is the lightest engine in its class.

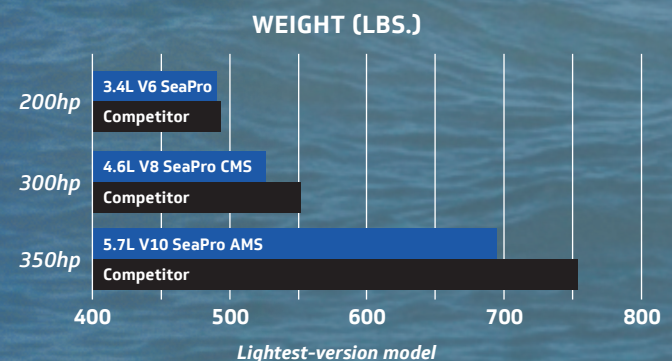
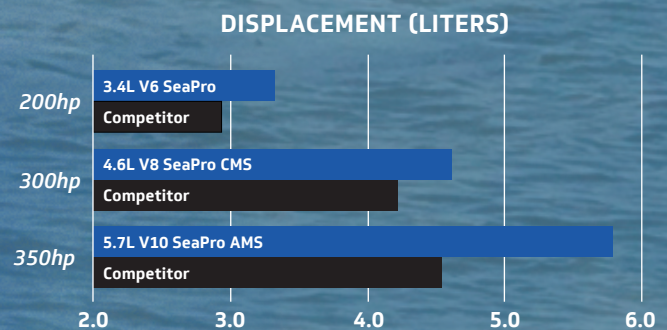

INTUITIVE, INNOVATIVE FEATURES

The **Adaptive Speed Control** feature lets you maintain engine rpm despite changes in load or conditions, with no throttle adjustment.

When needed, the **idle charge battery management system** works for you by monitoring battery voltage and adjusting engine rpm at idle to boost alternator output.

SeaPro **high-output alternators** help support a heavy load of onboard accessories with up to 150 amps of alternator output from the 350hp outboard.

EXCEPTIONALLY SMOOTH AND QUIET

- V8 300hp SeaPro CMS – 15-30% quieter and 30% less transmitted vibration than a leading four-stroke competitor
- V6 200hp SeaPro – 15-30% quieter and 50% less transmitted vibration than a leading four-stroke competitor
- V10 350hp SeaPro – 28% quieter at cruise than a leading four-stroke competitor

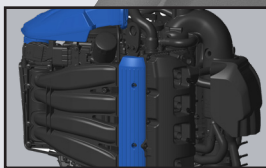

NOISE MANAGEMENT

- Precision-tuned intake and exhaust, combined with fuel-injector covers, minimize noise for more comfortable all-day operating

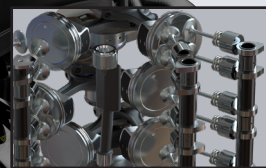

FOURSTROKE TECHNOLOGY

- Provides greater durability, reliability and fuel economy with lower emissions compared to traditional two-stroke outboards used in commercial applications

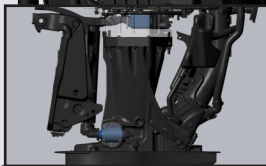

ENGINE MOUNTS

- Upper and lower mounts provide the best balance of performance, durability and low vibration
- The Advanced MidSection mounting system (standard on 350hp; available for 300hp) nearly eliminates vibration, for the smoothest ride on the water



COWL SEALING

- Multiple sealing features keep out moisture and reduce engine noise

EASY MAINTENANCE

SeaPro outboards were optimized so you can spend less time on maintenance and more time on the clock.

- Industry-exclusive top-cowl access door eliminates hassle, allowing you to check or top off oil without removing the cowl.
- Color-coded touch points speed up routine checks to get you underway faster.
- Gearcase oil can easily be drained from the torpedo.
- High-horsepower SeaPro outboards ship with a boat-mounted water-separating fuel filter kit.

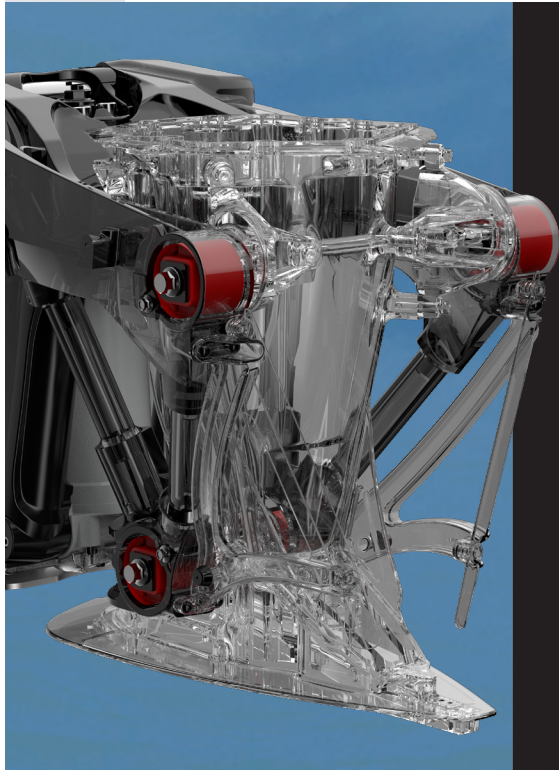

EXCLUSIVE ADVANCED MIDSECTION (AMS)

Standard for 350hp SeaPro
Available for 300hp SeaPro

AMS models in multi-engine configurations are available with Joystick Piloting for Outboards (JPO) and the latest Electric Steering system. JPO provides fingertip control to move forward, sideways or even rotate in place. Quiet and responsive, Electric Steering eliminates hydraulics, saving space in the boat while reducing electrical power consumption by more than 50% over electro-hydraulic steering.

EFFICIENT ALL-AROUND PERFORMANCE

SeaPro outboards are calibrated to deliver full performance on 87-octane fuel, with a host of efficiency-enhancing features such as a hydrodynamic gearcase, closed-loop fuel system and Advanced Range Optimization (ARO) that optimize fuel economy so you can get more done on every tank.

CRUISE FUEL ECONOMY

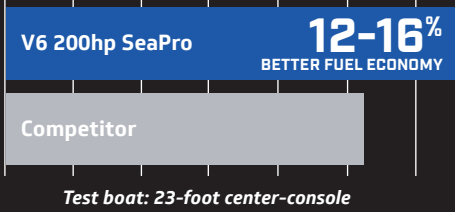

HORSEPOWER	200	225	250	300	300 AMS	350
WOT RPM	4600-5400	4800-5600	4800-5600	4800-5600	4800-5600	5300-5900
Engine Type	V6 (24-valve, DOHC)	V8 (32-valve, DOHC)	V8 (32-valve, DOHC)	V8 (32-valve, DOHC)	V8 (32-valve, DOHC)	V10 (40-valve, DOHC)
Displacement	3.4L (209 CID)	4.6L (279 CID)	4.6L (279 CID)	4.6L (279 CID)	4.6L (279 CID)	5.7L (349 CID)
Induction	Naturally aspirated, performance-tuned intake manifold	Naturally aspirated, performance-tuned intake manifold	Naturally aspirated, performance-tuned intake manifold	Naturally aspirated, performance-tuned intake manifold	Naturally aspirated, performance-tuned intake manifold	Naturally aspirated, performance-tuned intake manifold
Starting	Electric start with SmartStart protection	Electric start with SmartStart protection	Electric start with SmartStart protection	Electric start with SmartStart protection	Electric start with SmartStart protection	Electric start with SmartStart protection
Gear Ratio	1.85:1	1.75:1	1.75:1	1.75:1	1.75:1	2.08:1
Alternator	85 amp (1071 watt)	85 amp (1071 watt)	85 amp (1071 watt)	85 amp (1071 watt)	115 amp (1449 watt)	150 amp (1890 watt)
Trim System	Power trim and tilt	Power trim and tilt	Power trim and tilt	Power trim and tilt	Power trim and tilt	Power trim and tilt
Dry Weight*	483lbs (220kg)	527lbs (239kg)	527lbs (239kg)	527lbs (239kg)	600lbs (272kg)	695lbs (316kg)
Steering	Hydraulic (standard) Power (option) Big Tiller (option)	Hydraulic (standard) Power (option) Big Tiller (option)	Hydraulic (standard) Power (option) Big Tiller (option)	Hydraulic (standard) Power (option) Big Tiller (option)	Electro-hydraulic JPO (option)** Electric (option)**	Electro-hydraulic JPO (option)** Electric (option)**
Shaft Length	20 in (508mm) 25 in (635mm)	20 in (508mm) 25 in (635mm) 30 in (762mm)	20 in (508mm) 25 in (635mm) 30 in (762mm)	20 in (508mm) 25 in (635mm) 30 in (762mm)	20 in (508mm) 25 in (635mm) 30 in (762mm)	20 in (508mm) 25 in (635mm) 30 in (762mm) 35 in (889mm)

*Dry weight: Lightest-version model, excludes engine oil, rigging, hardware. **JPO and Electric Steering available for multi-engine boats with AMS outboards.