

SPECIFICATIONS:

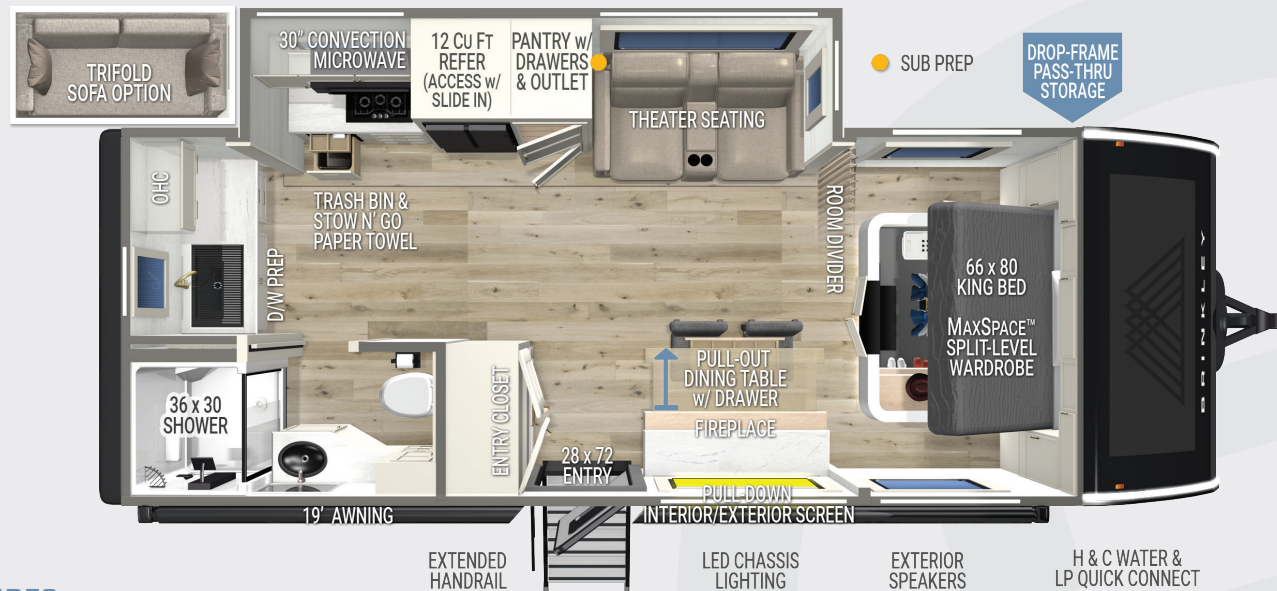

FEATURES:

- Seamless Laminated Aluminum Exterior
- Smart Projector w/ Interior/Exterior Pull-Down Screen
- 62" Wall Hugger Theater Seating w/ 2 Recliners
- Dishwasher Prep
- Pull-Out Dining Table w/ Fireplace (Seats up to 4)
- Pull-Out Trash Bin w/ Utility Storage
- Large Pantry w/ Pull-Out Drawers & Appliance Outlet
- Premium Residential Cabinets & Drawers
w/ Dovetail Joints
- Kitchen/Living Room Flush Floor Stepless Slide-Out
- 18k Chill Cube AC
- King Bed w/ Residential 7" Memory Foam Bamboo
Mattress (66"x80")
- Dual Bedside Wardrobes & Nightstand Cubby w/ USB
& USB-C Charging Ports (CPAP Ready)

- Brinkley MaxSpace Split-Level Wardrobe™ w/ Hanging Closet, Shelves, & Hamper
- 76" x 45" Picture Perfect Front Window w/ Insulated Blackout Privacy Shade
- One-piece 36"x30" Fiberglass Shower
- Square Euro Frameless Windows w/ 6" Openings
- Integrated Blackout Shades w/ Reflective Insulation
- Brinkley Automotive-Grade Sealant Package
- Extended Entry Latch
- Sleek Styling w/ Automotive-Grade Exterior Graphics
- 2 – Hot/Cold Outdoor Showers (BOTH Sides of Coach)
- Tankless On-Demand Water Heater
- Rockford Fosgate Sound System w/ Subwoofer Prep
- Heated & Enclosed Underbelly (Circulated Forced Air)
- 4-Point Power Stabilizer Jack System

- UVW – 6,891 lbs.
- GVWR – 8,495 lbs.
- Hitch Weight – 610 lbs.
- Exterior Length – 26' 11"
- Overall Height w/ AC – 11' 4"
- Width – 96"
- Interior Height - 81"
- Slide Height - 72.5"
- Axles – Tandem 4,400 lbs.
- Wheels & Tires – 15" E-Rated (10 ply)
- Fresh Water Capacity – 55 gal
- Gray Water Capacity – 45 gal
- Black Water Capacity – 45 gal
- Insulation – Floors/Ceiling R40, Walls R9

FACTORY OPTIONS:

- Dual Pane Windows \$1,731
- 62" Trifold Sofa (50"x70 Sleeper) \$428



For More Information, Photos, Videos
& Why Brinkley go to **BrinkleyRV.com**

