

ASSEMBLY

Overview

- Remove packaging materials from snow thrower.
- Rotate Handle into the upright position. Refer to Handle Assembly.
- Install the chute. Refer to Chute Assembly Options.
- Complete snow thrower assembly according to model and equipment. Refer to Set-Up on page 9.
- Add fuel and oil. Refer to the Engine Operator's Manual shipped with snow thrower.

Tools Required

- Adjustable Wrench or Socket Set
- Needle Nose Pliers

Handle Assembly

1. Remove the wing knob (a) and carriage bolt (b) from the top of the lower handle (Figure 1). It is not necessary to remove the shoulder screw and flange lock nut below the wing knob and carriage bolt unless the handle is loose in the carton.

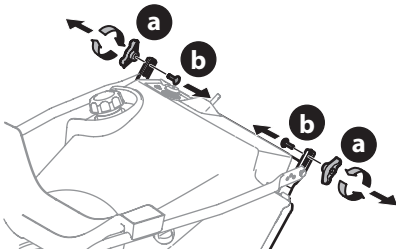

Figure 1

2. Pivot the upper handle into the operating position. Be sure not to pinch any of the cables in the process (Figure 2).

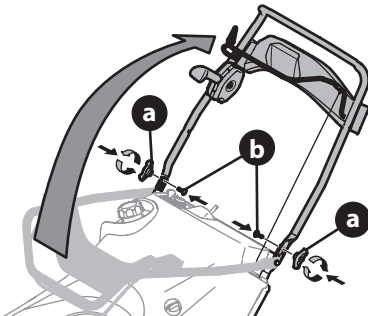

Figure 2

3. For models with an adjustable handle (a) (Figure 3), proceed with Step 4. For models without adjustable handle (b) (Figure 3), tighten the hardware removed in Step 1 (Figure 1). Continue to Chute Control Styles on page 7.

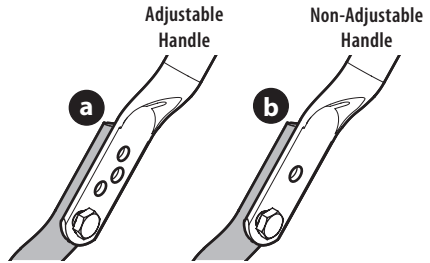

Figure 3

4. On models with adjustable handles, place the handle in the desired position and then install wing knobs (a) and carriage bolts (b) in the appropriate hole and secure the handle (Figure 4).

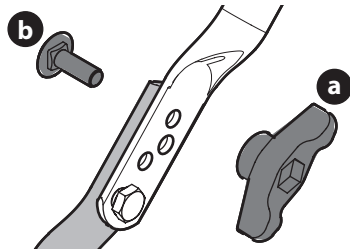

Figure 4

● STOP

Refer to Figure 5 in Chute Control Styles on page 7 to identify your "Chute Control Style" and continue to Chute Assembly instructions for your specific style on pages 8-9.

ASSEMBLY

Chute Control Styles

E-Z Chute™ see page 7.

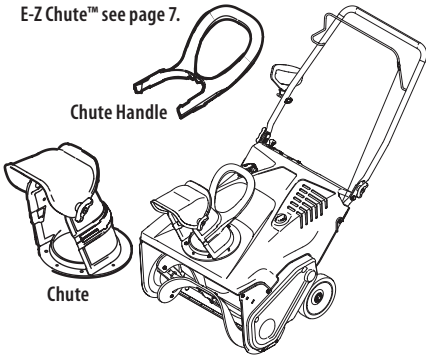

Upper Chute Rotation Control see page 8.

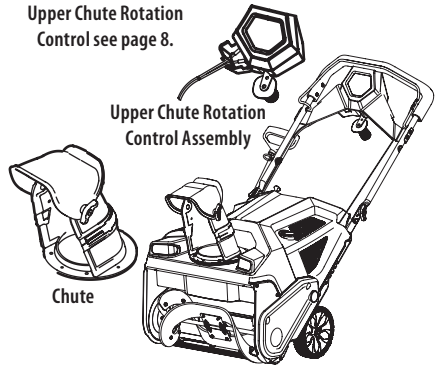

2-Way Chute Rotation Control with Remote Chute Pitch see page 8.

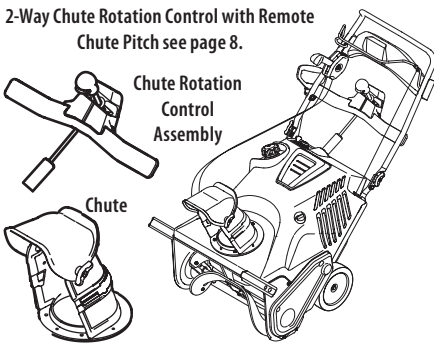

Lower Chute Rotation Control see page 9.

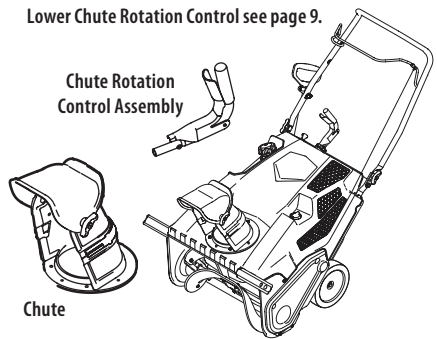

Figure 5

Chute Assembly

E-ZCHUTE™

1. Place the chute handle (a) onto the chute (b) (Figure 6). Be certain that the handle is aligned in the channel on the chute and the tabs snap into place.

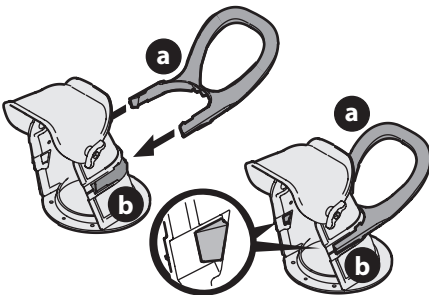

Figure 6

2. Remove the hex washer screws (c) in the chute base (Figure 7).

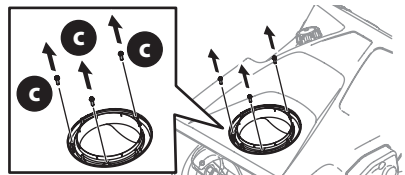

Figure 7

3. Align the holes in the chute base with the three tabs (d) in the lower chute (Figure 8, Inset). Secure the chute base with the hex washer screws (a) removed in Step 2 (Figure 8).

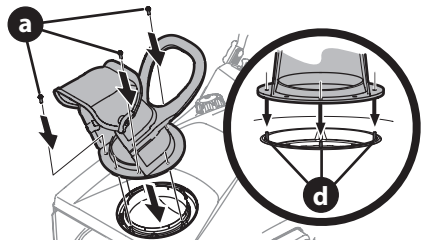

Figure 8

ASSEMBLY

● STOP

Continue to Set-Up (page 9).

UPPER CHUTE, 2-WAY CHUTE & LOWER CHUTE ROTATION CONTROLS

1. If not already done, install the chute plug (a) onto the chute (b) (Figure 9). Be certain that the plug is aligned in the channel on the chute and that the tabs snap into place.

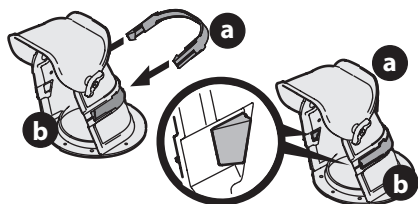

Figure 9

2. Remove the hex washer screws (c) in the chute base (Figure 7).
3. Align the holes in the chute base with the three tabs (d) in the lower chute (Figure 8, Inset). Secure the chute base with the hex washer screws (a) removed in Step 2 (Figure 8).

● STOP

Continue to Installing the Chute Rotation Control (If Equipped) on page 8.

Installing the Chute Rotation Control (If Equipped)

NOTE: Refer to Figure 5 and continue to your applicable chute style.

UPPER CHUTE ROTATION CONTROL

If your snow blower comes equipped with an upper chute rotation control, the chute rotation assembly will come installed on the upper handle.

● STOP

Continue to Set-Up (page 9).

2-WAY CHUTE ROTATION CONTROL WITH REMOTE CHUTE PITCH

1. Remove the hex washer screws (a) from the back of the handle (two on each side) (Figure 10).

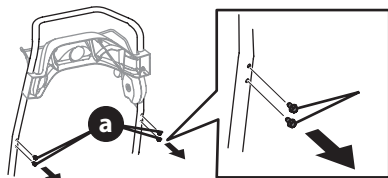

Figure 10

2. Using the hex washer screws (a), install the chute rotation control assembly (Figure 11).

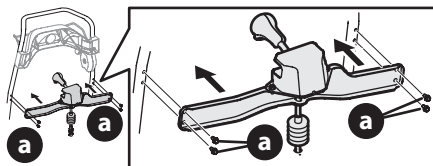

Figure 11

3. Remove the screw (c) and hex lock nut (d) from the universal joint (Figure 12).

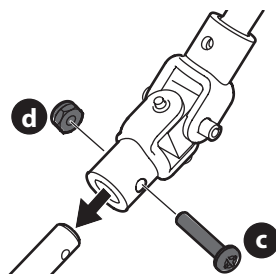

Figure 12

NOTE: Make sure the chute is facing forward when installing the universal joint.

4. Install the universal joint on the end of the chute rod (Figure 12).

NOTE: Be sure the holes in the universal joint line up with the holes in the chute rod. You may have to activate the trigger to allow you to line up the holes.

5. Secure the universal joint with the hex lock nut (b) and screw (a) removed in Step 3 (Figure 12).
6. Slide the rubber bellow over the universal joint (Figure 13).

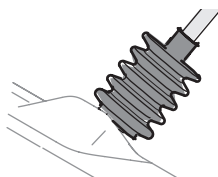

Figure 13

● STOP

Continue to Set-Up (page 9).

ASSEMBLY

LOWER CHUTE ROTATION CONTROL

1. Remove the hex lock nut (a) and machine screw (b) from the chute rotation control assembly (Figure 14, Inset A).

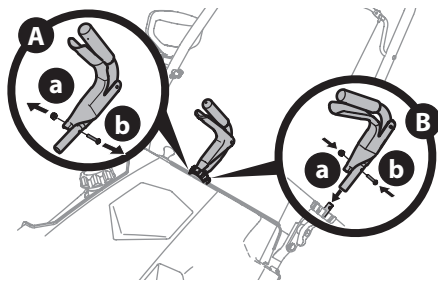

Figure 14

2. Place the chute rotation control assembly onto the chute rotation rod, align the holes and secure with the hex lock nut (a) and machine screw (b) (Figure 14, Inset B).

● STOP

Continue to Set-Up (page 9).

Set-Up

INSTALLING THE RECOIL STARTER HANDLE ONTO THE UPPER HANDLE

1. Remove the eye bolt and handle knob from the manual bag.
2. Place the eye bolt (a) and handle knob (b) on the upper handle (Figure 15, Inset A). Do not fully tighten the hardware until instructed to do so.

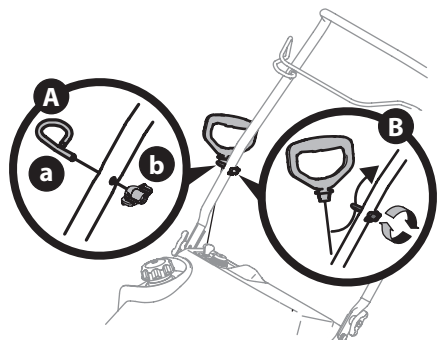

Figure 15

NOTE: The opening of the eye bolt (a) should face toward the back of the snow blower.

3. Slowly pull the recoil starter handle up towards the eye bolt (a).
4. Slip the recoil starter rope into the eye bolt (a) from the back of the snow blower (Figure 15, Inset B).
5. Securely tighten the eye bolt (a) and handle knob (b).

INSTALLING THE DRIFT CUTTERS (IF EQUIPPED)

1. Remove the carriage bolts (a) and flange lock nuts (b) from the drift cutters (Figure 16).
2. Install the drift cutters and secure with the carriage bolts (a) and flange lock nuts (b) removed in Step 1.

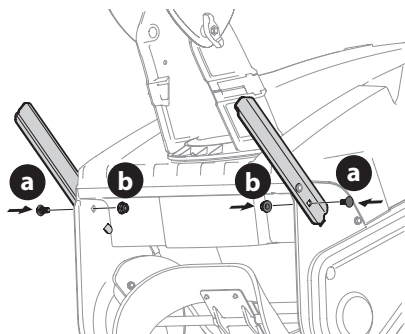

Figure 16

Adding Fuel & Oil

Refer to the Engine Operator's Manual for information on adding fuel and oil.