



AG SHIELD



**12” Cross Auger for Honey Bee Headers:
25 ft (ASM # 405801); 30ft (# 405802);
36ft (# 405803); 39ft (# 405811);
40ft (# 405810); 42ft (# 405812)**

Direct Drive

OPERATOR’S HANDBOOK AND PARTS MANUAL

Ag Shield Manufacturing
Box 9, Benito, Manitoba R0L 0C0
Phone 800-561-0132 or 204-539-2000
Fax 204-539-2130
Email address: sales@agshield.com
Web site at <http://www.agshield.com>

Table of Contents

1.	INTRODUCTION AND SIGN-OFF FORM	4
2.	SAFETY	5
2.1.	SAFETY OVERVIEW	6
2.2.	GENERAL SAFETY	6
2.3.	MAINTENANCE SAFETY	7
2.4.	HYDRAULIC SAFETY	7
2.5.	STORAGE SAFETY	7
2.6.	TRANSPORT SAFETY	7
2.7.	REFUELING SAFETY	8
2.8.	TIRE SAFETY	8
2.9.	OPERATING SAFETY	8
2.10.	CROSS AUGER SAFETY	8
2.11.	SAFETY DECALS	9
3.	SETUP FROM SHIPPING MODE	10
3.1.	RIGHT END MOUNT	10
3.2.	LEFT END MOUNTING PROCEDURE	12
3.3.	CENTER MOUNT / AUGER MOTOR INSTALLATION	14
3.4.	HYDRAULIC HOSE ATTACHMENT	15
4.	STRIPPER BAR INSTALLATION	16
5.	OPERATIONS	21
5.1.	FIELD SETTING THE CROSS AUGER	21
5.	CROSS AUGER PARTS	22
5.1.	RIGHT HAND END MOUNT HONEY BEE 25-42 FOOT KITS: 405801-03 AND 405810-12	22
5.2.	CENTER MOUNT HONEY BEE ALL MODELS	23
5.3.	LEFT END MOUNT HONEY BEE ALL MODELS	24
5.4.	AUGERS FOR HONEY BEE 25-42 FOOT KITS: 405801-03 AND 405810-12	25
6.	WARRANTY	26
6.1.	WARRANTY CLAIM FORM	27

2. SAFETY

SAFETY ALERT SYMBOL

This Safety Alert symbol means:
ATTENTION! BECOME ALERT!
YOUR SAFETY IS INVOLVED!

The Safety Alert symbol identifies important safety messages on the Ag Shield Cross auger and in the manual. When you see this symbol, be alert to the possibility of personal injury or death. Follow the instructions in the safety message.



3 Big Reasons

Accidents Disable and Kill
Accidents Cost
Accidents Can Be Avoided

SIGNAL WORDS:

Note the use of the signal words **DANGER**, **WARNING** and **CAUTION** with the safety messages. The appropriate signal word for each message has been selected using the following guide-lines:

- DANGER** - An immediate and specific hazard which **WILL** result in severe personal injury or death if the proper precautions are not taken.
- WARNING** - A specific hazard or unsafe practice which **COULD** result in severe personal injury or death if proper precautions are not taken.
- CAUTION** - Unsafe practices which **COULD** result in personal injury if proper practices are not taken, or as a reminder of good safety practices.

2.1. SAFETY OVERVIEW

YOU are responsible for the **SAFE** operation and maintenance of your Ag Shield Cross auger. **YOU** must ensure that you and anyone else who is going to operate, maintain or work around the canola pusher be familiar with the operating and maintenance procedures and related **SAFETY** information contained in this manual. This manual will take you step-by-step through your working day and alerts you to all good safety practices that should be adhered to while operating the canola pusher.

Remember, **YOU** are the key to safety. Good safety practices not only protect you but also the people around you. Make these practices a working part of your safety program. Be certain that **EVERYONE** operating this equipment is familiar with the recommended operating and maintenance procedures and follows all the safety precautions. Most accidents can be prevented. Do not risk injury or death by ignoring good safety practices.

- Cross auger owners must give operating instructions to operators or employees before allowing them to operate the Cross auger, and at least annually thereafter per OSHA regulation 1928.57.
- The most important safety device on this equipment is a **SAFE** operator. It is the operator's responsibility to read and understand **ALL** Safety and Operating instructions in the manual and to follow these. All accidents can be avoided.
- A person who has not read and understood all operating and safety instructions is not qualified to operate the machine. An untrained operator exposes himself and bystanders to possible serious injury or death.
- Do not modify the equipment in any way. Unauthorized modification may impair the function and/or safety and could affect the life of the equipment.
- Think SAFETY! Work SAFELY!

2.2. GENERAL SAFETY

1. Read and understand the Operator's Manual and all safety signs before operating, maintaining, adjusting the Cross auger.
2. Only trained competent persons shall operate the cross auger. An untrained operator is not qualified to operate the machine.



3. Have a first-aid kit available for use should the need arise and know how to use it.



4. Have a fire extinguisher available for use should the need arise and know how to use it.



5. Do not allow riders.

6. Wear appropriate protective gear. This list includes but is not limited to:

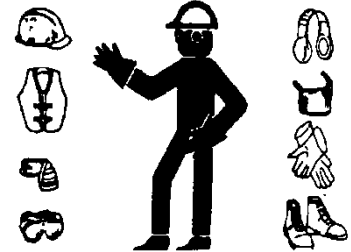

- A hard hat
 - Protective shoes with slip resistant soles
 - Protective glasses or goggles
 - Heavy gloves
 - Hearing protection
7. Stop the engine, place all controls in neutral, set park brake, remove ignition key and wait for all moving parts to stop before servicing, adjusting, repairing or unplugging.
 8. Review safety related items with all personnel.

2.3. MAINTENANCE SAFETY

1. Review the Operators Manual and all safety items before working with, maintaining or operating the Cross auger.
2. Stop the tractor engine, place all controls in neutral, set park brake, remove ignition key, wait for all moving pads to stop before servicing, adjusting, or repairing.
3. Before applying pressure to a hydraulic system, make sure all components are tight and that steel lines, hoses and couplings are not damaged.
4. Relieve pressure from hydraulic circuit before servicing or disconnecting from tractor.
5. Keep hands, feet, clothing and hair away from all moving and/or rotating parts.
6. Clear the area of bystanders, especially children, when carrying out any maintenance and repairs or making any adjustments.
7. Place stands or blocks under the frame before working beneath the machine.

2.4. HYDRAULIC SAFETY

1. Always place all tractor hydraulic controls in neutral before dismounting.
2. Make sure that all components in the hydraulic system are kept in good condition and are clean.
3. Replace any worn, cut, abraded, flattened or crimped hoses and steel lines.
4. Do not attempt any makeshift repairs to the hydraulic lines, fittings or hoses by using tape, clamps or cements. The hydraulic system operates under extremely high-pressure. Such repairs will fail suddenly and create a hazardous and unsafe condition.
5. Wear proper hand and eye protection when searching for a high-pressure hydraulic leak. Use a piece of wood or cardboard as a backstop instead of hands to isolate and identify a leak.
6. If injured by a concentrated high-pressure stream of hydraulic fluid, seek medical attention immediately. Serious infection or toxic reaction can develop from hydraulic fluid piercing the skin surface.

7. Before applying pressure to hydraulic system make sure that all connections are tight and that all hoses and fittings are in good condition.
 1. slip and you could be badly hurt or killed.

2.5. STORAGE SAFETY

1. Store unit in an area away from human activity.
2. Do not permit children to play on or around the stored Cross auger.

2.6. TRANSPORT SAFETY

1. Read and understand ALL the information in the Operator's Manual regarding procedures and SAFETY when operating the Cross auger in the field and/or on the road.
2. Check with local authorities regarding machinery transport on public roads. Obey all applicable laws and regulations.
3. Always travel at a safe speed. Use caution when making corners or meeting traffic.

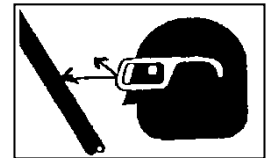

4. Make sure the SMV (Slow Moving Vehicle) emblem and all the lights and reflectors that are required by the local highway and transport authorities are in place, are clean and can be seen clearly by all overtaking and oncoming traffic. Daybreak and dusk are particularly dangerous and pilot vehicles are recommended.
5. Ensure that the trailer is hitched positively to the towing vehicle. Always use a safety chain between the trailer and the tractor.
6. Keep to the right and yield the right-of-way to allow faster traffic to pass. Drive on the road shoulder, if permitted by law.
7. Always use hazard warning flashers on the Cross auger when transporting unless prohibited by law.

2.7. REFUELING SAFETY

1. Handle fuel with care. It is highly flammable.



2. Do not refuel the machine while smoking or when near open flame or sparks.

3. Stop engine before refueling. Clean up spilled fuel before restarting engine.

2.8. TIRE SAFETY

1. Failure to follow proper procedures when mounting a tire on a wheel or rim can produce an explosion, which may result in serious injury or death.
2. Do not attempt to mount a tire unless you have the proper equipment and experience to do the job.
3. Have a qualified tire dealer or repair service perform required tire maintenance.
4. Operate the tires at the pressures, loads, and speeds suggested by the manufacturer.

2.9. OPERATING SAFETY

1. Read and understand the Operator's Manual and all safety signs before using.
2. Stop engine place all controls in neutral, set park brake, remove ignition key, wait for all moving parts to stop before servicing, adjusting, repairing or unplugging.
3. Before conditioning a field, be familiar with all potential hazards: trees, rocks ditches, gullies, etc. Plan your route to avoid hazards. Keep Cross auger width in mind when maneuvering to avoid obstacles.
4. Keep hands, feet, hair and clothing away from all moving and/or rotating parts.
5. Keep all shields and guards in place when operating.
6. Do not allow riders on the Cross auger or tractor during operation or transporting.
7. Clear the area of all bystanders, especially children, before starting.

8. Stay away from machine when folding deflectors. Keep others away.
9. Before applying pressure to the hydraulic system, make sure all components are tight and that steel lines, hoses and couplings are not damaged.
10. Review safety instructions annually

2.10. CROSS AUGER SAFETY

The cross auger has sufficient power to sever limbs and cause serious to fatal injury. Always stop the cross auger before dismounting. Always be certain that no one is in front of combine header Shield before engaging the auger drive.

When greasing the auger, do so with the combine motor shut off and the park brake securely set.

Never attempt to help the crop move along the canvases with a wrench or other item that might get into the auger and draw the wrench holder into the auger.

2.11. SAFETY DECALS

Become familiar with these decals and the hazards they are marking.



part #113522

part #113524



part # 113552

3. Setup from Shipping Mode

Operator's handbook for Ag Shield Cross auger to fit on to a Honey Bee or New Holland headers made by honey Bee

Please note that the colors in the instructions refer to the **manual** page colors, **not the actual color** the kit parts are painted

Figure 1 2004 Honey Bee right hand side Original bolts and clamps.....	10
Figure 2 Right End Mount ready to mark holes to Drill	11
Figure 3 Remove bolts C and D on Left end.....	12
Figure 4 Left Hand mount ready to mark holes.....	13
Figure 5 Right hand Honey Bee canvas motor ports.....	15
Figure 6 Auger Installation on Honey Bee 25-42 FT Kits: 405801-3 and 405810-12.....	17
Figure 7 Right End Hydraulic Moter and Flow Control with Mount	18
Figure 8 Center Mount offset 4" on Edge from Header Center Block.....	19
Figure 9 Left End Mount.....	20
Figure 10 Sauer Motor speed control	21

Installation sequence and dimensions for a Honey Bee header-

3.1. RIGHT END MOUNT

1. Remove the U bolts "B" and small bolts "A" holding the end tin sheet to the 3x3 main forward tubing of the Honey Bee.

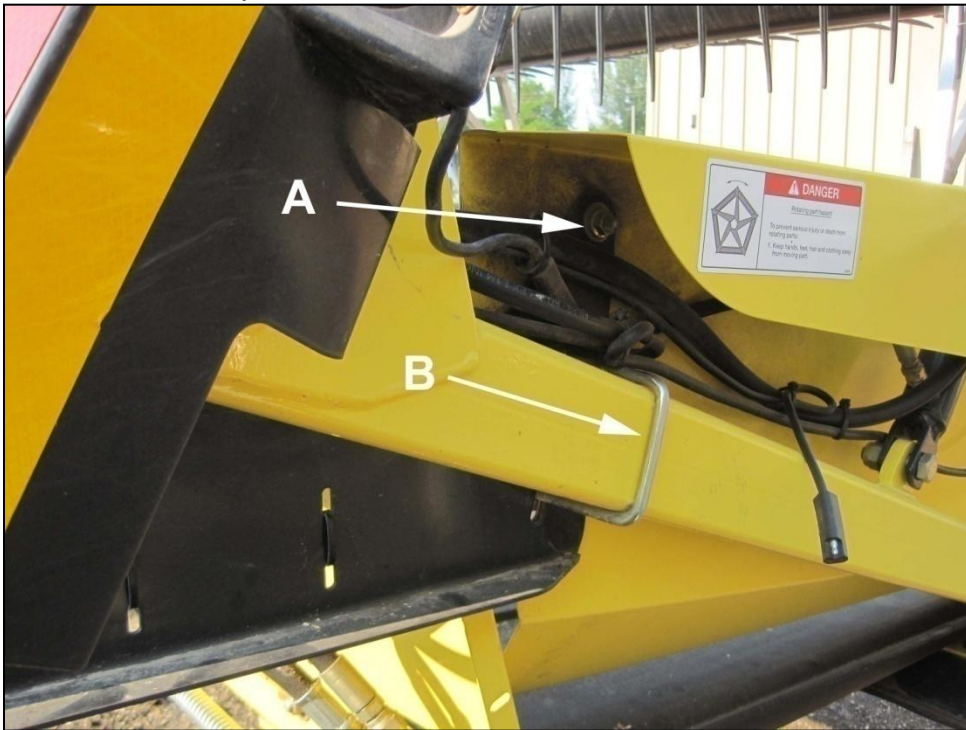

FIGURE 1 2004 HONEY BEE RIGHT HAND SIDE ORIGINAL BOLTS AND CLAMPS



FIGURE 2 RIGHT END MOUNT READY TO MARK HOLES TO DRILL

2. Insert the longer and thicker (3/8"OD) Ag Shield U bolt number 101037 through the U bolt hole---
3. Hang the Ag Shield mount on the U bolt on the inside end .
4. Put nuts and washers on loose over the slots .
5. Position end mount against the inside end of the header as per **Error! Reference source not found.** and **Error! Reference source not found.**. When the upper edge of the Ag Shield mount is 6.8" from the corner of the 6x6 mainframe, the Ag Shield auger should be able to be positioned to just clear the header backboard used as a stripper.
6. Mark holes for second U Bolt, and drill with a 11/32 " drill.
7. Install the second Ag Shield U bolt .
8. Replace bolt "A" by drilling the upper hole through the Ag Shield mount to hold the Honey Bee end sheet. Use Ag Shield or Honey Bee bolt to fasten end sheet to new hole in the Ag Shield mount.

3.2. LEFT END MOUNTING PROCEDURE

The left mount is installed in a similar fashion as the right ---observe the photos below

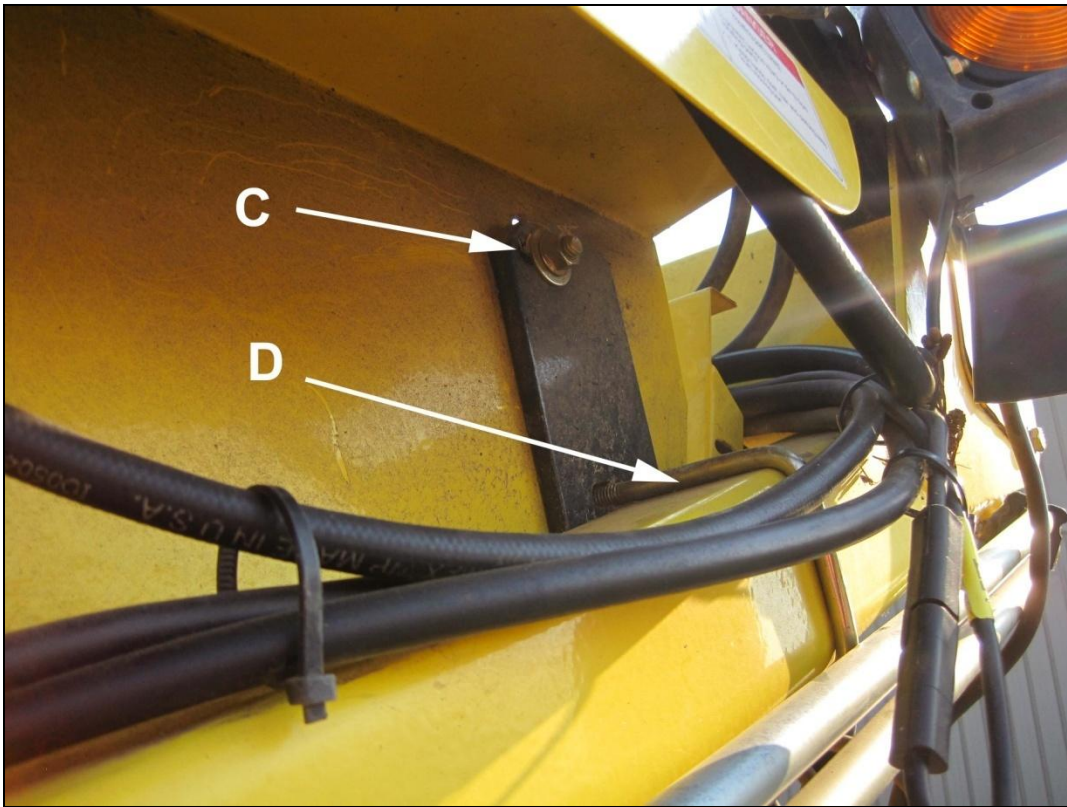

FIGURE 3 REMOVE BOLTS C AND D ON LEFT END



FIGURE 4 LEFT HAND MOUNT READY TO MARK HOLES

3.3. CENTER MOUNT / AUGER MOTOR INSTALLATION



9. The center mount attaches to the main frame via a single U bolt. Start with the U bolt positioned 4.25" to the left of the left round pipe on top of header or a few inches to the left of center.
10. Installed the right auger first – adjust the center mount to the correct position. .Leave the bearing bolts loose to see where in the slots the auger will fit
11. Place the red stop bolt on the forward auger mount bolt nearest the hydraulic motor – See figure 7
12. Install the left auger, leave the bolts loose.
- 13. Slide the bearings in the mount slots until the auger flighting is ¼" from the back board. The back board of the header is the stripper to prevent wrapping of the crop material.**
14. Final tighten all bolts
15. Rotate the auger to check for clearance to the backboard.
16. Install the motor and motor mount,
17. Install the chain couplings
18. Install the plastic shield as shown on the RH (or left hand) in front of auger.

3.4. HYDRAULIC HOSE ATTACHMENT.

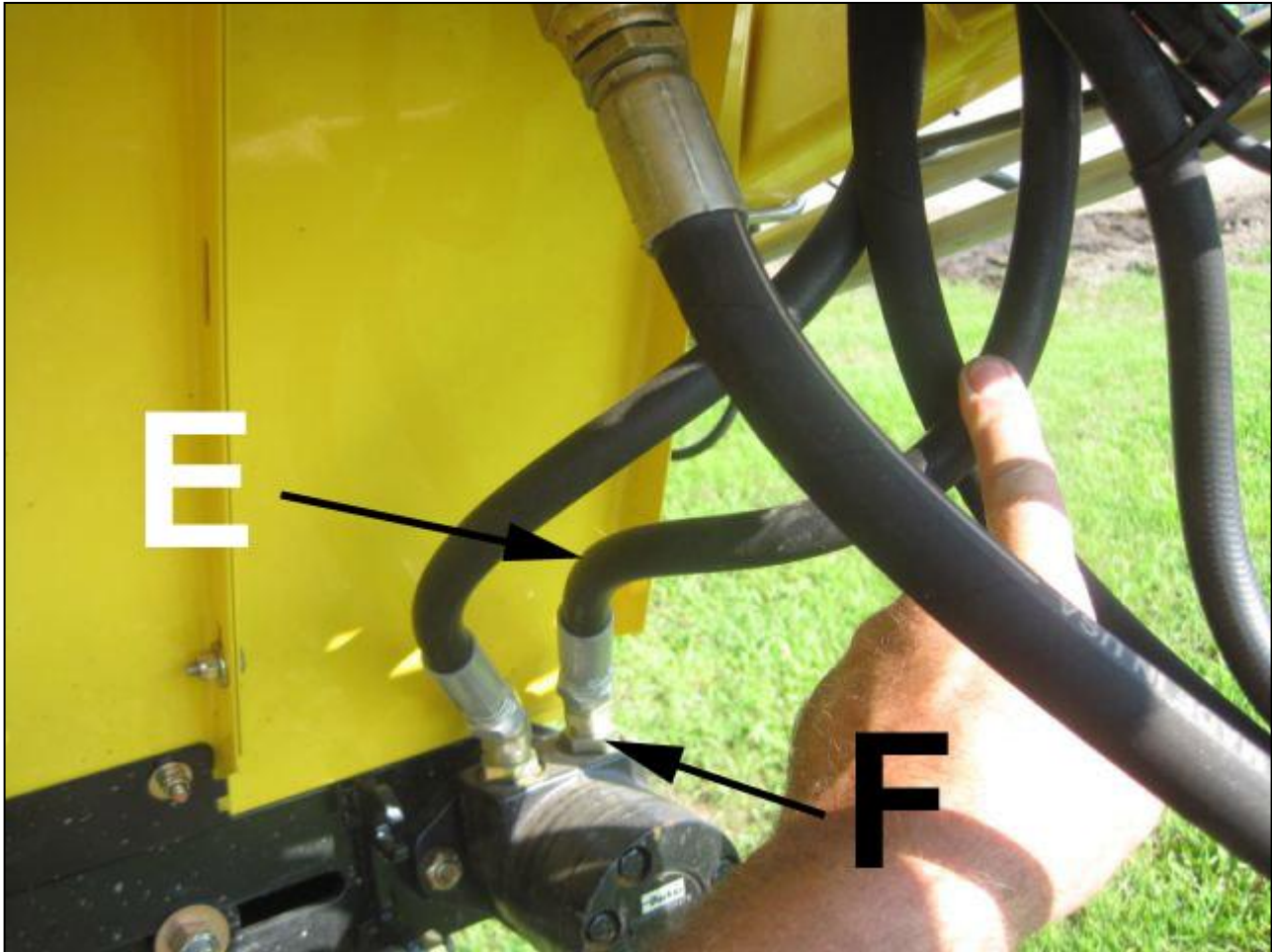
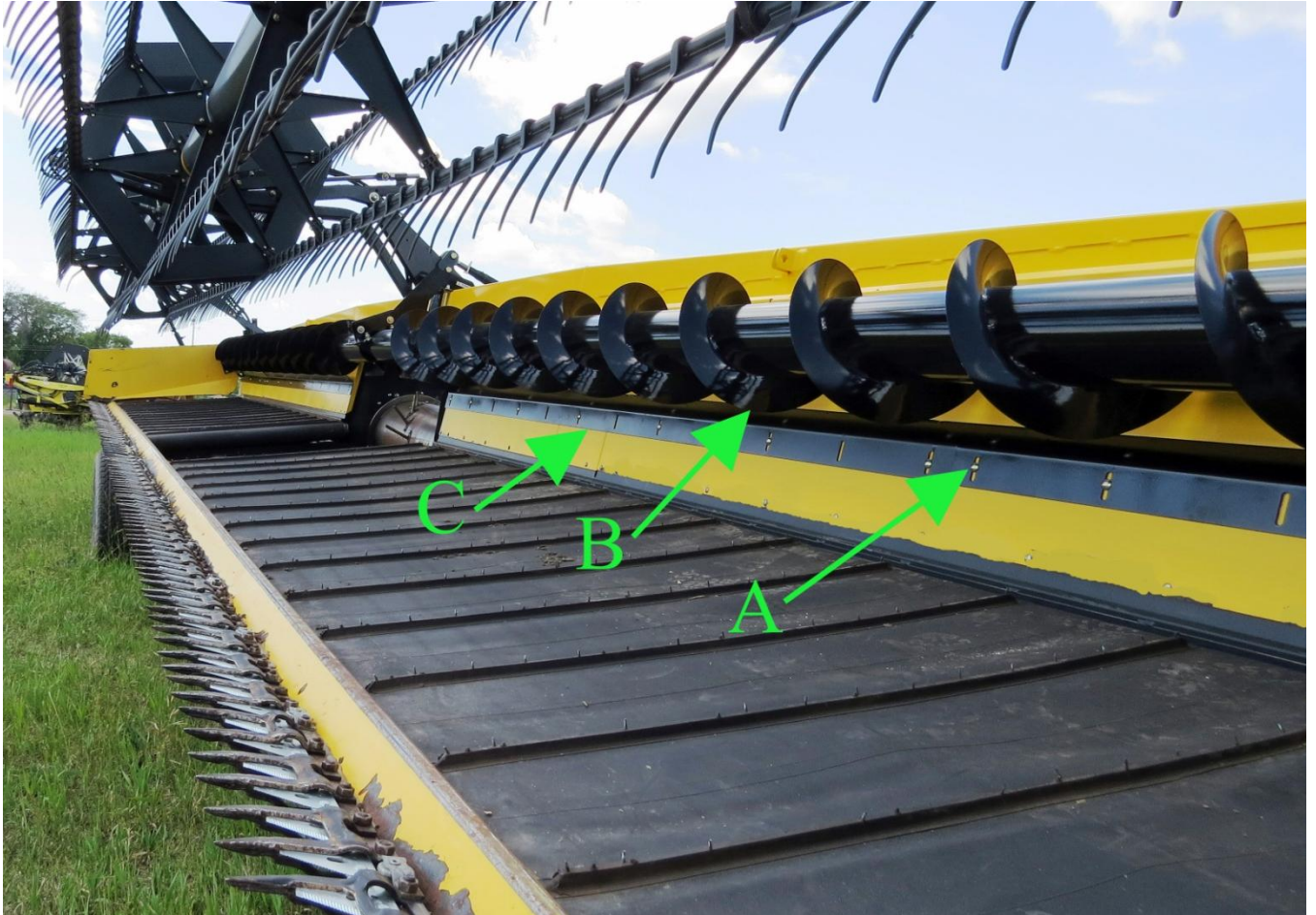

FIGURE 5 RIGHT HAND HONEY BEE CANVAS MOTOR PORTS

18. Install hydraulic hoses as follows: Remove hose “E” from the port “F”.
19. Attach new Ag Shield hose to port ‘F’ and then to the rear port of the Ag Shield motor Port B,
20. Attach the hose “E” to the forward port of the Ag Shield motor Port A– or to a hose coming from the forward port of the Ag Shield auger motor. The oil path is from port F to the Ag Shield hydraulic motor, and back to Honey Bee oil reservoir via hose “E”.
21. Test direction of rotation to be down on the front of the auger, and set speed of the reel, and use the flow control supplied to set the auger flighting speed to be 5% or slightly greater than the canvases. For speed setting see section 5 operations.

4. Stripper Bar Installation

- 1) All Ag Shield augers now come with a stripper bar to help prevent crop from wrapping on the auger, as well as to provide a cleaner transfer of crop to the center of the header.
- 2) Put the stripper bar on last after the auger has been installed and tested. This will ensure the height of the auger does not change after the stripper bar height has been set.



Hold stripper bar up to the back board and mark the holes in the middle of the slot (every second hole will be fine)

A magnet will help hold one end if installing alone.

Make sure before drilling that the drill will not damage anything behind the back board (hyd fittings hoses etc)

Drill 3/8" holes in the middle of the slot in the back board.

Set the stripper bar to be 1/4" below the flighting.

Tighten the stripper bar to the back board.

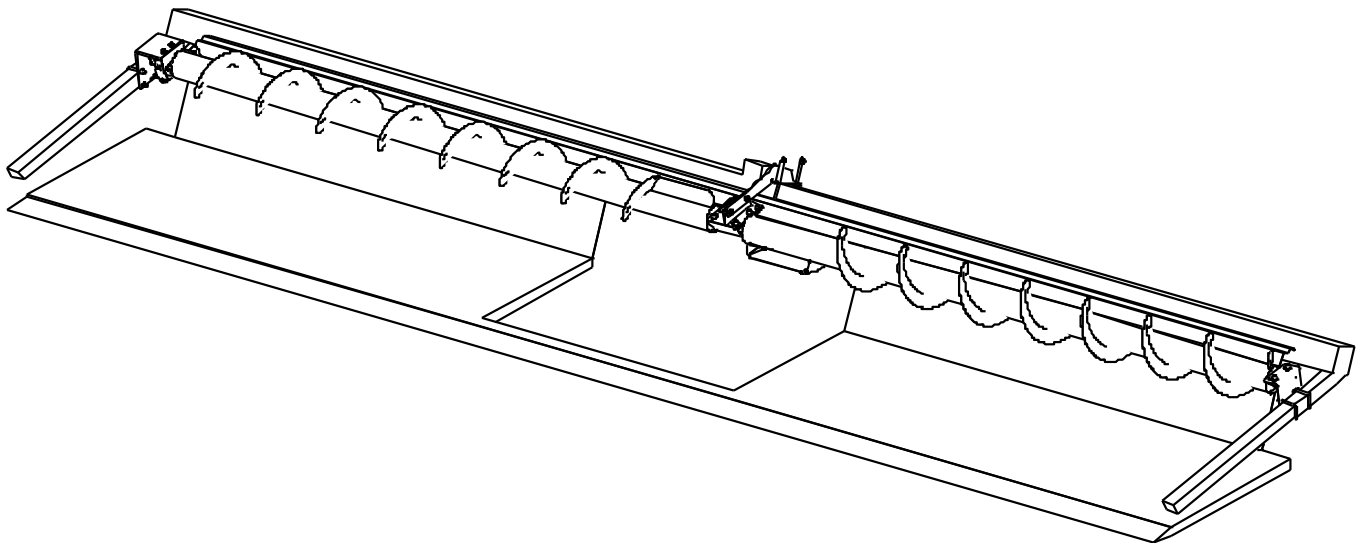
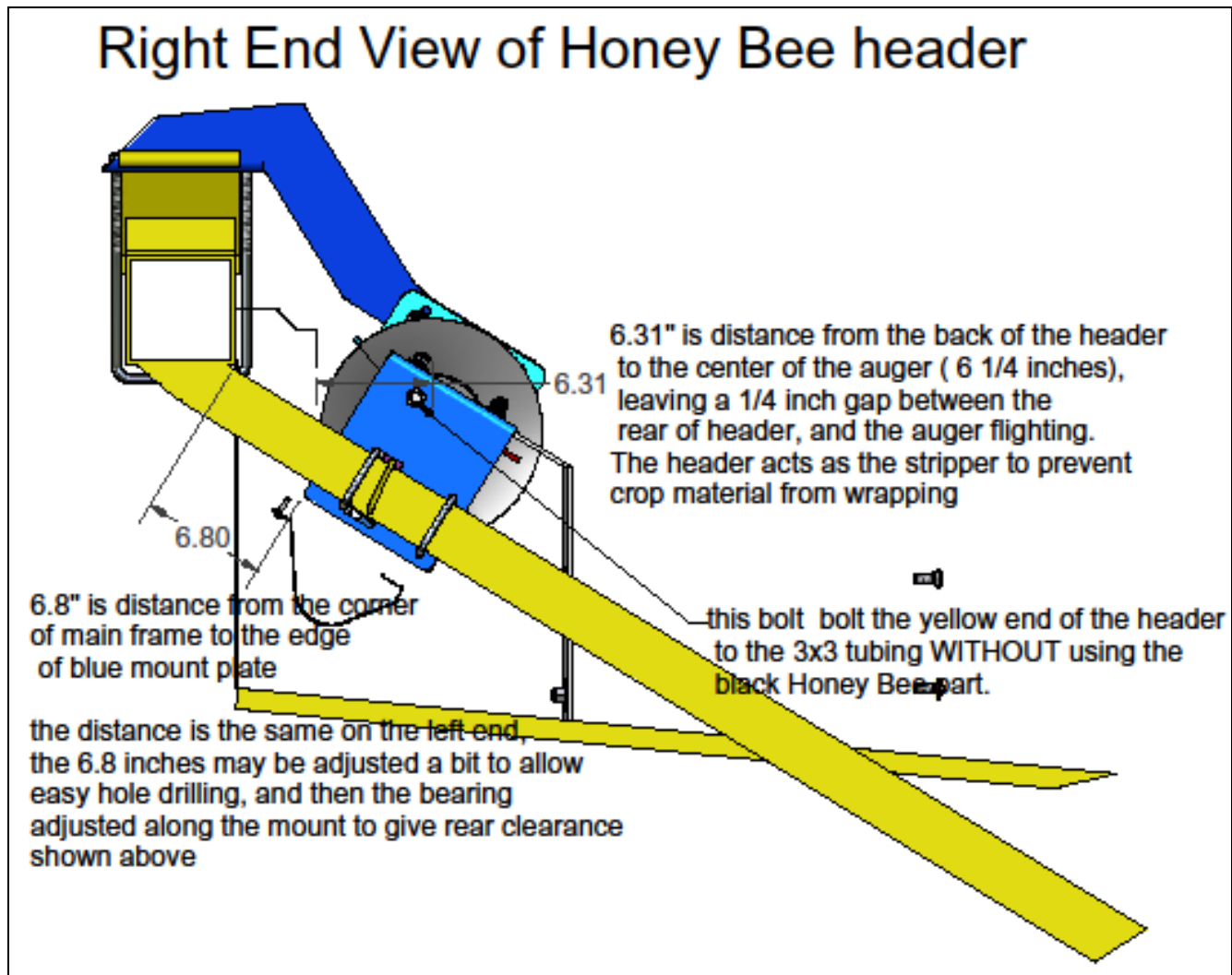
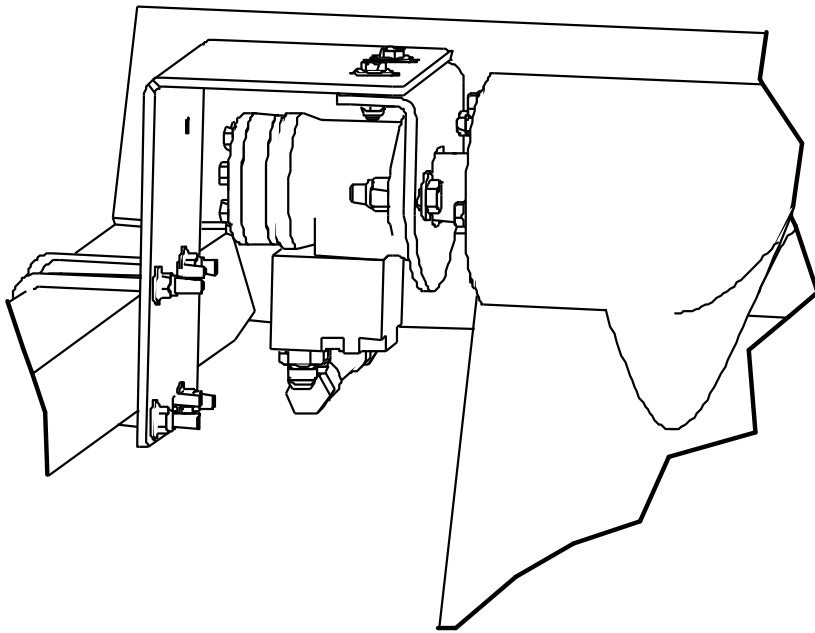

FIGURE 6 AUGER INSTALLATION ON HONEY BEE 25-42 FT KITS: 405801-3 AND 405810-12





RH End Hydraulic Motor with Flow Control and Mount (Front View)

RH End Hydraulic Assembly and Mount with **Stop Bolt** (Top View)

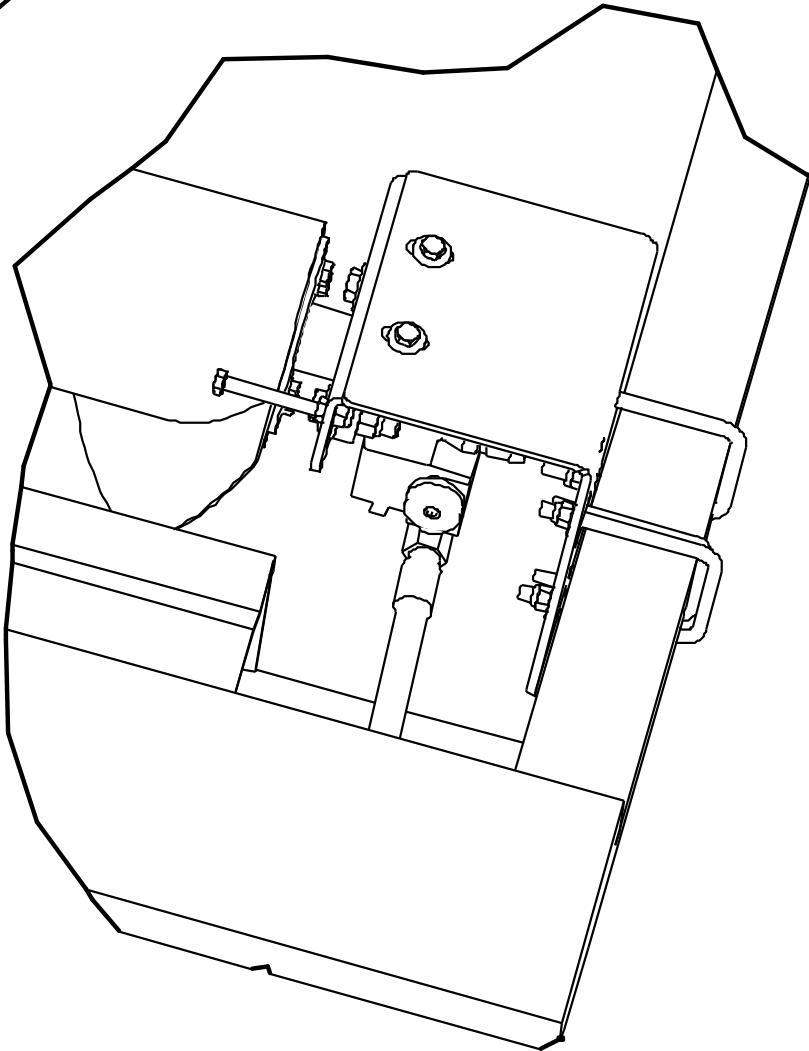

Note the **stop bolt** is used to completely stop the auger from turning IF you have a reason. The normal position is to have the **stop bolt** stored on the motor side of the blue mounting bracket.

To use the **stop bolt** - install the bolt into the path of the rotating auger as show, then completely open the bypass adjusting valve so that excessive back pressure is not built up in the canvas circuit.

FIGURE 7 RIGHT END HYDRAULIC MOTER AND FLOW CONTROL WITH MOUNT

Center Mount with Cover Guard Attached (SIDE VIEW)

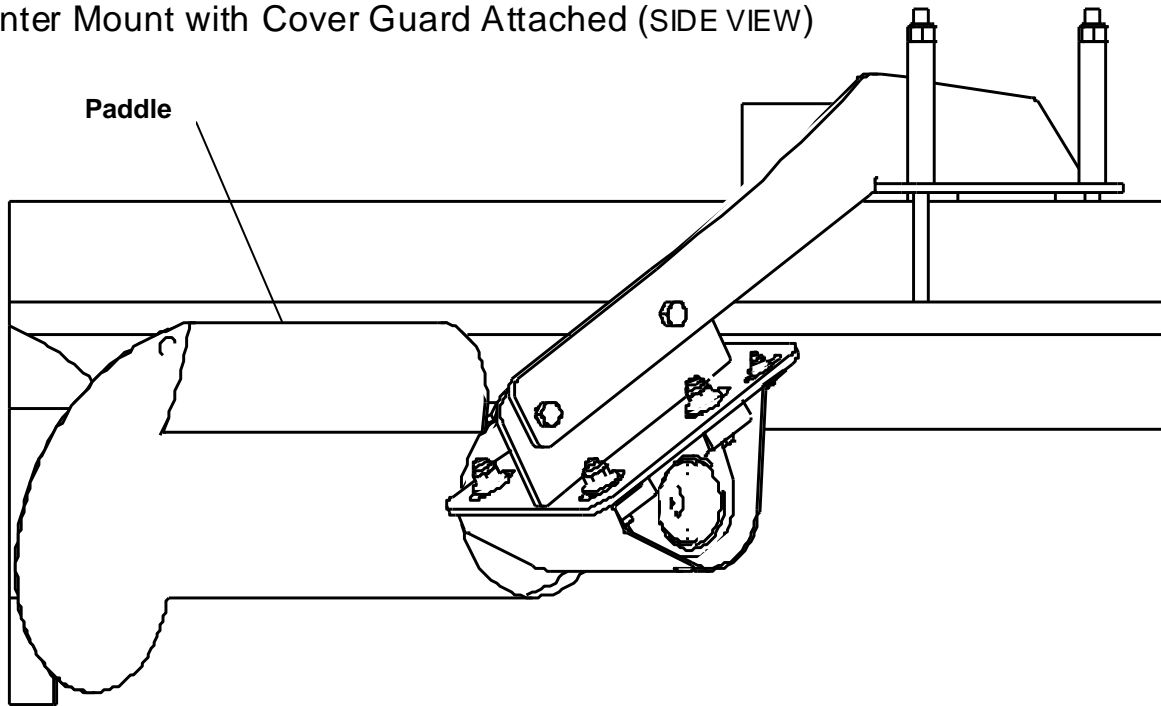

Center Mount Bolted onto Rear Header Frame (TOP VIEW)

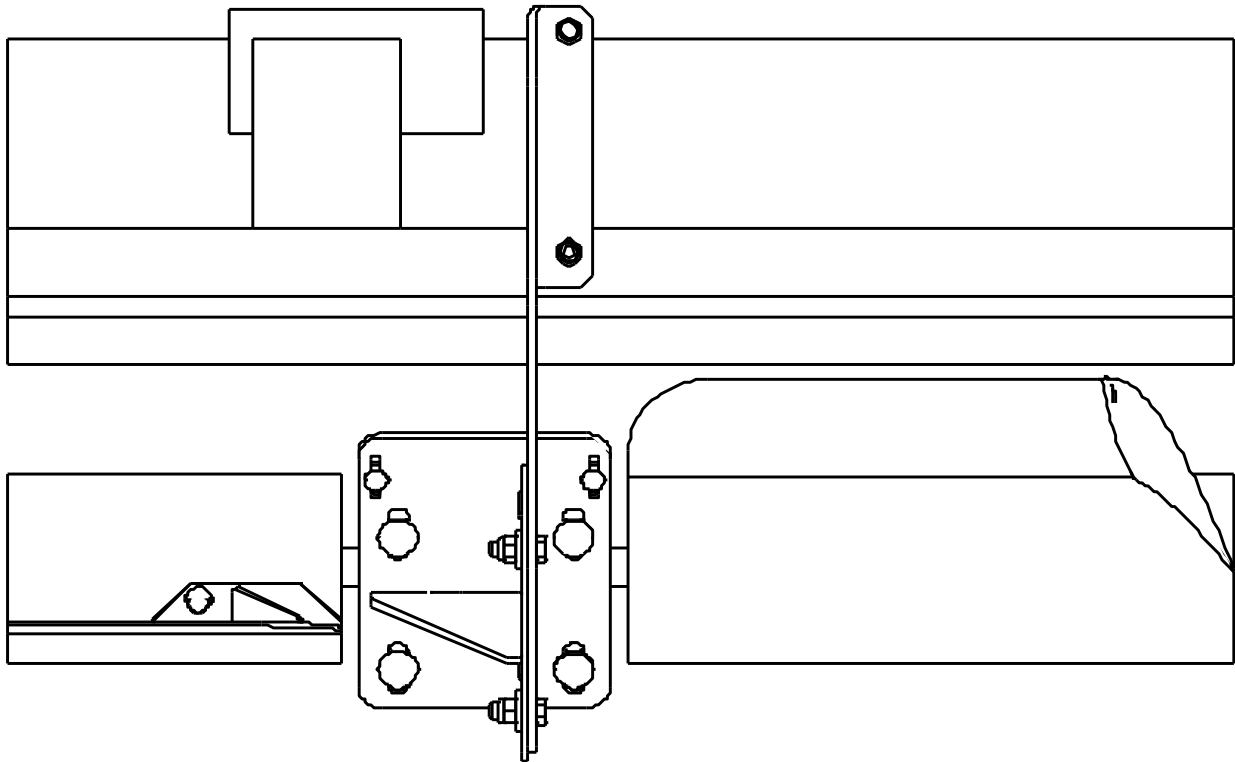
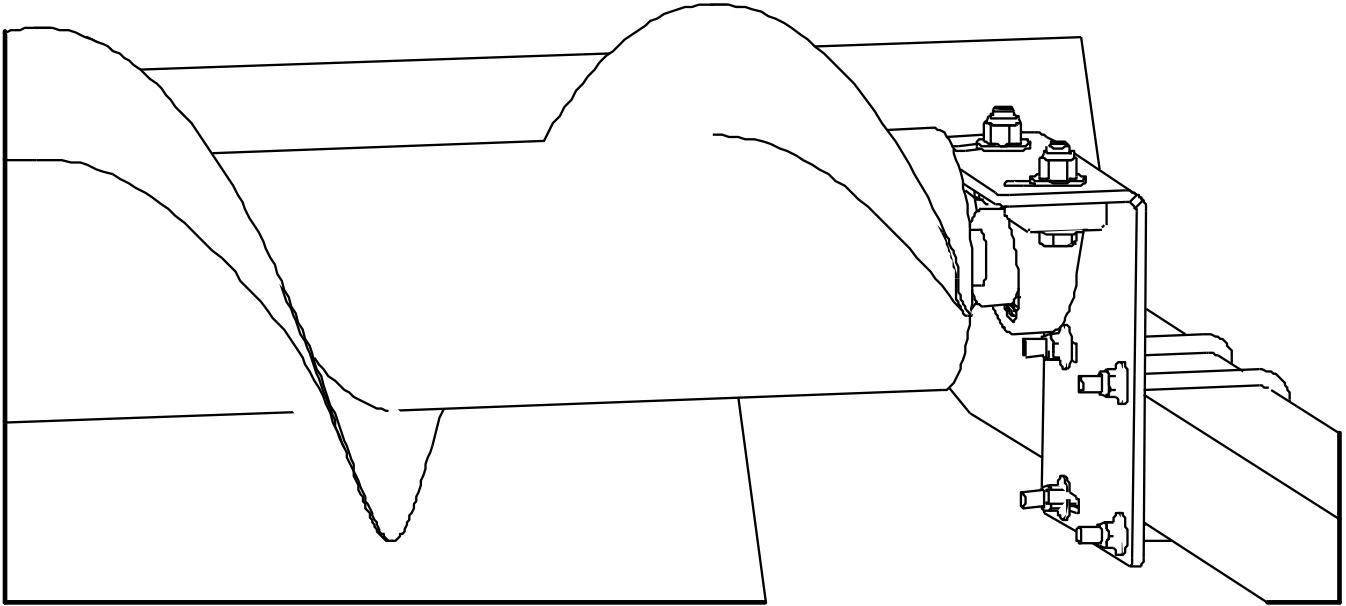

FIGURE 8 CENTER MOUNT OFFSET 4" ON EDGE FROM HEADER CENTER BLOCK

Left End Mount (FRONT VIEW)



Left End Mount (TOP VIEW)

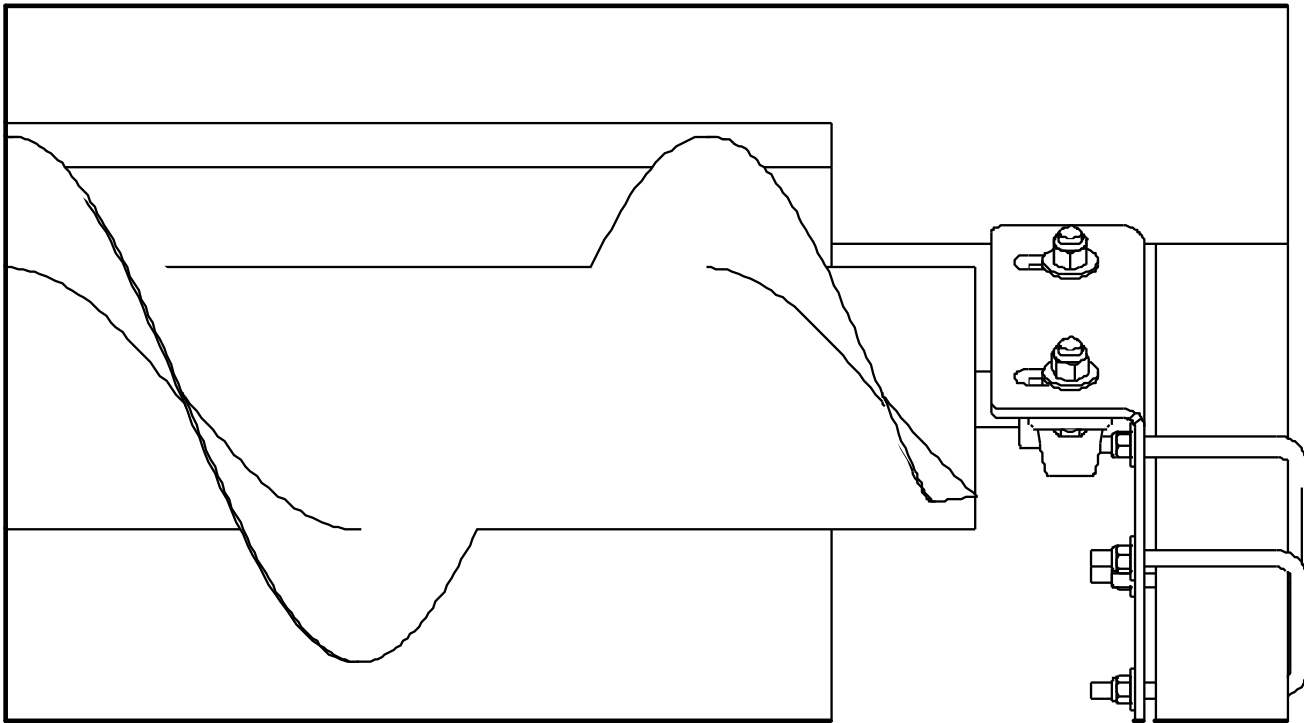

FIGURE 9 LEFT END MOUNT

The **paddles** may assist in preventing the crop from wrapping at the center of the auger. If wrapping at the center is a problem, first slow down the auger to reduce wrapping. If wrapping persists, consider removing the paddles.

5. OPERATIONS



DANGER

Stay clear of auger
whenever it is running

5.1. FIELD SETTING THE CROSS AUGER

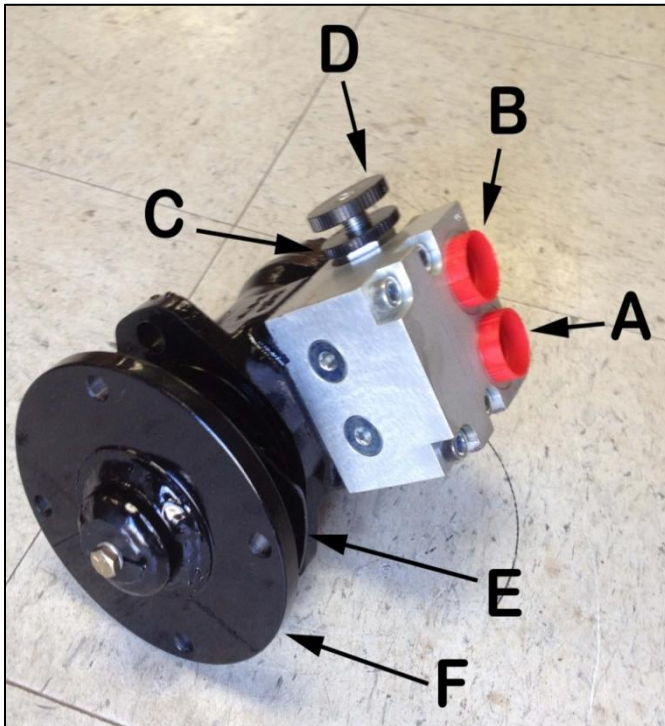

FIGURE 10 SAUER MOTOR SPEED CONTROL

Terminology

- A: Return or tank line
- B: Pressure line
- C: Lock wheel
- D: Auger speed adjustment
- E: Shim for hydraulic motor mount
- F: Direct driver motor adapter

Cross augers can only be adjusted for speed of rotation. In many conditions, the correct speed for many crops would be to have the flighting advancing the crop along the canvas 5% or slightly faster than the canvas speed. To increase auger speed, loosen lock wheel A counterclockwise, rotate adjust valve C clockwise, relock the valve by turning A clockwise. Closing this valve reduces the bypass of oil around the hydraulic motor. To slow down the rpm of the auger, rotate adjust valve C counterclockwise.

Observe the auger from the combine cab or swather operating platform. Focus your eye on one auger flighting and compare to a particular canvas slat. The auger can be adjusted to run at the same rate in feet per minute. As desired, slightly increase the cross auger to have it pulling ahead faster than the canvas.

In peas, augers can often be operated at a very slow speed--- 30% of canvas speed, and still feed as much crop into combine. When augers turn slower, there are fewer tendencies to wrap.

If wrapping occurs at the center of the header, try removing one or both of the bolts on paddles – In some conditions the paddles are an advantage, in some conditions the paddles are a disadvantage.

5. Cross Auger Parts

5.1. RIGHT HAND END MOUNT HONEY BEE 25-42 FOOT KITS: 405801-03 AND 405810-12

RH End Mount and Motor

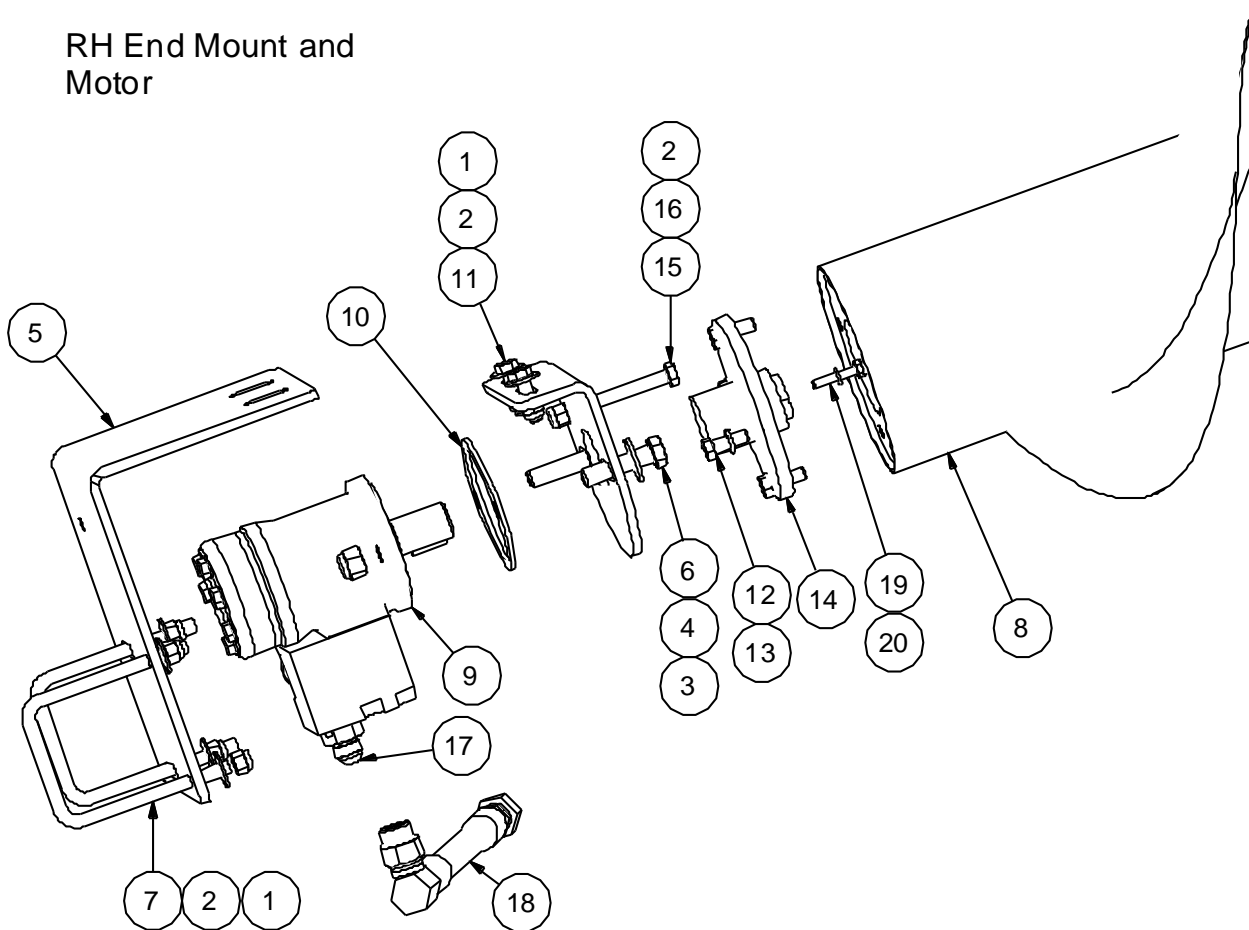

ITEM	QTY	PART NUMBER	ITEM	QTY	PART NUMBER
1	12	101105 flat washer 3/8"	11	2	100603 bolt 3-8 X 1 1-4 gr5 pltd nc
2	11	102123 nut nylok 3/8" nc gr5 pltd	12	4	100602 bolt 3-8 X 1 gr5 pltd nc
3	16	101106 flat washer 1/2"	13	4	101145 lock washer 3/8"
4	12	102125 nut nylok 1/2" nc gr5 pltd	14	1	407105 direct drive motor adapter wldt
5	1	408159 mt RH Honey Bee motor dirdrv	15	1	100610 bolt 3-8 X 3 gr5 pltd nc
6	8	100703 bolt 1-2 X 2 gr5 pltd nc	16	1	102131 nut jam 3-8 nc gr5 1-2 HGT
7	4	101037 U bolts 3-8 NC 3.13 inside 4.56 legs	17	1	117984 ADAPTER STR 10MORB X 08 MJIC
8	1	408247 HB SP25 Auger Wldmt RH dirdrv	18	1	118874 hyd hose 28in 08 x 10MORB90 x 08FJIC
9	1	117170 motor with flow control 5.9 danfoss	19	1	100404 bolt 1-4 X 1 1-4 nc
10	1	407271 shim hyd motor mt AGCO 9250	20	1	101144 lock washer 1/4

5.2. CENTER MOUNT HONEY BEE ALL MODELS

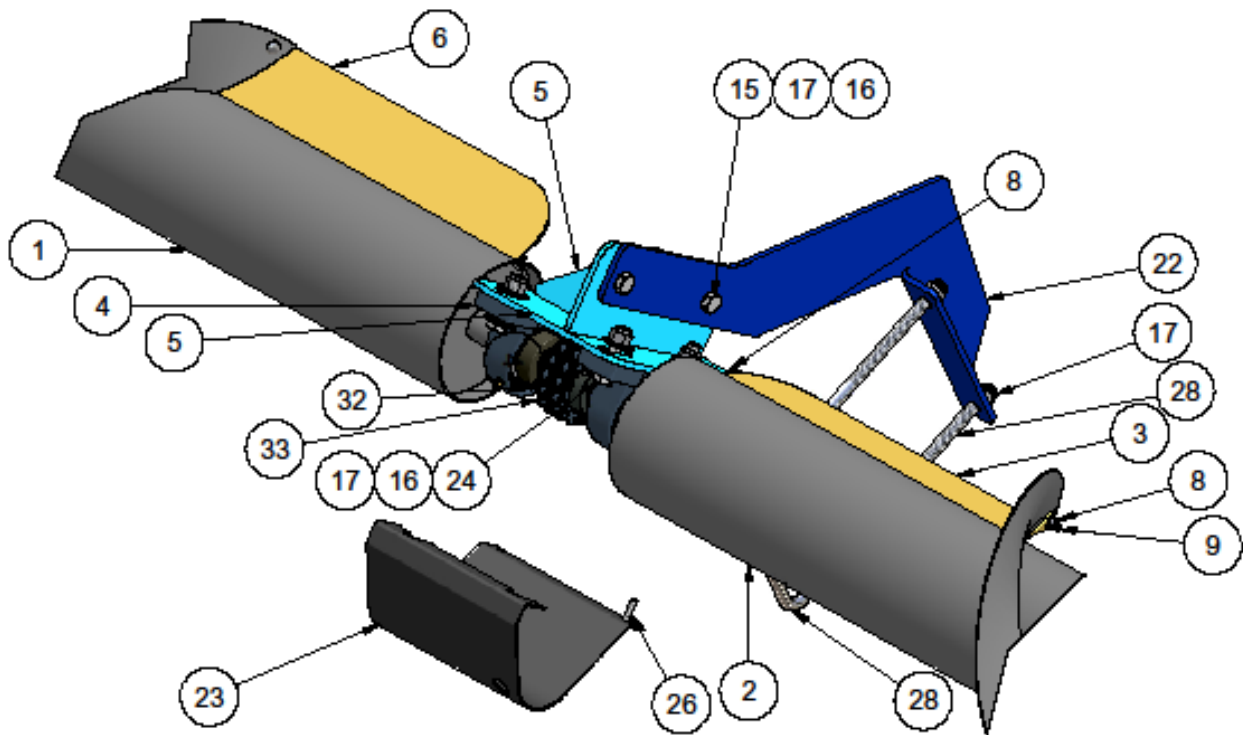

Parts List			Parts List		
ITEM	QTY	PART NUMBER	ITEM	QTY	PART NUMBER
1	1	406297 auger wldt RH HB WS36 drive 12inOD	20	1	406136 Drive End Bearing Spacer
2	1	406294 auger wldt LH HB WS36 12inOD	21	1	406376 mt LH HB WS36
3	1	405726 flap bolt on wldt 3in LH	22	1	406378 plate vert HB center mt 6 tb
4	4	114471 Pillow Block Bearing Assy P207-SA207	23	1	405087 plastic guard
5	1	406379 center mt HB 6 tb	24	7	100703 bolt 1/2" X 2" gr5 pltd nc
6	1	405725 flap bolt on wldt 3in RH	25	4	101103 flat washer 1/4"
7	1	HB model SP36 HEADER 2004 ser 360400732 081610tm	26	2	100403 bolt 1/4 X 1 gr5 pltd nc
8	4	102121 nut nylok 1/4" nc gr5 pltd	27	4	101037 U bolts 3 8nNC 3.13 inside 4.56 legs
9	2	100966 Carriage Bolt 1-4 X 3-4 NC	28	1	101038 U bolt 12NC x 6-18 x 11 14
10	1	117170 Orbit Motor Danfoss 5_9	29	1	406370 HB SP30-36 Motor Shield Plastic
11	1	406121 Motor Mount 2-Hole	30	2	100948 carriage bolt 1-2 X 1 1-4 NC
12	4	100604 bolt 3-8 X 1 1-2 gr5 pltd nc	31	3	405361 key 1/4" x 1/4" x 1"
13	12	101105 flat washer 3/8"	32	3	114468 chain coupler 1-1/4" ID
14	12	102123 nut nylok 3/8" nc gr5 pltd	33	2	114469
15	4	100702 bolt 1-2 X 1 1-2 gr5 pltd nc	34	1	100660 bolt 7-16 X 1 gr5 pltd nc
16	21	101106 flat washer 1/2"	35	1	101142 lock washer 7-16
17	16	102125 nut nylok 1/2" nc gr5 pltd	36	1	114467 CHAIN COUPLING HSOB14 1 ECC
18	1	406375 mt RH HB WS36 drive	37	1	100704 bolt 1/2" x 2 1/2" gr5 pltd nc
19	1	406364 HB Motor Shield Mount Bar	38	1	405794 tab stop auger rotation

5.3. LEFT END MOUNT HONEY BEE ALL MODELS

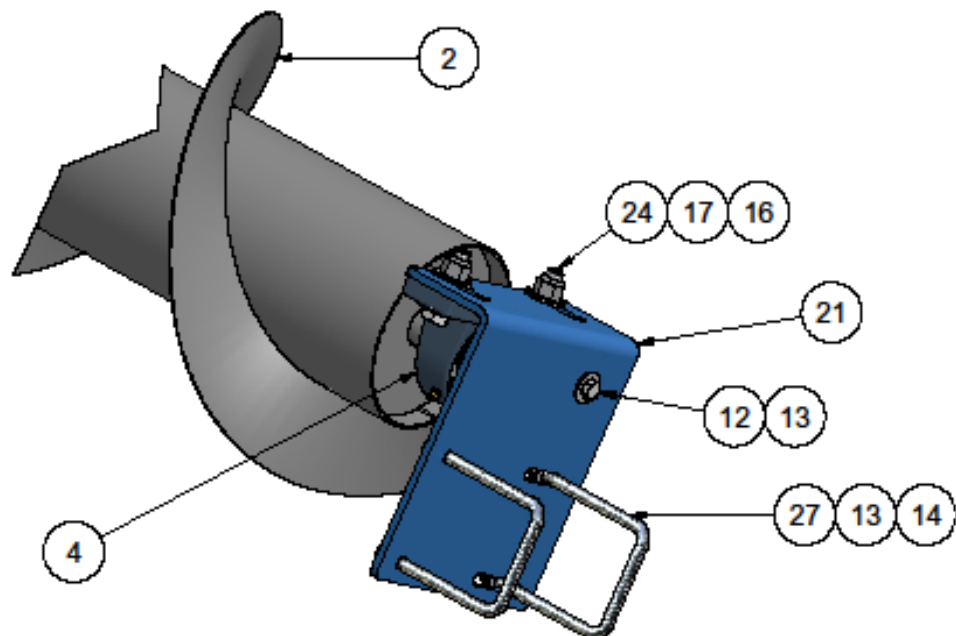

Parts List			Parts List		
ITEM	QTY	PART NUMBER	ITEM	QTY	PART NUMBER
1	1	406297 auger wldt RH HB WS36 drive 12inOD	20	1	406136 Drive End Bearing Spacer
2	1	406294 auger wldt LH HB WS36 12inOD	21	1	406376 mt LH HB WS36
3	1	405726 flap bolt on wldt 3in LH	22	1	406378 plate vert HB center mt 6 tb
4	4	114471 Pillow Block Bearing Assy P207-SA207	23	1	405087 plastic guard
5	1	406379 center mt HB 6 tb	24	7	100703 bolt 1/2" X 2" gr5 pltd nc
6	1	405725 flap bolt on wldt 3in RH	25	4	101103 flat washer 1/4"
7	1	HB model SP36 HEADER 2004 ser 360400732 081610tm	26	2	100403 bolt 1/4 X 1 gr5 pltd nc
8	4	102121 nut nylok 1/4" nc gr5 pltd	27	4	101037 U bolts 3 8nNC 3.13 inside 4.56 legs
9	2	100966 Carriage Bolt 1-4 X 3-4 NC	28	1	101038 U bolt 12NC x 6-18 x 11 14
10	1	117170 Orbit Motor Danfoss 5_9	29	1	406370 HB SP30-36 Motor Shield Plastic
11	1	406121 Motor Mount 2-Hole	30	2	100948 carriage bolt 1-2 X 1 1-4 NC
12	4	100604 bolt 3-8 X 1 1-2 gr5 pltd nc	31	3	405361 key 1/4" x 1/4" x 1"
13	12	101105 flat washer 3/8"	32	3	114468 chain coupler 1-1/4" ID
14	12	102123 nut nylok 3/8" nc gr5 pltd	33	2	114469
15	4	100702 bolt 1-2 X 1 1-2 gr5 pltd nc	34	1	100660 bolt 7-16 X 1 gr5 pltd nc
16	21	101106 flat washer 1/2"	35	1	101142 lock washer 7-16
17	16	102125 nut nylok 1/2" nc gr5 pltd	36	1	114467 CHAIN COUPLING HSOB14 1 ECC
18	1	406375 mt RH HB WS36 drive	37	1	100704 bolt 1/2" x 2 1/2" gr5 pltd nc
19	1	406364 HB Motor Shield Mount Bar	38	1	405794 tab stop auger rotation

5.4. **AUGERS FOR HONEY BEE 25-42 FOOT KITS: 405801-03 AND 405810-12**

RH AND LH AUGER PART NUMBERS

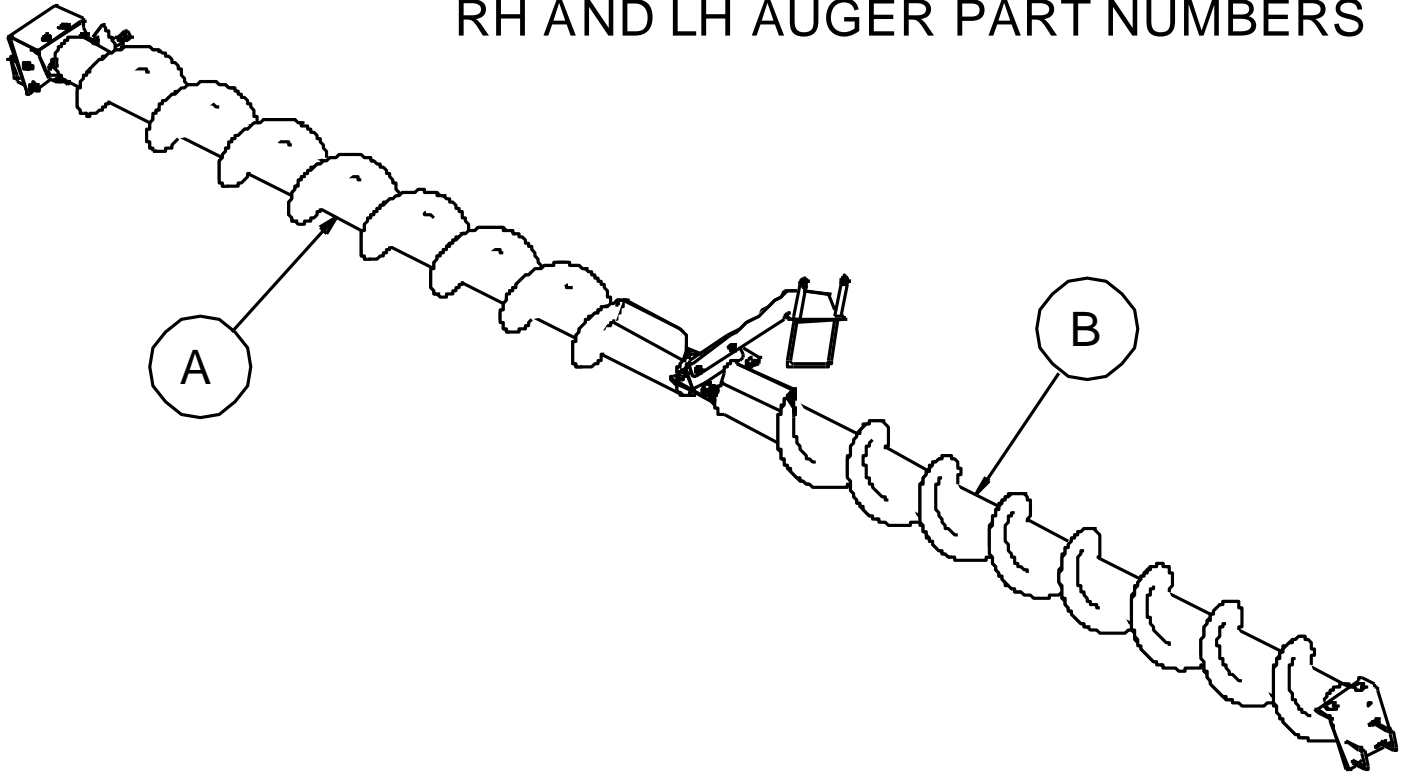

ASM AUGER No.	CROSS AUGER LENGTH (FT)	RH AUGER PART No. A	LH AUGER PART No. B
405801	25	408247	407054
405802	30	408218	406368
405803	36	408221	406294
405811	39	408224	407021
405610	40	408240	407015
405812	42	408227	407027

6. WARRANTY

1. Ag Shield Manufacturing warrants each new Ag Shield CrossAuger to be free from factory defects in material and workmanship under normal use and service, when set up and operated in accordance with factory instructions for one year from the date of delivery to the original purchaser.
2. Ag Shield's obligation under this warranty is limited to the supplying of replacement parts which are defective due to factory workmanship or material.
3. Your Ag Shield Dealer is responsible for providing warranty labour. Credit for required labour is specifically agreed to on an individual case basis.
4. The warranty is void on any unit which has been tampered with, or modified in any way not authorized in writing by the factory.
5. This warranty is void on any unit which is subject to misuse, negligence or accident, or which has had the serial number tampered or removed.
6. A "Warranty Claim Form" (sample at end of handbook) must be submitted to Ag Shield with returned parts in order for parts to be considered for warranty examination.
7. A warranty registration page from the front of this manual must be returned to the factory in order to qualify for warranty examination.
8. All returned parts must be sent to the factory freight prepaid, and warranty parts will be returned to you freight collect.
9. Replacement parts shipped pending receipt of parts for examination will be invoiced, and remain on your account until such time as examination indicates that a credit for those parts be issued or that payment is due.
10. Parts not returned for warranty examination within 30 days must be paid for at that time. Ag Shield will immediately reimburse any cash paid for items that are later determined defective.
11. Warranty terms and conditions are subject to provincial and state legislation.

6.1. WARRANTY CLAIM FORM

Ag Shield Mfg
 Box 9, Benito,
 MB, R0L 0C0
 ph 800-561-0132
 fax 204-539-2130
 ph 204-539-2000i

Dealer			Ag Shield Mfg Box 9, Benito, MB, R0L 0C0 ph 800-561-0132 fax 204-539-2130 ph 204-539-2000i			End User		
Address						Address		
City	State/Province	Zip/Postal				City	State/Province	Zip/Postal
DATE OF SALE	DATE FAILED	REPAIR DATE	ACRES/HOURS	MODEL	SERIAL NUMBER			
LABOUR HOURS	LABOUR RATE	LABOUR AMOUNT	PARTS MUST BE RETURNED TO BENITO MB FREIGHT PREPAID TO BE CONSIDERED FOR WARRANTY. DATE SHIPPED					
QUANTITY ITEM	PART NUMBER	DESCRIPTION	PRICE EACH	TOTAL PRICE	DESCRIBE THE CAUSE OF FAILURE AND CORRECTIVE ACTION TAKEN	APPROVE /REJECT		
1								
2								
3								
4								
5								
6								
7								
8								
I CERTIFY THAT THE INFORMATION IS ACCURATE AND THAT THE PARTS WERE REPLACED ON THE MACHINE			PARTS		DATE PARTS RECD	RECD BY		
			LABOUR		ITEMS TO SUPPLIERS			
			TOTAL					

