

# PARTS BOOK

## *Weaverline* Models 120, 121 and 124 Battery Powered Carts

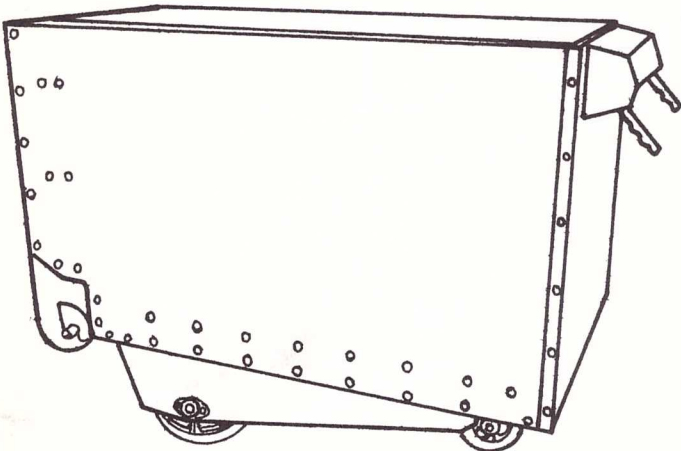

### LONG 1 PIECE UNDERCARRIAGE

**Model 121 (2-Battery)**

**Model 124 (4-Battery)**

Serial #3001 to #3299

Built after Sept. 1968

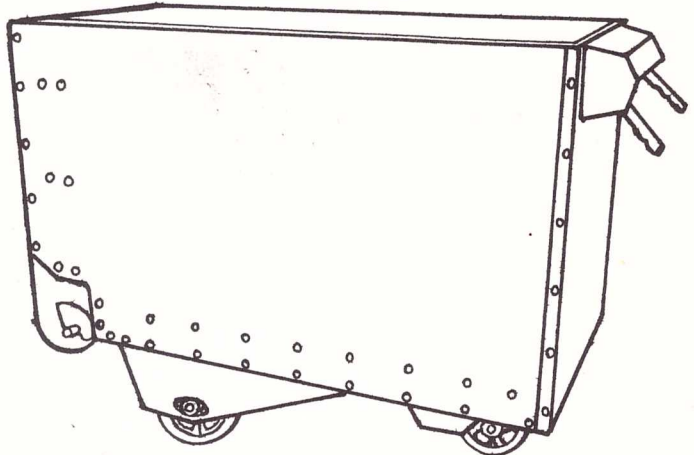

### 2 PIECE UNDERCARRIAGE

**Model 120**

Serial #1701 to #2000

Built prior to Sept. 1968

### IMPORTANT NOTE:

Before ordering parts, first determine the model cart for which parts are needed. Then consult right hand column on Parts List for your particular cart.

### FOR CARTS OTHER THAN BATTERY POWERED SELF-PROPELLED:









Parts for gas engine driven carts, include the word "GAS" after each part number.

Parts for AC electric carts (using overhead cord system) include the word "A-C" after each part number.

Parts for free wheel (push type) carts, include the word "PUSH" after each part number.

If parts are needed for elevator attachment, order by description giving model, year, and serial number of cart; and discharge height of elevator, 27" or 37".

# UNLOADING MECHANISM

- |  |  |  |  |
|--|--|--|--|
|  A 84 |  B 86 |  D 88 |  E 90 |
|  85   |  87   |  89   |  91   |

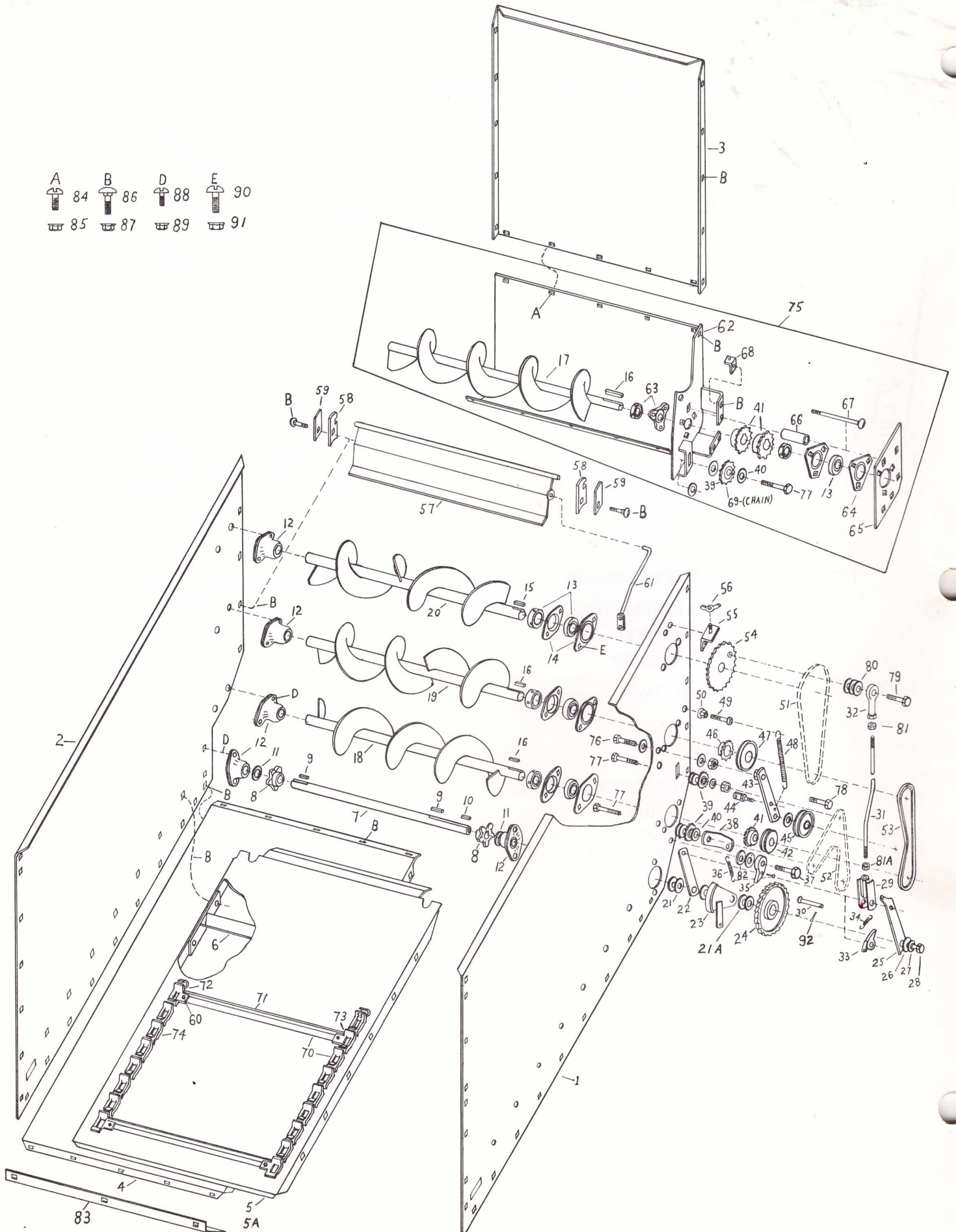

## UNLOADING MECHANISM

			120	121 124
1	202701	Side Sheet R.H.	1	1
2	202702	Side Sheet L.H.	1	1
3	202705	Front Panel	1	1
4	202703	Main Bottom (used after Sept. 1968)		1
4	202310	Main Bottom (used prior to Sept. 1968)	1	
5	202707	False Bottom — for easy installation order 5A	1	1
5A	202309	False Bottom Weld Assembly (includes (3) Ref. 6)	1	1
6	202790	Floor Support Weld Assembly	3	3
7	202721	Apron Drive Shaft	1	1
8	202756	Apron Drive Sprocket	2	2
9	69007	Key ¼ sq. x 1¾	2	2
10	69008	Key ¼ sq. x ¾	1	1
11	202889	Washer 1½ x 1 x 18 ga.	2	2
12	202914	Bearing Unit 1"	5	5
13	202915	Ball Bearing with Collar 1"	4	4
14	202916	Flangette 2 hole	6	6
15	69009	Key ¼ sq. x 1	1	1
16	69010	Key ¼ sq. x 2	3	3
17	202737	Auger Weld Assembly, Lower	1	1
18	202762	Auger Weld Assembly, next to lower	1	1
19	202770	Auger Weld Assembly, next to top	1	1
20	202771	Auger Weld Assembly, Top	1	1
21	68001	Washer 1" ⅛ thick	AR	AR
21A	68002	Washer 1" 1/32 thick	AR	AR
22	202728	Inside Link	1	1
23	202727	Cam Weld Assembly	1	1
24	202751	Ratchet	1	1
25	202819	Outside Link	1	1
26	202518	Washer Special ¾	1	1
27	64006	Lockwasher ¾	1	1
28	64003	Capscrew ¾ NC x 1	1	1
29	202782	Conn. Rod Yoke Weld Assembly	1	1
30	202888	Clevis Pin	1	1
31	202773	Connecting Rod	1	1
32	202911	Rod End Bearing	1	1
33	202476	Pawl Weld Assembly (Drive)	1	1
34	202932	Spring (Drive Pawl)	1	1
35	202846	Holding Pawl	1	1
36	202933	Spring (Holding Pawl)	1	1
37	65009	Capscrew ½ NC x 2¼	1	1
38	202799	Belt Guide	1	1
39	202906	Sprocket Assembly, Idler	3	3
40	65004	Washer ½	AR	AR
41	202908	Sprocket 18 Teeth	3	3
42	202904	Sheave 3¼ O.D.	1	1
43	202828	Beater Clutch Weld Assembly	1	1
44	202785	Pivot Bolt Weld Assembly	1	1
45	202926	Belt Idler	1	1
46	202909	Sprocket 13 Teeth	1	1
47	202905	Sheave 4½ O.D.	1	1
48	202934	Spring (Clutch)	1	1
49	63014	Machine Screw Truss Hd. ⅝ NC x 2	1	1
50	63010	Whiz Nut ⅝	AR	AR
51	202840	Chain #40 70 Pitches	1	1
52	202842	Chain #40 84 Pitches	1	1
53	202922	Belt (4L340)	1	1

CONTINUED

AR — As Required



## UNLOADING MECHANISM

			120	121 124
54	202812	Sprocket 42 Teeth	1	1
55	202792	Shield Bracket Weld Assembly	1	1
56	62004	Wing Nut $\frac{1}{4}$	1	1
57	202836	Loading Baffle Weld Assembly	1	1
58	202838	Baffle Bracket	2	2
59	202311	Baffle Shim	AR	AR
60	62005	Truss Hd. Rivet $\frac{1}{4} \times \frac{1}{2}$	18	18
61	202849	Baffle Arm Weld Assembly	1	1
62	202709	Trough Weld Assembly (used after Sept. 1968)		1
62	202312	Trough Weld Assembly (used prior to Sept. 1968)	1	
63	202920	Bearing with Collar	1	1
64	202949	Flangette 3 hole	2	2
65	202732	Bearing Plate	1	1
66	202748	Spacer	1	1
67	63015	Carr Bolt $\frac{5}{16}$ NC x 4	1	1
68	202791	Shield Bracket	1	1
69	202967	Chain #40 62 pitches	1	1
70	202822	Conveyor Ass'y Complete	1	1
71	202781	Conveyor Slat	9	9
72	202968	Attachment Link L.H.	9	9
73	202969	Attachment Link R.H.	9	9
74	202970	Plain Link #55	108	108
75	202700	Trough & Auger Ass'y (used after Sept. 1968)		1
75	202313	Trough & Auger Ass'y (used prior to Sept. 1968)	1	
76	65010	Capscrew $\frac{1}{2}$ NC $1\frac{1}{2}$	1	1
77	65002	Capscrew $\frac{1}{2}$ NC x 2	2	2
78	65011	Capscrew $\frac{1}{2}$ NC x $1\frac{3}{4}$	1	1
79	64008	Capscrew $\frac{3}{8}$ NC x $1\frac{1}{2}$	1	1
80	64005	Washer $\frac{3}{8}$	AR	AR
81	64007	Nut $\frac{3}{8}$ NF, Rod Top	1	1
81A	64009	Nut $\frac{3}{8}$ NC, Rod Lower	1	1
82	65004	Washer $\frac{1}{2}$	AR	AR
83	202711	Corner Baffle	1	1
84	63016	Truss Hd. Whiz Screw $\frac{5}{16}$ NC x $\frac{1}{2}$	AR	AR
85	63010	Whiz Nut $\frac{5}{16}$ NC	AR	AR
86	63009	Carr Bolt $\frac{5}{16}$ NC x $\frac{3}{4}$	AR	AR
87	63010	Whiz Nut $\frac{5}{16}$ NC	AR	AR
88	62001	Truss Hd. Machine Screw $\frac{1}{4}$ NC x $\frac{1}{2}$	AR	AR
89	62002	Whiz Nut $\frac{1}{4}$ NC	AR	AR
90	63017	Truss Hd. Mach. Screw $\frac{5}{16}$ NC x $\frac{3}{4}$	AR	AR
91	63010	Whiz Nut $\frac{5}{16}$ NC	AR	AR
92	61001	Cotter Pin $\frac{1}{8} \times \frac{3}{4}$	1	1

# REAR PANEL & CONTROLS

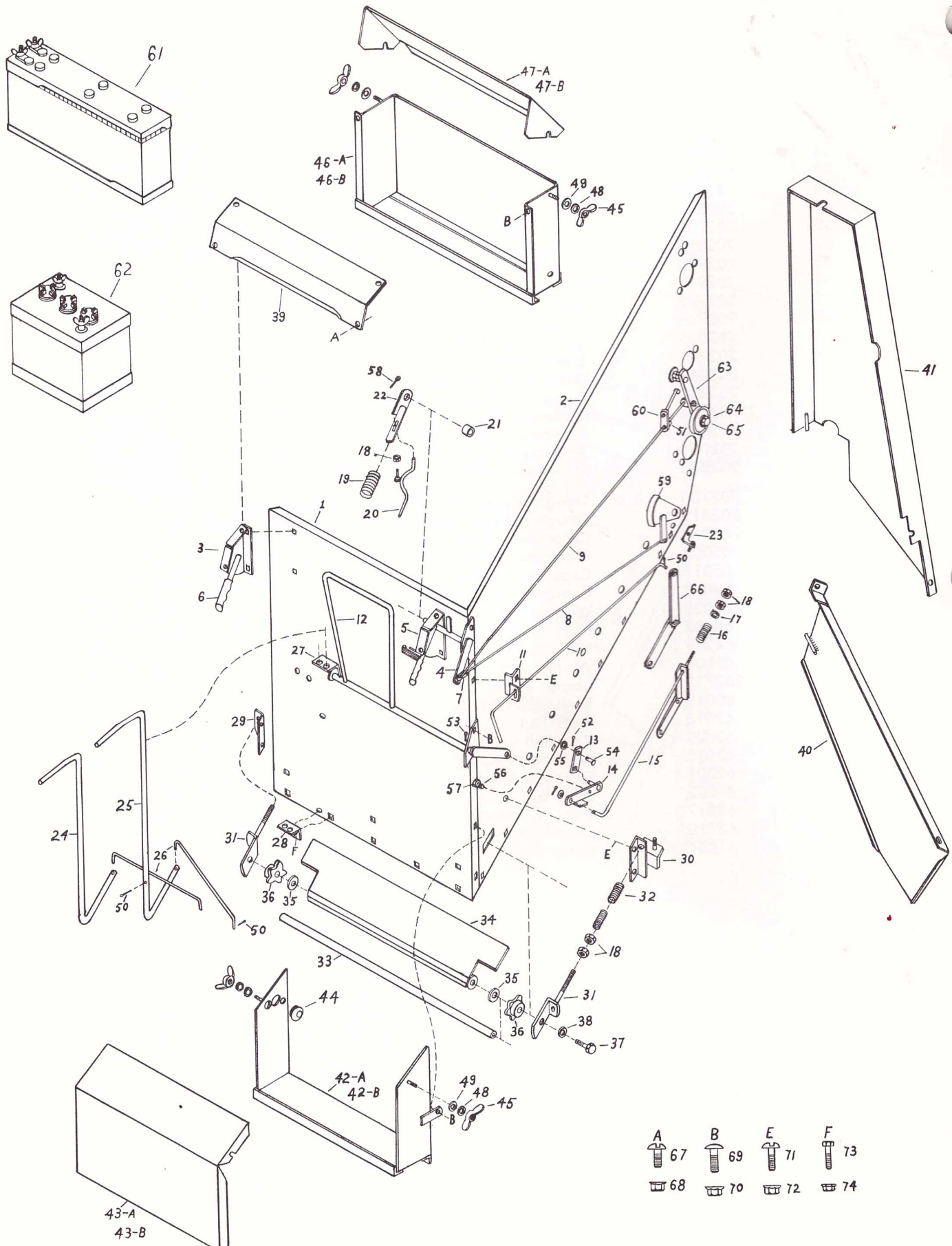

- |          |          |          |          |
|----------|----------|----------|----------|
| <b>A</b> | <b>B</b> | <b>E</b> | <b>F</b> |
|          |          |          |          |
| 67       | 69       | 71       | 73       |
|          |          |          |          |
| 68       | 70       | 72       | 74       |

## REAR PANELS & CONTROLS

			120
			<b>121</b>
			<b>124</b>
1	202706	Rear Panel	1
2	202701	Side Sheet R.H.	1
3	202775	Handle Weld Assembly L.H.	1
4	202745	Handle Weld Assembly R.H.	1
5	202821	Quadrant Weld Assembly	1
6	202913	Handle Grip	2
7	202796	Clevis Weld Assembly	1
8	202784	Cam Rod	1
9	202783	Beater Clutch Rod	1
10	202632	Feeder Clutch Rod	1
11	202622	Guide Weld Assembly	1
12	202601	Clutch Handle Weld Assembly	1
13	202605	Link	1
14	202606	Pivot Arm Weld Assembly	1
15	202609	S.P. Clutch Rod	1
16	202950	Spring (S.P. Clutch)	1
17	63005	Washer $\frac{5}{16}$	1
18	63007	Nut $\frac{5}{16}$ NC Hex	2
19	202931	Spring	1
20	202825	Trigger Weld Assembly	1
21	202789	Spacer	1
22	202787	Latch Weld Assembly	1
23	202626	Shield Bracket Weld Assembly	1
24	202634	Shift Lever Low, High	1
25	202633	Shift Lever Fwd., Rev.	1
26	202650	Shift Rod	2
27	202651	Bracket, Upper	1
28	202652	Bracket, Lower	1
29	202736	Bracket L.H.	1
30	202300	Bracket R.H. Weld Assembly	1
31	202839	Tightener Bracket Weld Assembly	2
32	202935	Spring (Conveyor)	4
33	202734	Rear Apron Shaft	1
34	202818	False End Weld Assembly	1
35	67001	Washer $\frac{3}{4}$	2
36	202757	Apron Idler Sprocket	2
37	64012	Capscrew $\frac{3}{8}$ NC x $\frac{3}{4}$	2
38	64006	Lockwasher $\frac{3}{8}$	2
39	202760	Dash	1
40	202628	Lower Shield Weld Assembly	1
41	202827	Main Shield Weld Assembly	1
42A	202301	Battery Box Weld Assembly (one 12 volt)	1
42B	202302	Battery Box Weld Assembly (two 6 volt)	1
43A	202303	Rear Cover (for 42A)	1
43B	202304	Rear Cover (for 42B)	1
44	202962	Grommet	AR
45	62004	Wing Nut $\frac{1}{4}$	4
46A	202305	Battery Box Weld Assembly (one 12 volt)	1
46B	202306	Battery Box Weld Assembly (two 6 volt)	1
47A	202307	Front Cover (for 46A)	1
47B	202308	Front Cover (for 46B)	4
48	62006	Lockwasher $\frac{1}{4}$	4
49	62007	Washer $\frac{1}{4}$	4
50	61002	Cotter Pin $\frac{3}{32}$ x $\frac{5}{8}$	AR
51	202956	Shaft Collar $\frac{5}{16}$	1
52	61001	Cotter Pin $\frac{1}{8}$ x $\frac{3}{4}$	AR
53	61003	Cotter Pin $\frac{1}{8}$ x 1	AR

CONTINUED

AR — As Required



# REAR PANEL & CONTROLS

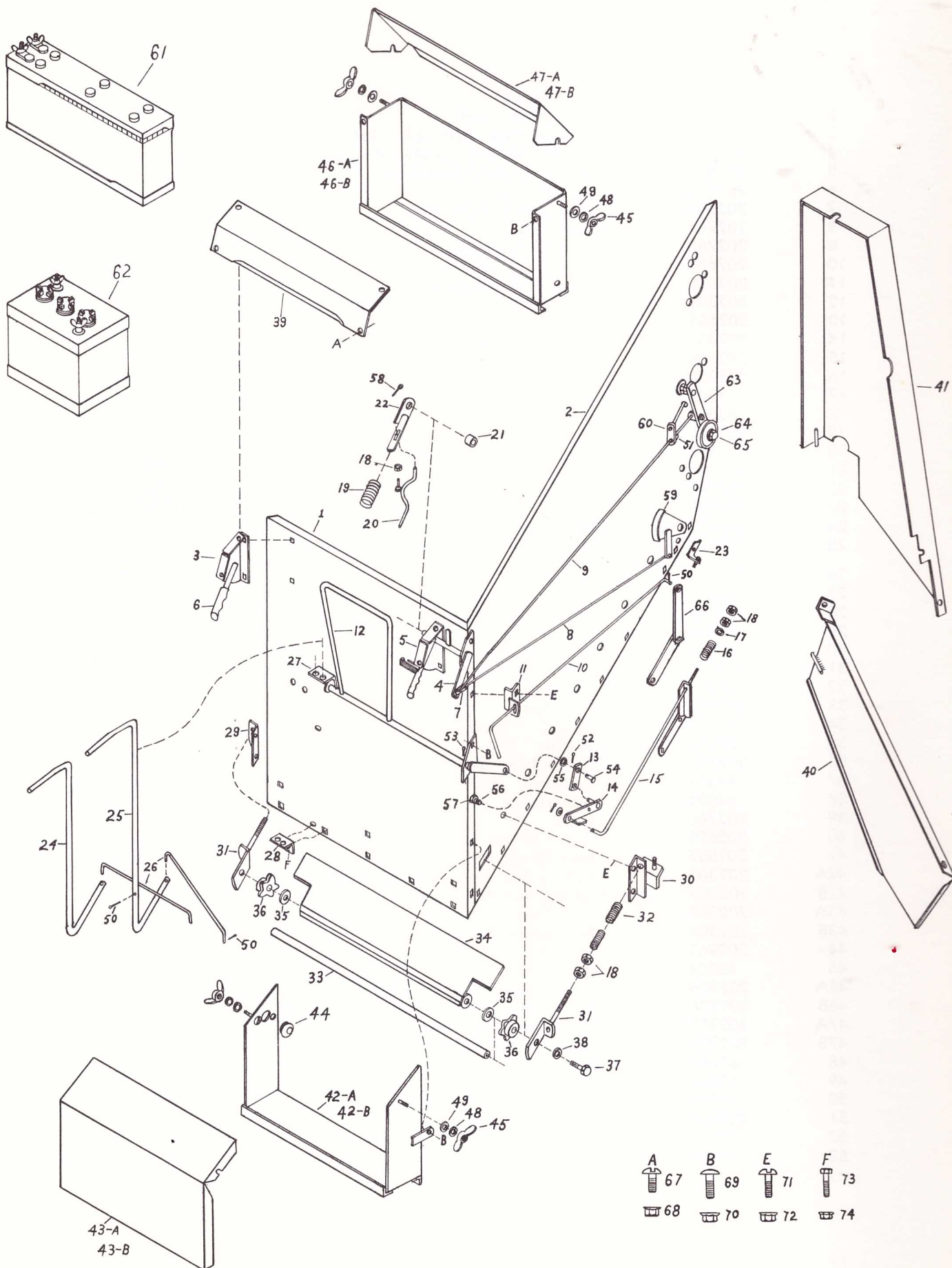

## REAR PANELS & CONTROLS

			<b>120</b>
			<b>121</b>
			<b>124</b>
54	202892	Clevis Pin $\frac{5}{16}$ x $\frac{3}{4}$	1
55	63005	Washer $\frac{5}{16}$	1
56	64003	Capscrew $\frac{3}{8}$ NC x 1	1
57	64009	Nut $\frac{3}{8}$ NC Hex	1
58	61003	Cotter Pin $\frac{1}{8}$ x 1	1
59	202727	Cam Weld Assembly	1
60	202849	Baffle Arm Weld Assembly	1
61	202965	12 Volt Battery	2
62	202966	6 Volt Battery	4
63	202828	Beater Clutch Weld Assembly	1
64	202926	Belt Idler	1
65	65010	Capscrew $\frac{1}{2}$ NC x $1\frac{1}{2}$	1
66	202646	Feeder Clutch Weld Assembly	1
67	63016	Truss Hd. Whiz Screw $\frac{5}{16}$ NC x $\frac{1}{2}$	AR
68	63010	Whiz Nut $\frac{5}{16}$ NC	AR
69	63009	Carriage Bolt $\frac{5}{16}$ NC x $\frac{3}{4}$	AR
70	63010	Whiz Nut $\frac{5}{16}$ NC	AR
71	63017	Truss Hd. Mach. Screw $\frac{5}{16}$ NC x $\frac{3}{4}$	AR
72	63010	Whiz Nut $\frac{5}{16}$ NC	AR
73	62008	Capscrew $\frac{1}{4}$ NC x $\frac{5}{8}$	AR
74	62002	Whiz Nut $\frac{1}{4}$ NC	AR

AR — As Required



# TRACTION DRIVE UNIT

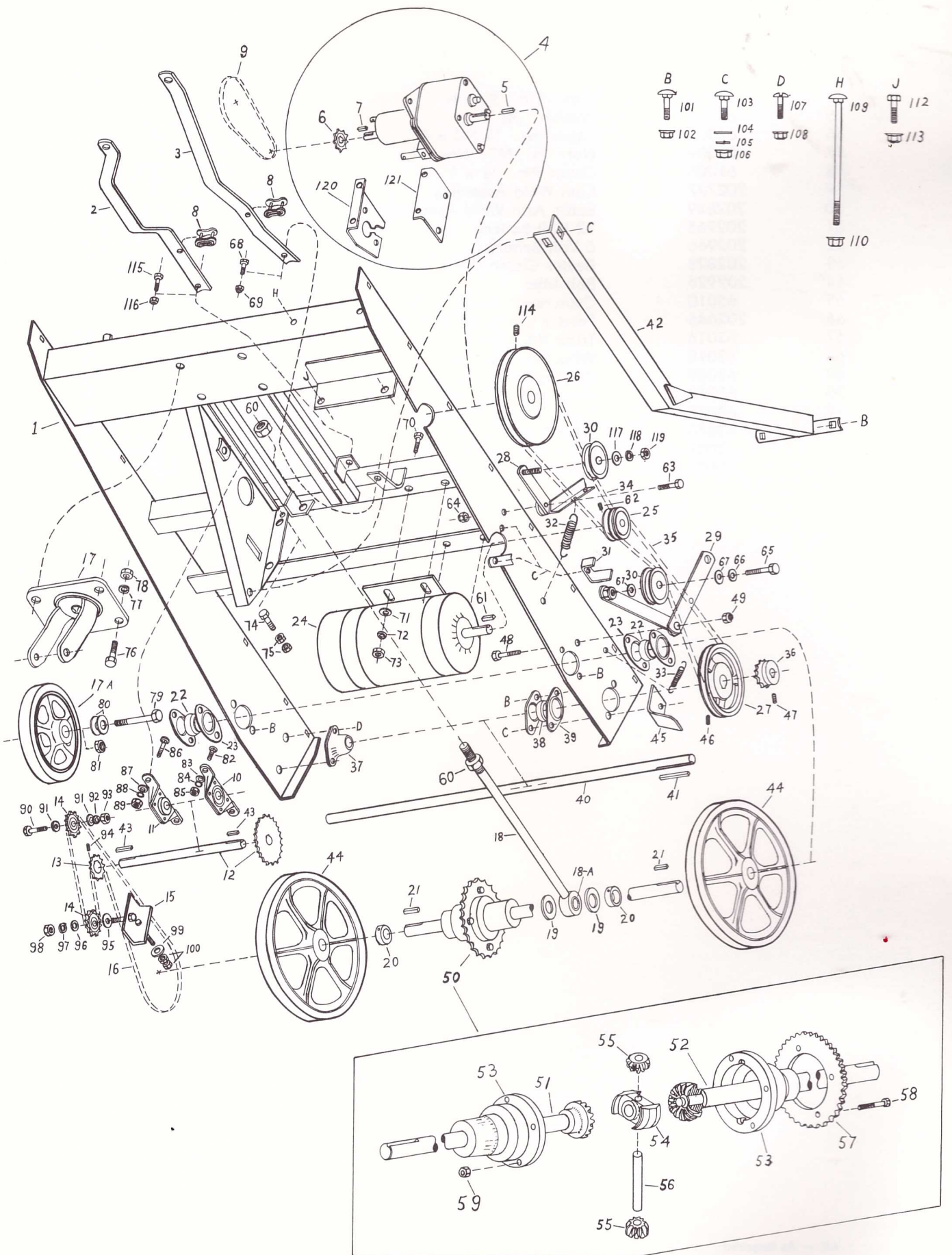

**TRACTION DRIVE UNIT**

			<b>120</b>	<b>121</b>
			<b>124</b>	
1	202675	Undercarriage Weld Assembly (Give Model #, Serial #, Date of Purchase)	1	1
2	202649	Shift Arm (Low, High)	1	1
3	202648	Shift Arm (Forward, Reverse)	1	1
4	202669	Transmission — Complete Ass'y	1	1
5	69001	Woodruff Key #5 (1/8 x 5/8)	1	1
6	202619	Sprocket 8 Teeth	1	1
7	69002	Woodruff Key Special	1	1
8	202940	Connector Link #40	2	2
9	202616	Chain #41 38 Pitches	1	1
10	202670	Bearing — Pillow Block	1	1
11	202671	Bearing — Pillow Block (Heavy Duty)	1	1
12	202678	Shaft and Sprocket Weld Assembly	1	1
13	202696	Sprocket 11 Teeth	1	1
14	202679	Idler Sprocket Assembly	2	2
15	202672	Idler Bracket Weld Assembly	1	1
16	202841	Chain #40 140 Pitches	1	1
17	202901	Caster Wheel Ass'y (Includes 17, 17A)	1	1
17	202676	Caster Fork Ass'y		
17A	202677	Caster Wheel		
18	202680	Brace Weld Assembly — with Bushing #202691	1	1
18A	202691	Bushing	1	1
19	68001	Washer 1"	2	2
20	202697	Shaft Collar 1"	3	3
21	69003	Key 1/4 Sq. x 2 1/2	2	2
22	202915	Ball Bearing 1" with Collar	2	2
23	202916	Flangette 2 Hole	4	4
24	202692	Motor 24 Volt D.C. 5/8 Dia. Shaft		1
24		Motor 7/8 Dia. Shaft — Consult Factory	1	
25	202693	Sheave — 2 Groove 5/8 Bore		1
26	202971	Sheave — 2 Groove 7/8 Bore	1	
26	202694	Sheave 10 1/2 O.D.		1
27	202972	Sheave 9 1/2 O.D.	1	
27	202695	Sheave (6 1/4 O.D.)		1
28	202318	Sheave (5 3/4 O.D.)	1	
28	202610	SP Clutch Weld Assembly	1	1
29	202646	Feeder Clutch Weld Assembly	1	1
30	202926	Belt Idler	2	2
31	202681	Belt Guide		2
32	202673	Spring (SP Clutch Return)	1	1
33	202674	Spring (Feeder Clutch)	1	1
34	202698	Belt 4L450		1
35	202319	Belt 4L440	1	
35	202699	Belt 4L500		1
36	202320	Belt 4L490	1	
36	202907	Sprocket 13 Teeth	1	1
37	202973	Bearing Unit		1
38	202917	Ball Bearing with Collar 3/4	1	
38	202917	Ball Bearing with Collar 3/4	1	1
39	202918	Flangette 2 Hole	2	2
40	202722	Feeder Counter Shaft	1	1
41	69004	Key 3/16 Sq. x 2 1/2	1	
42	202683	Chain Guard Weld Assembly	1	1
43	69005	Key 3/16 Sq. x 1	1	1
44	202900	Wheel	2	2
45	202667	Belt Guide	1	1
46	63013	Socket Set Screw Cup Pt. 5/16 x 3/8	1	1
47	62003	Socket Set Screw Cup Pt. 1/4 x 1/4	1	1
48	64001	Cap Screw 3/8 NC x 1 1/4	1	1
49	64002	Locknut 3/8 NC	1	1
50	202668	Differential Ass'y		
51	202684	Axle & Gear Ass'y Short	1	1
52	202685	Axle & Gear Ass'y Long	1	1
53	202686	Housing	2	2
54	202687	Diff. Carrier	1	1
55	202688	Bevel Pinion Gear	2	2
56	202689	Diff. Carrier Pin	1	1

**CONTINUED**



TRACTION DRIVE UNIT

			120	121 124
57	202690	Sprocket 40 Teeth	1	1
58	63001	Capscrew $\frac{5}{16}$ x $1\frac{1}{2}$ NF Grade 5	4	4
59	63002	Nut $\frac{5}{16}$ NF (Use 2 per Capscrew)	8	8
60	65001	Nut $\frac{1}{2}$ NC	2	2
61	69006	Key $\frac{3}{16}$ Sq. x $1\frac{3}{8}$	1	1
62	63013	Socket Set Screw Cup Pt. $\frac{5}{16}$ x $\frac{3}{8}$	1	1
63	64003	Capscrew $\frac{3}{8}$ NC x 1	1	1
64	64002	Locknut $\frac{3}{8}$ NC	1	1
65	65002	Capscrew $\frac{1}{2}$ NC x 2	1	1
66	65003	Lockwasher $\frac{1}{2}$	1	1
67	65004	Washer $\frac{1}{2}$	2	2
68	63003	Capscrew $\frac{5}{16}$ NC x $\frac{3}{4}$	1	1
69	63004	Locknut $\frac{5}{16}$ NC	1	1
70	63003	Capscrew $\frac{5}{16}$ x NC x $\frac{3}{4}$	4	4
71	63005	Washer $\frac{5}{16}$	4	4
72	63006	Lockwasher $\frac{5}{16}$	4	4
73	63007	Nut $\frac{5}{16}$ NC Hex	4	4
74	63008	Capscrew $\frac{5}{16}$ NC x $1\frac{1}{4}$	1	1
75	63007	Nut $\frac{5}{16}$ NC Hex	2	2
76	65005	Capscrew $\frac{1}{2}$ NC x 1	4	4
77	65003	Lockwasher $\frac{1}{2}$	4	4
78	65001	Nut $\frac{1}{2}$ NC Hex	4	4
79	65006	Capscrew $\frac{1}{2}$ NF x $3\frac{3}{4}$	1	1
80	65004	Washer $\frac{1}{2}$	2	2
81	65007	Locknut $\frac{1}{2}$ NF	1	1
82	64004	Carr Bolt $\frac{3}{8}$ NF x $\frac{7}{8}$	2	2
83	64005	Washer $\frac{3}{8}$	2	2
84	64006	Lockwasher $\frac{3}{8}$	2	2
85	64007	Nut $\frac{3}{8}$ NF	2	2
86	64001	Capscrew $\frac{3}{8}$ NC x $1\frac{1}{4}$	2	2
87	64005	Washer $\frac{3}{8}$	2	2
88	64006	Lockwasher $\frac{3}{8}$	2	2
89	64009	Nut $\frac{3}{8}$ NC Hex	2	2
90	65002	Capscrew $\frac{1}{2}$ NC x 2	1	1
91	65004	Washer $\frac{1}{2}$	2	2
92	65003	Lockwasher $\frac{1}{2}$	1	1
93	65001	Nut $\frac{1}{2}$ NC Hex	1	1
94	62003	Socket Setscrew Cup Pt. $\frac{1}{4}$ x $\frac{1}{4}$	1	1
95	202614	Washer $\frac{1}{2}$ I.D. x $2\frac{3}{8}$ O.D.	1	1
96	65004	Washer $\frac{1}{2}$	1	1
97	65003	Lockwasher $\frac{1}{2}$	1	1
98	65001	Nut $\frac{1}{2}$ NC Hex	1	1
99	64005	Washer $\frac{3}{8}$	1	1
100	64007	Nut $\frac{3}{8}$ NC Hex	2	2
101	63009	Carr Bolt $\frac{5}{16}$ x $\frac{3}{4}$	AR	AR
102	63010	Whiz Nut $\frac{5}{16}$	AR	AR
103	63009	Carr Bolt $\frac{5}{16}$ x $\frac{3}{4}$	AR	AR
104	63005	Washer $\frac{5}{16}$	AR	AR
105	63006	Lockwasher $\frac{5}{16}$	AR	AR
106	63007	Nut $\frac{5}{16}$ NC Hex	AR	AR
107	62001	Machine Screw Truss Head $\frac{1}{4}$ x $\frac{1}{2}$	AR	AR
108	62002	Whiz Nut $\frac{1}{4}$	AR	AR
109	63011	Carr Bolt $\frac{5}{16}$ x 5	2	2
110	63010	Whiz Nut $\frac{5}{16}$	AR	AR
112	63003	Capscrew $\frac{5}{16}$ x $\frac{3}{4}$	AR	AR
113	63010	Whiz Nut $\frac{5}{16}$	AR	AR
114	63013	Soc. Set Screw $\frac{5}{16}$ x $\frac{3}{8}$ Cup Pt.	AR	AR
115	63012	Capscrew $\frac{5}{16}$ NC x 1	1	AR
116	63004	Locknut $\frac{5}{16}$	1	AR
117	65004	Washer $\frac{1}{2}$	1	AR
118	65003	Lockwasher $\frac{1}{2}$	1	AR
119	65008	Jam Nut $\frac{1}{2}$ NC Hex	1	AR
120	202618	Mounting Bracket Output End	1	1
121	202620	Mounting Bracket Input End	1	1

AR — As Required



## WIRES AND SWITCHES

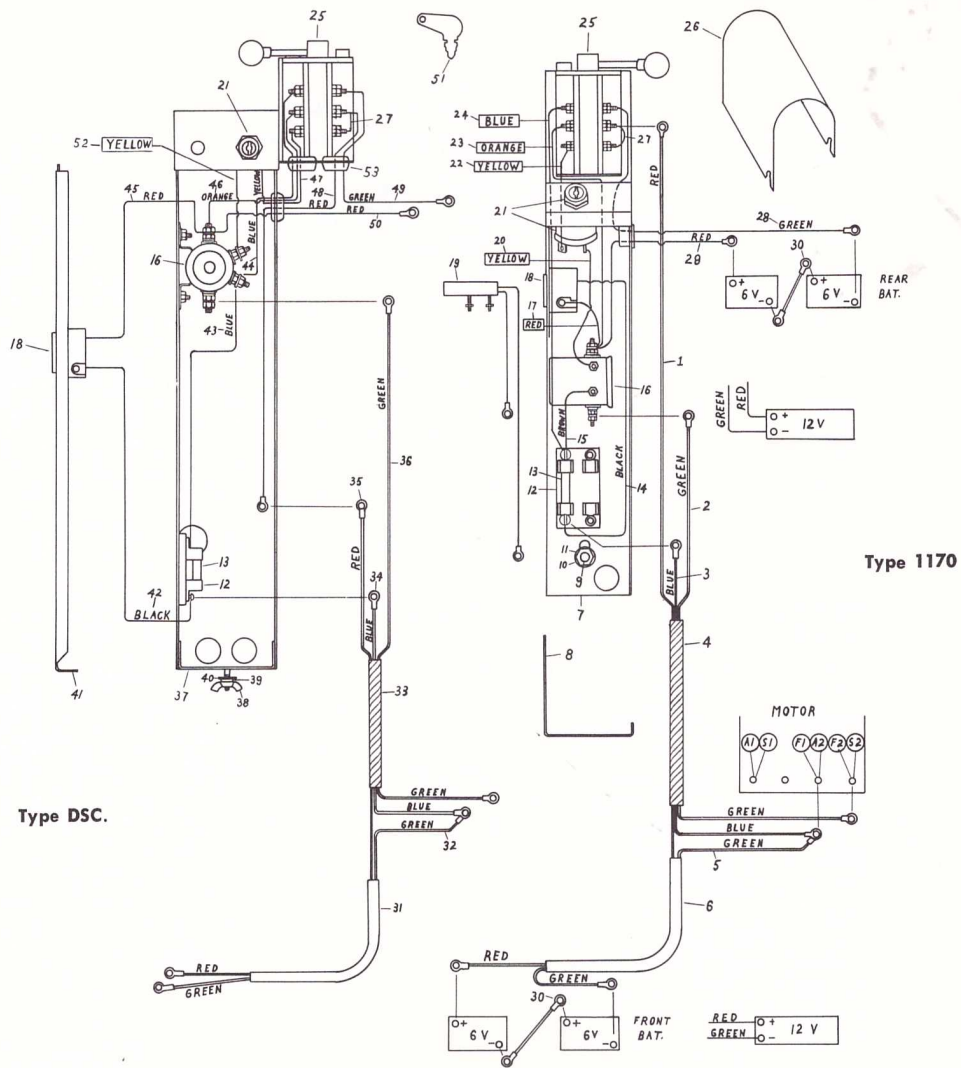

			Type 1170	Type DSC
1	202851	Wire Harness (includes Ref. 1 thru 6)	1	
1	202852	Wire — Drum Switch to Front Battery	1	
2	202853	Wire — Solenoid to Motor	1	
3	202854	Wire — Fuse Block to Motor	1	
4	202855	Wire Cover	1	
5	202856	Wire — Front Battery to Motor	1	
6	202894	Conduit	1	
7	202857	Control Box Weld Assembly	1	
8	202858	Control Box Cover	1	
9	202859	Threaded Rod 1/4	1	
10	62009	Nut 1/4 NC Hex	1	
11	62007	Washer 1/4	1	
12	202951	Fuse Block	1	1
13	202952	Fuse 75 amp.	1	1
14	202860	Wire — Fuse Block to Charger Receptacle	1	
15	202861	Wire — Fuse Block to Solenoid	1	
16	202953	Solenoid 12 volt	1	1
17	202862	Wire — Solenoid to Charger Receptacle	1	
18	202963	Charger Receptacle (Round) — early carts only	AR	AR
18A	202964	Charger Plug (Round) — for above receptacles	AR	AR
19	202897	Charger Receptacle (Rectangular) — Includes wires and brackets	AR	AR
19A	202960	Charger Plug (Rectangular)—for above receptacle	AR	AR
20	202863	Wire — Solenoid to Key Switch	1	

AR — As Required

CONTINUED

## WIRES & SWITCHES

			Type 1170	Type Disc
21	202954	Key Switch — with one Key	1	1
22	202863	Wire — Key to Drum Switch	1	
23	202864	Wire — Solenoid to Drum Switch	1	
24	202865	Wire — Fuse Block to Drum Switch	1	
25	202866	Drum Switch Ass'y (includes 202867)	1	1
26	202867	Drum Switch Cover	1	1
27	202868	Wire — Inside Drum Switch	1	1
28	202869	Wire — Drum Switch to Rear Battery	1	
29	202870	Wire — Solenoid to Rear Battery	1	
30	202871	Wire — Battery Connecting	2	
	202877	Wire Harness (includes 31 thru 36)	1	
31	202894	Conduit	1	1
32	202856	Wire — Motor to Front Battery		1
33	202855	Wire Cover		1
34	202874	Wire — Fuse to Motor		1
35	202875	Wire — Battery to Ref. #48		1
36	202876	Wire — Battery to Solenoid		1
37	202877	Control Box Weld Assembly		1
38	62004	Wing Nut — 1/4 — NC		AR
39	62006	Lockwasher 1/4		AR
40	62007	Washer 1/4		AR
41	202878	Control Box Cover		1
42	202879	Wire — Fuse to Charger Receptacle		1
43	202880	Wire — Charger Plug to Solenoid		1
44	202881	Wire — Solenoid to Drum Switch		1
45	202882	Wire — Charger Receptacle to Solenoid		1
46	202883	Wire — Solenoid to Drum Switch		1
47	202884	Wire — Key to Drum Switch		1
48	202885	Wire — Drum Switch to Ref. #35		1
49	202886	Wire — Drum Switch to Battery		1
50	202887	Wire — Battery to Solenoid		1
51	202955	Key	1	1
52	202874	Wire — Solenoid to Key Switch		1
53	202962	Grommet	AR	5

## ASSEMBLY & CONVERSION KITS

202314	Complete Control Box Ass'y — 2 Speed		1
202316	Complete Control Box Ass'y — 2 Speed	1	

The following Single Speed Control Boxes are available for the replacement of the above Two Speed Control Boxes. **CAUTION** — These assemblies must be used with a 24 Volt Charger only!

202315	Complete Control Box Ass'y — Single Speed		1
202317	Complete Control Box Ass'y — Single Speed	1	

A factory rebuilt Ass'y for any of the above can be ordered by adding "Rebuilt" after the appropriate Part No.

90001	4 Battery Conversion Kit — This kit includes all items necessary to convert Models 120, 121 (2 Battery Carts) to a 4 Battery Cart.		
-------	--	--	--