

ENGINE TSF150-230 (Engines & Carburetor)		POS.	QTY	PART NO	ERP CODE	ENGLISH NAME
		A	1	7881		TY 150CC Engine Complete Assembly
		A	1			TY 170CC Engine Complete Assembly
		A	1	7882		TY 189CC Engine Complete Assembly
		A	1	3718		TY 230CC Engine Complete Assembly
		A	1	7887		Zongshen 250CC Engine CB250-F
		1	1		L.TY223.00	230cc Air Cooled Engine
		1-1	1		1.061.0230	Engine Sprocket 428*15T*φ20
		1-2	1		1.008.0050	Manifold Gasket
		2	1		1.004.0300	Manifold
		3	2		7.010.0020	Bolts M6*16
		11	1		1.001.0230	Gear shifter
		11-1	1		7.020.0010	Bolts M6*15
	1	8520		Clutch Assy		
CARBURETOR (Engines & Carburetor)						
		A		7894		TSF150 Carburetor Complete Assembly
				3719		TSF230 Carburetor Complete Assembly
				7895		TSF250 Carburetor Complete Assembly
		6	1	3325	1.016.0281	Carburetor PE28-5
		4	1	3443	1.016.0271	Connector of Carburetor
		5	2	3327	1.030.0080	Hoops φ32-44
ENGINE'S BOLT (Engines & Carburetor)						
		A		3720		Engine's Bolt Complete Assembly
		7	1		7.010.0620	Bolts M10*1.25*120
		8	1		3.330.0230	Spacer φ10*φ20*10
		9	2		7.140.0030	Lock Nuts M10*1.25
		10	1		7.010.0600	Bolts M10*1.25*115
ENGINE'S HANGER A (Engines & Carburetor)						
		A		3425		Engine's Hanger A Complete Assembly
		12	5		7.140.0020	Lock Nuts M8
		13	4		7.010.0250	Bolts M8*95
		14	2		3.530.0210	Engine Hangers A
		19	8		7.210.0080	Washers φ8*φ16
ENGINE'S HANGER B (Engines & Carburetor)						
		A		3413		Engine's Hanger B Complete Assembly
		12	1		7.140.0020	Lock Nuts M8
		15	1		7.010.0215	Bolts M8*65
		16	1		3.530.0130	Engine Hangers B
		17	4		7.070.0140	Bolts M8*16
		18	4		7.220.0020	Washers φ8
19	8		7.210.0080	Washers φ8*φ16		
AIR FILTER (Air Filter & Exhaust)						
		A		3721		Air Filter Complete Assembly
		1	1		1.030.0040	Hoops φ38-57
		2	1	3324	1.028.0090	Rubber connector
		3	2	3454	7.290.0030	Clip
		4	0.02	3453	9.200.0030	Transparent pipe φ12
		5	1		1.083.0050	Cover φ12.5
		6	1	3328	1.030.0090	Hoops φ140-160
		7	1	3329	1.031.0060	Air Filter Front cover
		8	1	3331	1.034.0080	Air Filter bracket
9	1	3326	1.029.0080	Sponge Element		

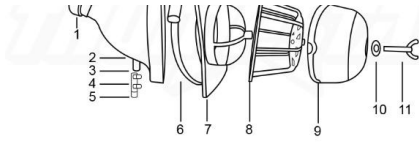

10	1		7.210.0090	Flat Washers Φ8*Φ22
11	1		7.130.0010	Screws M6*40
12	4		7.170.0020	Lock Nuts M6
13	2		7.050.0030	Screws M6*25
14	1	3330	1.032.0050	Filter Shield
15	6		7.100.0110	Screws 4.8*16
16	2		7.050.0020	Screws M6*16

STATOR COVER (Engines & Carburetor)

A - Assembly



POS.	QTY	PART NO	ERP CODE	ENGLISH NAME
A		3722		Engine Cover Complete Assembly
1-3	2		7.010.0050	Bolts M6*30
1-4	1		1.137.0310	Engine Sprocket Cover

KICK START (Engines & Carburetor)

A - Assembly

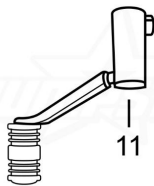

POS.	QTY	PART NO	ERP CODE	ENGLISH NAME
11	1	3364	1.001.0230	Gear shifter

MUFFLER (Air Filter & Exhaust)

A - Assembly

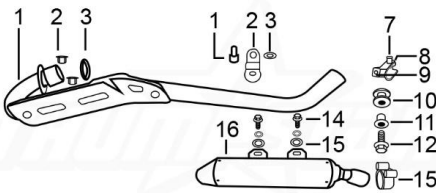

POS.	QTY	PART NO	ERP CODE	ENGLISH NAME
A		3723		Muffler Complete Assembly
1	1	3334	1.086.0450	Exhaust Pipe
2	3		7.140.0020	Bolts M8
3	1	3335	1.087.0020	Seal Ring
4	1		7.070.0140	Bolts M8*16
5	1		1.084.0030	Fastener
6	3		7.220.0020	Washers
7	1		7.010.0070	Bolts M6*40
8	1	3428	1.089.0100	Hoops Φ32-Φ35
9	1		7.190.0010	Nut
10	1	3422	1.088.0020	Rubber Cushion
11	1		3.340.0350	Spacer Φ6.5*Φ9-Φ20*15
12	1		7.010.0040	Screws M6*25
13	1		1.089.0040	Hoops Φ40-Φ43
14	1		7.010.0130	Bolts M8*20
15	2		7.210.0090	Washers Φ8*Φ22
16	1	3333	1.085.0200	Muffler 280mm

BAR / FORK CLAMPS (Steering)

A - Assembly

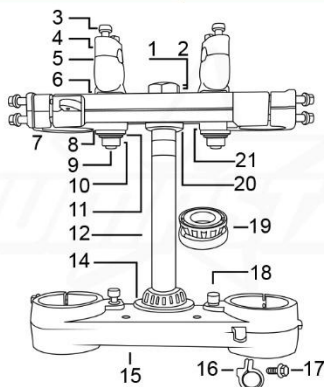

POS.	QTY	PART NO	ERP CODE	ENGLISH NAME
A		3724		Fork Clamps Complete Assembly
1	1		7.210.0270	Flat Washers Φ23*Φ35
2	1		7.180.0070	Nuts M22
3	4		7.070.0170	Screws M8*30
4	2	3417	4.080.0210	Upper Riser Φ28.8
5	2	3418	4.090.0240	Bottom Riser Φ28.8
6	4		7.210.0340	Step Washers Φ26*Φ30*3
7	8		7.010.0172	Bolts M8*40
8	1	3415	4.060.0240	Upper Clamp Φ53*192
9	2		7.020.0100	Bolts M12*1.25*72
10	2		7.140.0040	Nuts M12*1.25
11	2		7.210.0180	Flat WashersΦ12*Φ24*1.5
12	1	3368	4.100.0100	Steering Axle 278mm
13	2	3370	7.280.0021	Rubber Cover
14	1		7.210.0330	Flat Washer Φ26*Φ35*1
15	1	3416	4.070.0210	Bottom Clamp Φ58.5*192
16	1	3437	7.430.0090	Clip
17	1		7.010.0020	Bolts M6*16
18	2		7.070.0140	Screws M8*16
19	2	3381	7.350.0080	Taper BearingsΦ25*Φ52
20	1		7.270.0010	Lock Nuts M25*1*7
21	4		3.250.0030	Rubber cushion

FRAME (Frame)

A - Assembly

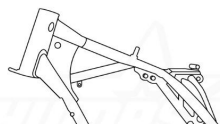

POS.	QTY	PART NO	ERP CODE	ENGLISH NAME
A	1	3375	3.500.1350	Frame



FRAME ASSEMBLY PARTS (Frame)

A - Assembly

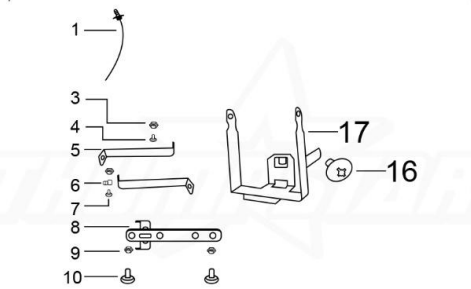

POS.	QTY	PART NO	ERP CODE	ENGLISH NAME
A	1			Frame Parts Complete Assembly
1	1		8.010.0090	Belts 5*168
3	2		7.190.0010	Nuts M6
4	1		7.050.0011	Screws M6*12
5	2	3414	3.730.0070	Brackets
6	1	3426	7.430.0060	Buckle
7	1		7.050.0020	M6*16 Hexagon socket head cap screws
8	1	3449	3.740.0090	Fix Bracket
9	2		7.170.0020	Nuts M6
10	2		7.050.0020	Bolts M6*16
16	1		7.050.0011	Bolts M6*12
17	1	3425	3.630.0150	Battery Box

SUBFRAME (Frame)

A - Assembly

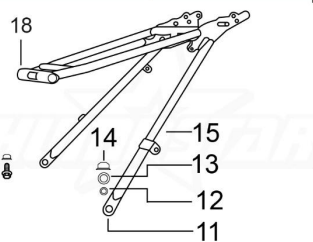

POS.	QTY	PART NO	ERP CODE	ENGLISH NAME
A	1	3376		Subframe Complete Assembly
11	2		7.010.0140	Bolts M8*25
12	1		7.220.0020	Spring washers Φ8
13	1		7.210.0080	Washers Φ8*Φ16
14	2		7.140.0020	Lock Nuts M8
15	1		3.700.0280	Sub-Frame
18	2		7.070.0195	Screws M8*45

BRAKE PEDAL (Frame)

A - Assembly

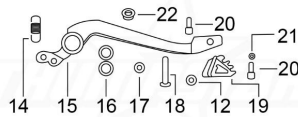

POS.	QTY	PART NO	ERP CODE	ENGLISH NAME
A	1	3725		Brake Pedal Complete Assembly
12	3		7.160.0040	Lock Nuts M8
14	1	3379	4.270.0100	Springs
15	1	3378	4.260.0112	Foot brake pedal
16	2	3031	7.390.0010	Bearings 608
17	1		7.210.0110	Washers Φ9*Φ17*2.5
18	1		7.120.0210	Screws M8*40
19	1	3363	4.280.0030	Head of brake pedal
20	2		7.070.0060	Screws M6*16
21	1		7.150.0010	Nuts M6
22	1	3526	7.440.0010	Rear Brake limit eccentric

FOOTPEG (Frame)

A - Assembly

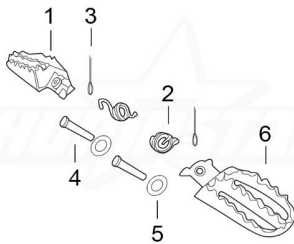

POS.	QTY	PART NO	ERP CODE	ENGLISH NAME
A	1	3726		Pedal Complete Assembly
1	1		3.570.0092	L.Footpeg
2	1set	3377	3.590.0010	Springs of Footpegs
3	3		7.230.0030	Split pin Φ2.5*16
4	2		7.240.0030	Cylindrical pin Φ8*42
5	2		7.210.0080	Washers Φ8*Φ16
6	1		3.570.0091	R.Footpeg

STAND (Frame)

A - Assembly

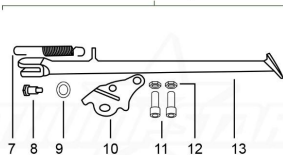

POS.	QTY	PART NO	ERP CODE	ENGLISH NAME
A	1	3727		Complete 310mm Stand Assembly
7	1	3252	3.620.0010	Spring 90mm
8	1		7.030.0010	Step Bolts M10*25
9	1		7.210.0180	Washers Φ12*Φ24*1.5
10	1	3424	3.600.0050	Fix Bracket
11	2		7.070.0170	Screws M8*30
12	3		7.160.0040	Lock Nuts M8
13	1	3380	3.610.0270	Side Stand 310mm

TENSIONER (Suspensions & Swingarm)

A - Assembly



POS.	QTY	PART NO	ERP CODE	ENGLISH NAME
A	1	3728		Chain Roller Complete Assembly
3	1		7.230.0030	Split pin Φ2.5*16
23	1	3411	2.070.0050	Tensioner bracket
24	1	3030	2.060.0010	Tensioner
25	2		7.390.0200	Bearings 6900
26	5		7.210.0130	Washers Φ10*Φ18*1.5



REAR LINKAGE

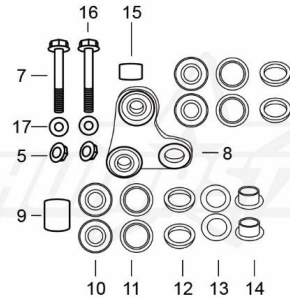
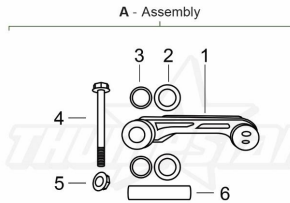

POS.	QTY	PART NO	ERP CODE	ENGLISH NAME
A	1	3466		Linkage Complete Assembly
1	1		3.160.0030	U Linkage A
2	2	3468	7.330.0010	Oil Seal $\Phi 20 \times 32 \times 5$
3	2	3474	7.360.0010	Needle Bearings HK2012
4	1	3475	7.010.0780	Bolts M12*1.25*118
5	3	3476	7.140.0040	Nuts M12
6	1	3477	3.340.0340	Bush $\Phi 20 \times \Phi 12 \times 81 \text{mm}$
7	1	3478	7.010.0720	Bolts M12*1.25*95
8	1	3469	3.170.0030	Triangle linkage B
9	1	3470	3.340.0300	Bush $\Phi 18 \times \Phi 12.5 \times 24 \text{mm}$
10	4	3467	7.390.0030	Bearings 6001
11	4	3465	7.330.0062	Oil Seal $\Phi 20 \times 28 \times 4$
12	4		3.340.0310	Bush $\Phi 19 \times \Phi 12 \times 9.5 \text{mm}$
13	2		7.390.0220	Bearings 6902
14	2		3.340.0280	Step Bush $\Phi 20 \times \Phi 10.2 \times 11 - \Phi 15 \text{mm}$
15	1		3.340.0330	Bush $\Phi 18 \times \Phi 12.5 \times 13.5 \text{mm}$
16	1		7.010.0690	Bolts M12*1.25*83
17	2		7.210.0180	Washer $\Phi 12 \times \Phi 24 \times 1.5$

SWINGARM PARTS ASSEMBLY (Suspensions & Swingarm)

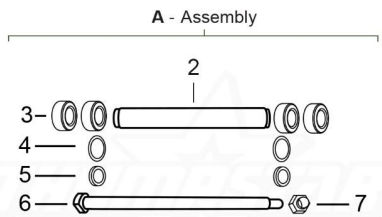

POS.	QTY	PART NO	ERP CODE	ENGLISH NAME
A	1	3730		Swingarm Complete Assembly
2	1		3.340.0170	Inner spacer $\Phi 22 \times \Phi 18 \times 152 \text{mm}$
3	4	3384	7.390.0040	Bearing 6002
4	2		7.330.0030	Oil seal $\Phi 22 \times 32 \times 7$
5	2		3.340.0080	Spacer $\Phi 22 \times \Phi 15 \times 8.5 \text{mm}$
6	1		3.320.0020	Swingarm axle $\Phi 15 \times M14 \times 1.5 \times 240$
7	1		7.140.0050	Nut M14*1.5

SWINGARM (Suspensions & Swingarm)

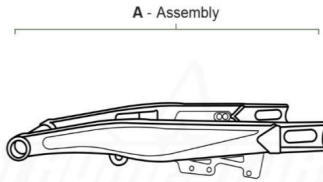

POS.	QTY	PART NO	ERP CODE	ENGLISH NAME
A	1	3383	3.510.0470	16 inch $\Phi 25$ hole Swingarm Steel

CHAIN SLIDER (Suspensions & Swingarm)

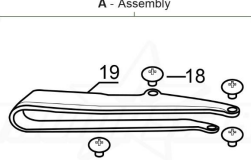

POS.	QTY	PART NO	ERP CODE	ENGLISH NAME
A	1	3385		Chain Slider Complete Assembly
18	4		7.050.0010	Bolt M6*10
19	1		3.350.0020	Chain Slider

CHAIN ADJUSTER (Suspensions & Swingarm)

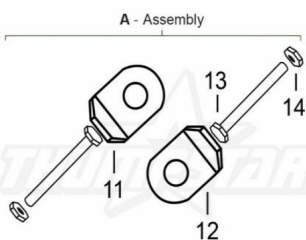

POS.	QTY	PART NO	ERP CODE	ENGLISH NAME
A	1	3731		Chain Adjuster Complete Assembly
11	1	3420	3.690.0110	Left alloy chain adjuster
12	1	3421	3.690.0111	Right alloy chain adjuster
13	2		7.020.0081	Bolt M8*60
14	2		7.180.0040	Nut M8

CHAIN GUIDE (Suspensions & Swingarm)

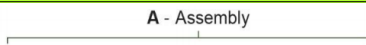

POS.	QTY	PART NO	ERP CODE	ENGLISH NAME
A	1	3386		Chain Guide Complete Assembly
8	1		2.100.0070	Chain guard
8-1	2		2.080.0010	Spacer



9	2		7.010.0171	Screw M8*45
10	1		7.010.0120	Screw M8*16

FORK ASSEMBLY (Suspensions & Swingarm)

A - Assembly

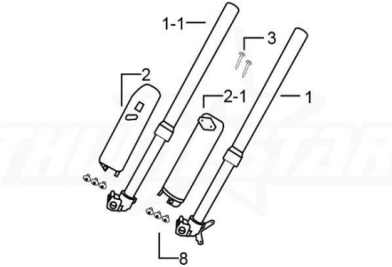

POS.	QTY	PART NO	ERP CODE	ENGLISH NAME
A	1	3732		Fork Complete Assembly
1	1	3387	3.270.1295	R. Front Fork 850mm*53*58.5 unadjustment
1-1				L. Front Fork 850mm*53*58.5 unadjustment
2	1	3389	3.290.0120	R. Front Fork Cover
2-1				L. Front Fork Cover
3	2		7.100.0070	Screws 4.2*20
8	6			Screws

FORK GUARD (Suspensions & Swingarm)

A - Assembly

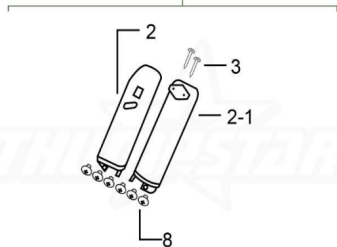

POS.	QTY	PART NO	ERP CODE	ENGLISH NAME
A	1	3389		Fork Guard Complete Assembly
2	1		3.270.1295	R. Front Fork Cover
2-1				L. Front Fork Cover
3	2		3.270.1295	Screws 4.2*20
8	6			Screws

REAR SUSPENSION (Suspensions & Swingarm)

A - Assembly

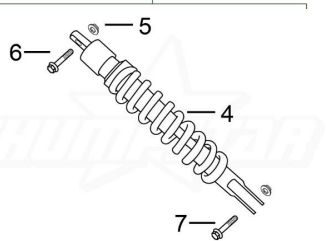

POS.	QTY	PART NO	ERP CODE	ENGLISH NAME
A	1	3390		Rear Suspension Complete Assembly
4	1		3.280.0760	Rear Shock 450mm*Φ12 adjustment
5	2		7.140.0030	Lock Nuts M10*1.25
6	1		7.010.0530	Bolts M10*1.25*60
7	1		7.010.0460	Bolts M10*1.25*45

HANDLE BAR (Handle Bar & Hand Controls)

A - Assembly

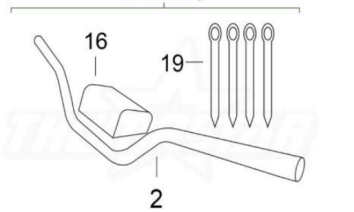

POS.	QTY	PART NO	ERP CODE	ENGLISH NAME
A	1	3734		Handle bar Complete Assembly
16	1	3367	6.040.0040	Handlebar Pad 72mm
2	1	3022	4.010.0220	Alloy Fat Bar Φ28.5*22.2
19	4	3059	8.010.0080	Belts 75mm

KILL SWITCH (Handle Bar & Hand Controls)

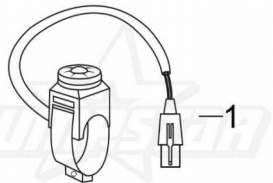



POS.	QTY	PART NO	ERP CODE	ENGLISH NAME
1	1	3485	5.130.0030	Off Switch

ON SWITCH (Handle Bar & Hand Controls)

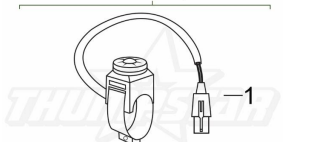
A - Assembly

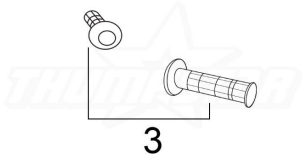
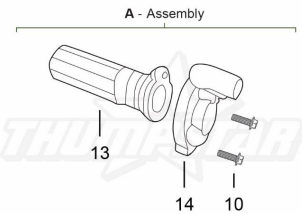
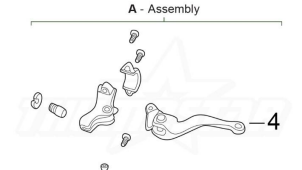
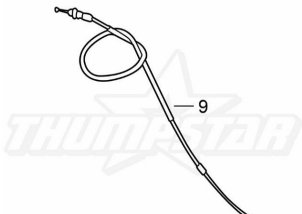
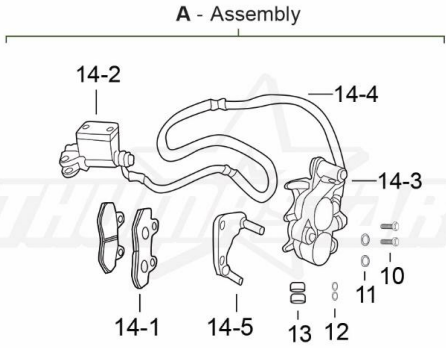
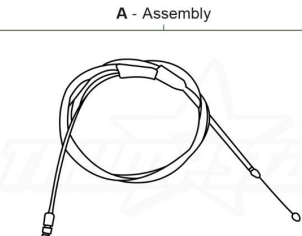

POS.	QTY	PART NO	ERP CODE	ENGLISH NAME
1	1	3374	5.130.0050	Switch ON

GRIP (Handle Bar & Hand Controls)		POS.	QTY	PART NO	ERP CODE	ENGLISH NAME
		3	1set	3323	4.030.0030	Grip Complete Assembly
THROTTLE (Handle Bar & Hand Controls)		POS.	QTY	PART NO	ERP CODE	ENGLISH NAME
<p>A - Assembly</p> 		A				Throttle Complete Assembly
		14	1	3350	4.020.0010	Cable Tube sleeve
		13	1	3245	4.050.0120	Throttle Perch
		10				Screws
CLUTCH LEVER (Handle Bar & Hand Controls)		POS.	QTY	PART NO	ERP CODE	ENGLISH NAME
<p>A - Assembly</p> 		4	1	3393	4.290.0030	Clutch Lever
THROTTLE CABLE (Handle Bar & Hand Controls)		POS.	QTY	PART NO	ERP CODE	ENGLISH NAME
		9	1	3372	4.110.0400	Throttle Cable M10*1.25
FRONT BRAKE ASSEMBLY (Handle Bar & Hand Controls)		POS.	QTY	PART NO	ERP CODE	ENGLISH NAME
<p>A - Assembly</p> 		A	1	3391		Front Brake Complete Assembly
		10	2		7.010.0170	Bolts M8*40
		11	2		7.210.0080	Washers Φ8*Φ16
		12	2		7.220.0020	Washers Φ8
		13	2		3.330.0090	Spacer Φ8.5*Φ15*5
		14	1	3391	4.160.0170	Front Brake Assy
		14-1	1	7408	4.450.0040	Brake pads
		14-2	1		4.410.0020	Master cylinder
		14-3	1		4.420.0120	Bottom pump
		14-4	1		4.180.0110	1230mm Front Brake Hose
		14-5	1	3444	4.350.0040	Bracket
CHOKE CABLE (Handle Bar & Hand Controls)		POS.	QTY	PART NO	ERP CODE	ENGLISH NAME
<p>A - Assembly</p> 		A	1	3419	4.130.0050	Choke Cable
BRAKE LEVER (Handle Bar & Hand Controls)		POS.	QTY	PART NO	ERP CODE	ENGLISH NAME
<p>A - Assembly</p> 		A	1	3756		Brake lever Complete Assembly
		12-2	1		4.310.0111	Brake lever
		6	2		7.010.0170	Bolts M8*40



BRAKE PADS (Wheels & Brakes)	
A - Assembly	

POS.	QTY	PART NO	ERP CODE	ENGLISH NAME
A	1	3757		Brake Pads Complete Assembly
5-1	1set		4.450.0050	Brake pads
5-2	1		4.210.0010	Clip
5-3	1		7.230.0010	Pin Φ 1.5*16

FRONT WHEEL ASSEMBLY (Wheels & Brakes)	
A - Assembly	

POS.	QTY	PART NO	ERP CODE	ENGLISH NAME
A	1	3758		Front Wheel Complete Assembly TSF150
		7896		Front Wheel Complete Assembly TSF230
		7897		Front Wheel Complete Assembly TSF250
1	1	7883	3.070.0490	Alloy front wheel 17"
1	1	7884		Alloy front wheel 19"
1	1	3396		Alloy front wheel 21"
1-1	1		3.020.0681	Alloy rim 1.6*21
1-2	36		3.050.0030	Nipple 9K
1-3	1		3.010.0150	Hub
1-4	36		3.040.0055	Spokes 250-3 225mm
1-5	2	6302	7.390.0160	Bearings 6302
1-6	2		7.330.0101	Oil seal Φ 25*42*7
6	1		3.130.0011	Front wheels axle Φ 20 * 217 - step Φ 25-44mm
7	1		3.330.0860	Front wheel left spacer Φ 30* Φ 20.2*24- Φ 26
8	1		3.330.0870	Front wheel right spacer Φ 30* Φ 20.2*28- Φ 2
9	1		3.110.0020	Rim Lock - Alloy
10	1		3.030.0070	21" Rim belt

FRONT TYRE ASSEMBLY (Wheels & Brakes)	
A - Assembly	

POS.	QTY	PART NO	ERP CODE	ENGLISH NAME
A	1	7885		Front Tyre Complete Assembly 80/100-17
A	1	7886		Front Tyre Complete Assembly 80/100-19
A	1	3759		Front Tyre Complete Assembly 80/100-21
2	1	3389	3.090.0860	Front Knobby tires 80/100-21
2-1	1		3.090.0861	Inner Tube of front tyre
2-2	1		3.090.0862	Front outer tyre TSX150
				Front outer tyre TSX230
				Front outer tyre TSX250

FRONT DISC (Wheels & Brakes)	
A - Assembly	

POS.	QTY	PART NO	ERP CODE	ENGLISH NAME
A	1	3394		Front Disc Complete Assembly
3	1		4.230.0180	Front brake disc Φ 260*101
4	6		7.060.0040	Bolts for install plate M6*20
5	6		7.160.0030	Nut M6

FRONT AXLE ASSEMBLY (Wheels & Brakes)	
A - Assembly	



POS.	QTY	PART NO	ERP CODE	ENGLISH NAME
A	1	3760		Front Axle Complete Assembly
6	1		3.130.0011	Φ 20*217 Front wheels axle Φ 25-44mm
6-1	1		3.130.0020	Nut for axle M16*1.5*23
7	1		3.330.0860	Front wheel left spacer Φ 30* Φ 20.2*24- Φ 26
8	1		3.330.0870	Front wheel right spacer Φ 30* Φ 20.2*28- Φ 26

FRONT WHEEL BEARING (Wheels & Brakes)	

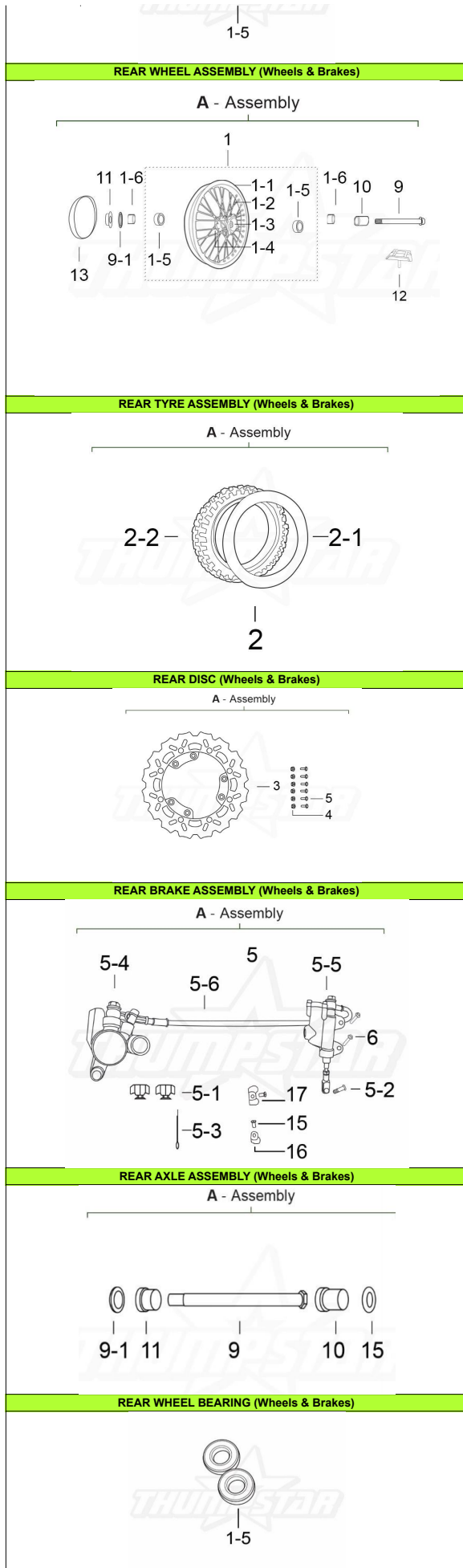
POS.	QTY	PART NO	ERP CODE	ENGLISH NAME
1-5	2	6005	7.390.0070	6005 Rear Bearings

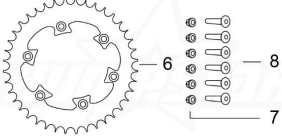

POS.	QTY	PART NO	ERP CODE	ENGLISH NAME
A				Rear Wheel Complete Assembly TSF150
A				Rear Wheel Complete Assembly TSF230
A				Rear Wheel Complete Assembly TSF250
1	1	7889	3.080.0400	Alloy rear wheel 14"
1	1	7890		Alloy rear wheel 16"
1	1	3379		Alloy rear wheel 18"
1-1	1		3.020.0060	Alloy Rim 2.15*18
1-2	1		3.010.0160	Hub
1-3	32		3.050.0030	Nipple 9K
1-4	32		3.040.0260	Spokes 250-6 176mm
1-5	3	6005	7.390.0070	Bearings 6005
1-6	2		7.330.0070	Oil Seal Φ30*47*7
9	1		3.130.0030	Φ25*242 Rear wheel axle Φ40-28mm
9-1	1		3.130.0050	Nut M24*1.5
10	1		3.330.0930	Rear wheel axle left spacer Φ36*Φ25.2*33-Φ32
11	1		3.330.0891	Rear wheel axle right spacer Φ36*Φ25.2*21-Φ32
12	1	3108	3.110.0040	Rim Lock -Alloy
13	1		3.030.0040	18" Rim belt
A				Rear Tyre Complete Assembly TSX150
A				Rear Tyre Complete Assembly TSX230
A				Rear Tyre Complete Assembly TSX250
2	1	7891	3.090.0870	Rear Knobby tires 100/90-14
2	1	7892		Rear Knobby tires 100/90-16
2	1	3399		Rear Knobby tires 100/90-18
2-1	1		3.090.0871	Inner tube of Rear tires
2-2	1		3.090.0872	Rear outer tire
A	1	3395		Rear Disc Complete Assembly
3	1		4.230.0180	Front brake disc Φ260*101
4	6		7.060.0040	Bolts for install plate M6*20
5	6		7.160.0030	Nut M6
A	1	3763		Rear Brake Complete Assembly
5	1	3392	4.170.0173	Rear Brake system M6*80
5-1	1set		4.450.0050	Brake pads
5-2	1		4.210.0010	Clip
5-3	1		7.230.0010	Pin Φ1.5*16
5-4	1			Upper pump TSX150
5-4	1			Upper pump TSX230
5-4	1	4.410.0090		Upper pump TSX250
5-5	1	4.420.0060		Bottom Cylinder
5-6	1	4.190.0090		Brake oil pipe 520mm
6	2	7.010.0040		Bolts M6*25
15	2	7.090.0030		Bolt M6*12
16	1	3042	7.430.0010	Buckle
17	1	3049	7.430.0020	Buckle
A	1	3764		Rear Axle Complete Assembly
9	1		3.130.0011	Φ25*242 Rear wheel axle Φ40-28mm
9-1	1		3.130.0050	Nut M24*1.5
10	1		3.330.0930	Rear wheel axle left spacer Φ36*Φ25.2*33-Φ32
11	1		3.330.0891	Rear wheel axle right spacer Φ36*Φ25.2*21-Φ32
15	1		7.210.0300	Flat Washers Φ25*Φ45*3
1-5	2	6005	7.390.0070	Rear Bearings 6005

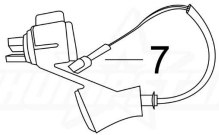
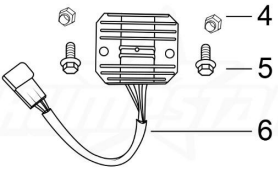
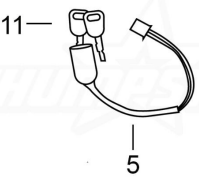
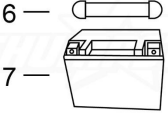
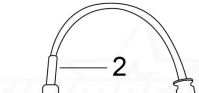
CHAIN (Wheels & Brakes)		POS.	QTY	PART NO	ERP CODE	ENGLISH NAME
		8	1	3401	2.010.0730	520*106L Chain
SPROCKET (Wheels & Brakes)		POS.	QTY	PART NO	ERP CODE	ENGLISH NAME
<p>A - Assembly</p> 		A	1	3400		Sprocket Complete Assembly
		6	1		2.040.0530	Rear sprocket 520*125*43
		7	6		7.140.0020	Nut M8
		8	6		7.040.0060	Bolt M8*35
CDI (Electrical Parts)		POS.	QTY	PART NO	ERP CODE	ENGLISH NAME
<p>A - Assembly</p> 		A	1	3404		CDI Complete Assembly
		1	1		5.090.0135	CDI
		2	1		8.010.0010	Zip Tie
RELAY (Electrical Parts)		POS.	QTY	PART NO	ERP CODE	ENGLISH NAME
<p>A - Assembly</p> 		A				Relay Complete Assembly
		7	1	3407	5.060.0020	12V Relay
RECTIFIER (Electrical Parts)		POS.	QTY	PART NO	ERP CODE	ENGLISH NAME
<p>A - Assembly</p> 		A	1	3406		Rectifier Complete Assembly
		4	2		7.190.0010	Nut M6
		5	2		7.010.0010	Bolt M6*12
		6	1		5.050.0050	Rectifier
IGNITION KEY SWITCH (Electrical Parts)		POS.	QTY	PART NO	ERP CODE	ENGLISH NAME
<p>A - Assembly</p> 		A	1	3408		Ignition Key Complete Assembly
		5	1		5.150.0040	Electric door lock
		11	2			Keys
BATTERY BOX (Electrical Parts)		POS.	QTY	PART NO	ERP CODE	ENGLISH NAME
<p>A - Assembly</p> 		A				Battery Box Complete Assembly
		6	1	3409	5.020.0040	12V6AH Battery
		7	1	3412	6.310.0030	Bandage for battery
IGNITION COIL (Electrical Parts)		POS.	QTY	PART NO	ERP CODE	ENGLISH NAME
<p>A - Assembly</p> 		A	1	3405		Ignition Coil Complete Assembly
		2	1		5.030.0060	Ignition coil length 230mm
		3	1		7.010.0030	Bolt M6*20

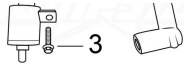

WIRE HARNESS (Electrical Parts)

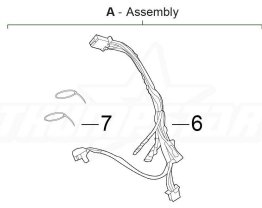

POS.	QTY	PART NO	ERP CODE	ENGLISH NAME
A	1	3410		Wiring Loom Complete Assembly
6	1		5.010.0520	Wire Loom
7	1		8.010.0010	Zip Tie

PLASTICS ASSEMBLY (Plastics & Fuel Tank)

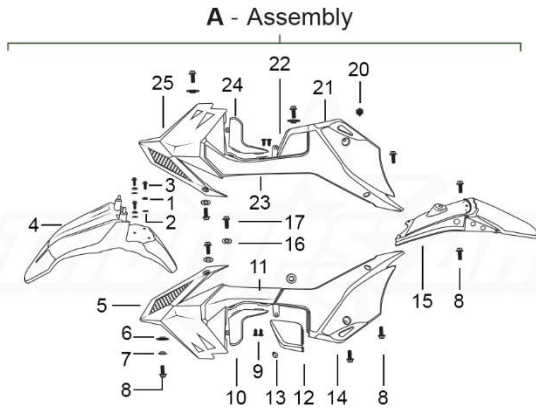

POS.	QTY	PART NO	ERP CODE	ENGLISH NAME
A	1	3766		Plastic Complete Assembly
1	2		3.340.0420	Spacer $\phi 19 \times \phi 8.5 - \phi 6 \times 5.5 \text{mm}$
2	4		7.210.0070	Flat washer $\phi 6 \times \phi 18 \times 1.5$
3	4		7.010.0020	Bolt M6*16
4	1	3430	6.130.0180	Front fender
5	1	3432	6.150.0190	Front left side plate
6	2		7.140.0010	Nut M6
7	2		3.340.0380	Step bushings $\phi 7 \times 4.5 - \phi 9.5 \times 2.5 - \phi 20 \text{mm}$
8	8		7.010.0020	Bolt M6*16
9	4		7.100.0030	Bolt 4.2*12
10	1	3439	6.170.0160	Left middle down side plate
11	1	3430	6.170.0150	Left middle up side plate
12	1		6.190.0161	Rear left down side plate
13	3		7.100.0020	Bolt 4.2*8
14	1	3447	6.190.0150	Rear left side plate
15	1	3431	6.140.0180	Rear fender
16	4		7.210.0060	Flat washer $\phi 6 \times \phi 16$
17	4		7.010.0010	Bolt M6*12
18	2		7.100.0110	Bolt 4.8*16
20	1	3429	1.088.0040	The insulation rubber pad
21	1	3448	6.200.0140	Rear right side plate
22	1	3442	6.200.0150	Rear right side plate
23	1	3435	6.180.0140	Right middle up side plate
24	1	3440	6.180.0150	Right middle down side plate
25	1	3433	6.160.0180	Front right side plate

SHOCK GUARD (Plastics & Fuel Tank)

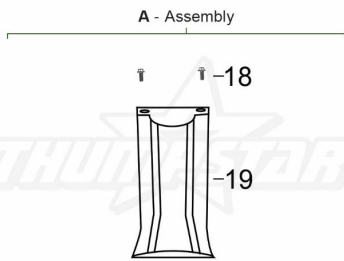

POS.	QTY	PART NO	ERP CODE	ENGLISH NAME
A	1	3438		Shock Guard Complete Assembly
18	2		7.100.0110	Bolt 4.8*16
19	1		6.230.0080	Rear mud

TANK ASSEMBLY (Plastics & Fuel Tank)

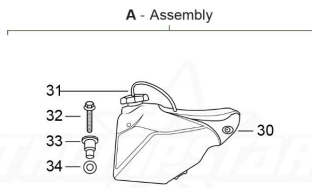

POS.	QTY	PART NO	ERP CODE	ENGLISH NAME
A	1	3767		Tank Complete Assembly
30	1	3403	6.080.0230	Fuel tank
31	1	3427	6.090.0190	Plastic fuel cap
32	1		7.010.0070	Bolt M6*40
33	1		3.340.0360	Spacer for fuel tank $\phi 22 \times \phi 6.5 \times 27 - \phi 12 \text{mm}$
34	1		7.210.0150	Flat washer $\phi 10 \times \phi 22 \times 1.5$

FUEL CAP ASSEMBLY (Plastics & Fuel Tank)

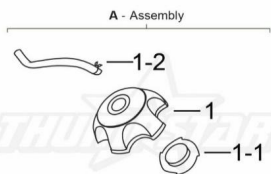

POS.	QTY	PART NO	ERP CODE	ENGLISH NAME
A	1	3052		Fuel Cap Complete Assembly
1-2	1		1.161.0030	Fuel pipe 8.2*4.2
1	1			Cap
1-1	1			Seal

FUEL SWITCH ASSEMBLY (Plastics & Fuel Tank)

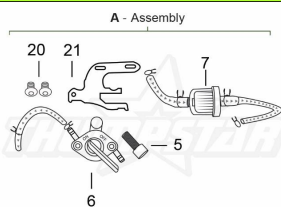

POS.	QTY	PART NO	ERP CODE	ENGLISH NAME
A	1	3769		Fuel Switch Complete Assembly
5	1		7.070.0060	M6*16 Hexagon socket head cap screws
6	1	3051	1.020.0010	ATV Oil tank switch
7	1		1.026.0020	Oil filter
20	2		7.060.0020	M6*10 Hexagon socket head cap screws
			1.018.0020	



SEAT SYSTEM

SEAT ASSEMBLY (Plastics & Fuel Tank)

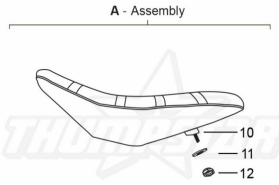

POS.	QTY	PART NO	ERP CODE	ENGLISH NAME
A	1	3402		Seat Complete Assembly
10	1		6.010.0592	Seat
11	1		7.210.0090	Flat washer $\Phi 8 \times \Phi 22$
12	1		7.140.0020	Nut M8

STEERING HEAD BEARING (Steering)

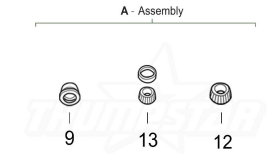

POS.	QTY	PART NO	ERP CODE	ENGLISH NAME
A		3770		Steering Head Bearing Complete Assembly
9	1		7.270.0010	Lock Nuts M25*1*7
13	2	3381	7.350.0080	Taper Bearings $\Phi 25 \times \Phi 52$
12	1	3446	7.210.0330	Flat Washers $\Phi 26 \times \Phi 35 \times 1$

FORK SEALS (Suspensions & Swingarm)

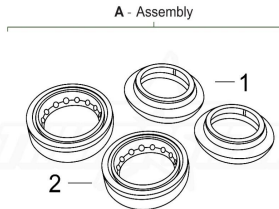

POS.	QTY	PART NO	ERP CODE	ENGLISH NAME
A	4	7650		Fork Seals Complete Assembly
1	2		7.330.0370	Fork Seal
2	2		6.240.0050	Dust seal

CLUTCH CABLE (Handle Bar & Hand Controls)

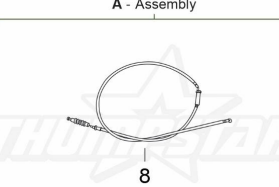

POS.	QTY	PART NO	ERP CODE	ENGLISH NAME
8	\$1.00	3373	4.120.0120	Clutch Cable 900+145mm Complete Assembly

CLUTCH LEVER (Handle Bar & Hand Controls)

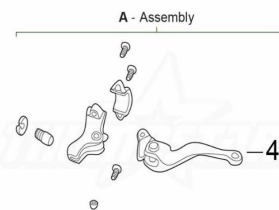

POS.	QTY	PART NO	ERP CODE	ENGLISH NAME
4	1	3393	4.290.0030	Clutch Lever

STATOR (Electrical Parts)

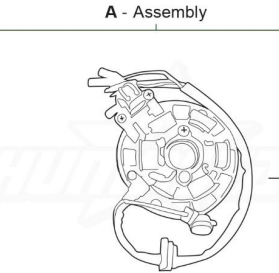

POS.	QTY	PART NO	ERP CODE	ENGLISH NAME
A	1			Stator Complete Assembly
14		3589	1.044.0101	Stator TSX189
14		3771	1.044.0130	Stator TSX230

CARB REPAIR KIT

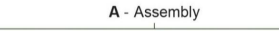

POS.	QTY	PART NO	ERP CODE	ENGLISH NAME
A		3773		TSX230 Carb Repair Kit Complete Assembly

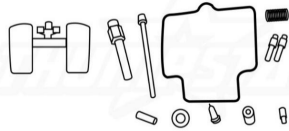

FRONT AND REAR MUD GUARD (Plastics & Fuel Tank)

A - Assembly

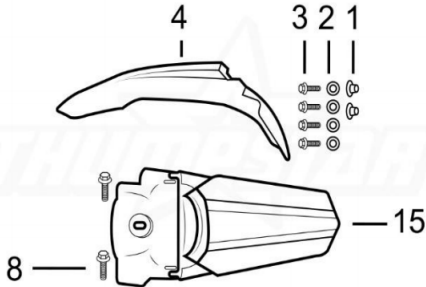

POS.	QTY	PART NO	ERP CODE	ENGLISH NAME
A		3774		Front and Rear Mud Guard Complete Assembly
1	2		3.340.0420	Spacer $\phi 19 \times \phi 8.5 - \phi 6 \times 5.5 \text{mm}$
2	4		7.210.0070	Flat washer $\phi 6 \times \phi 18 \times 1.5$
3	4		7.010.0020	Bolt M6*16
4	1	3430	6.130.0180	Front fender
8	4		7.010.0020	Bolt M6*16
15	1		6.140.0180	Rear fender

HEADLIGHT ASSEMBLY (Plastics & Fuel Tank)

A - Assembly

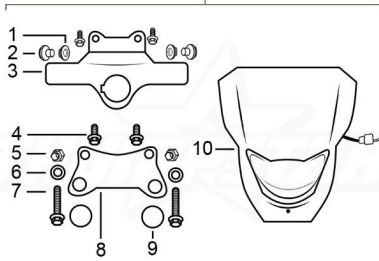

POS.	QTY	PART NO	ERP CODE	ENGLISH NAME
A	1	3775		Headlight Complete Assembly
1	2		7.190.0010	M6 Nut
2	2		7.050.0020	M6*16 Bolt
3	1	3451	3.750.0195	Bracket
4	2		7.010.0010	M6*12 Bolt
5	2		7.170.0020	M6 Nut
6	2		7.210.0070	$\phi 6 \times \phi 18 \times 1.5$ Flat washer
7	2		7.010.0060	M6*35 Bolt
8	1	3450	3.750.0190	Bracket
9	2	3096	6.250.0020	CRF110 Plastic stopper
10	1	3445	5.120.0040	Front light

NUMBER PLATE (Plastics & Fuel Tank)

A - Assembly

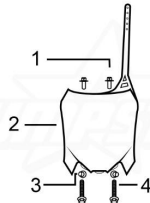

POS.	QTY	PART NO	ERP CODE	ENGLISH NAME
A	1	3776		Number Plate Complete Assembly
1		3451	7.010.0020	M6*16 Bolt
2		3436	6.110.0230	Number plate
3			7.170.0020	M6 Nut
4			7.010.0060	M6*35 Bolt