

# Installation for TX/TX Gator Canopy

## Part Number: #JG21G



**Installation Time: 60 minutes**

Tools Required:

- Ratchet
- 7/16", 1/2", and 9/16" socket
- 7/16" and 9/16" wrench
- Drill
- 9/32" drill bit
- 5/8" drill bit

# Hardware Kit:

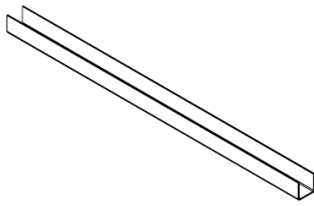

Front Support Channel

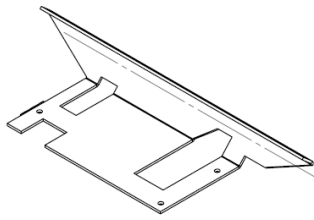

Front Bracket

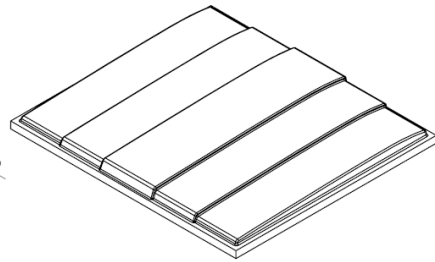

Canopy

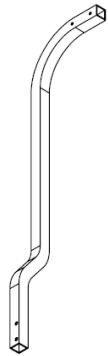

Driver's Side Rear Support

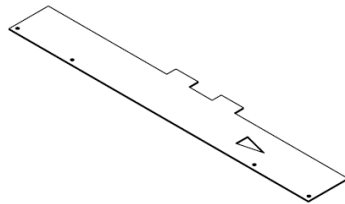

Template

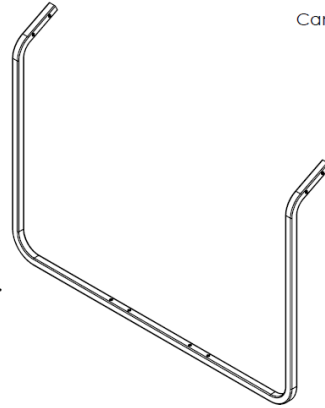

Front Support

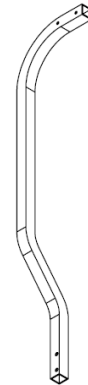

Passenger's Side Rear Support



2 - Rear Support Gaskets

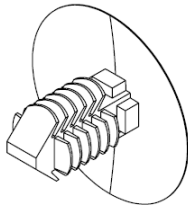

2 - Christmas Tree Plugs

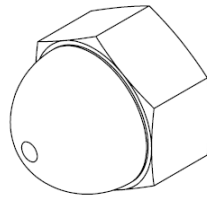

2 - Acorn Nuts

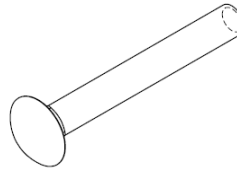

2 - 5/16"-18 x 2.5" Carriage Bolts

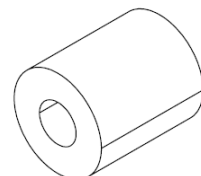

2 - Aluminum Spacers

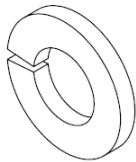

8 - 1/4" Lock Washers



11 - 1/4" Flat Washers

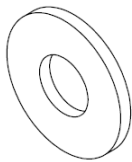

4 - 5/16" Sealing Washers

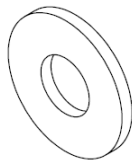

8 - 3/8" Sealing Washers

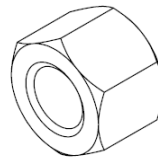

3 - 1/4"-20 Lock Nuts

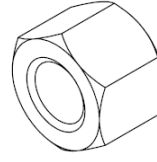

2 - 5/16"-18 Lock Nuts

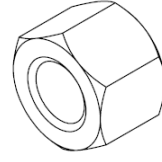

4 - 3/8"-16 Lock Nuts

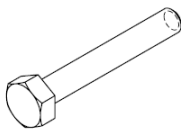

3 - 1/4"-20 x 1.75" Hex Head Bolts

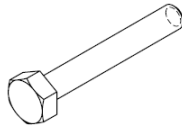

4 - 3/8"-16 x 2.5" Hex Head Bolts

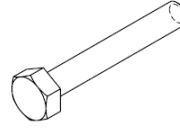

4 - 1/4"-20 x 2" Hex Head Bolts with Loctite

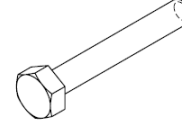

4 - 1/4"-20 x 1.5" Hex Head Bolts with Loctite

**Do not use power tools to tighten down any of the bolts in this assembly**

### Step 1: Drill Hole Placements

Locate the triangles on the bottom outside corners of the hood. Pull to release the clips and lift the hood up and off the Gator.

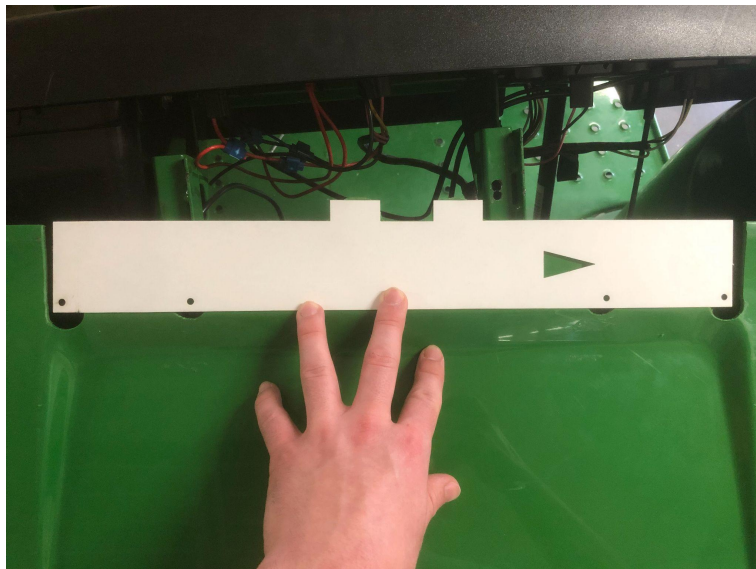

Place the paper template on the top of the hood with the arrow pointing towards the driver's side. Line up the tabs on the paper with the corresponding tabs on the hood. Secure the template in place and mark the location of the holes. Use the widest hole spread the front support allows for.

Drill two 5/8" holes through the hood in the marked locations. Slot the holes towards the rear of the vehicle.



## Step 2: Install the Front Bracket

Place the front bracket down and push all the way to the right so that the tab on the left side of the front bracket is flush with the frame of the Gator. Then slide upwards so the cutout on the left side of the front bracket hits the vertical flange on the Gator frame. Secure the bracket in place and then mark the hole locations.



Drill 9/32" holes in the rails in the marked locations. CAUTION! Ensure that the wires are out of the way before drilling.

Use the 1/4"-20 x 1 1/2" bolts, 1/4" flat washers, and 1/4"-20 lock nuts to secure the front bracket in place.



### Step 3: Install the Front Support

Place the carriage bolts up through the front bracket in the holes corresponding to the hole spread drilled on the hood. Place a spacer on each carriage bolt and a 5/16" sealing washer, rubber side up, on top of the spacer.



Next install the front support channel over the washers. With the channel in place, install the front support over the studs.

Secure the support with a pair of 5/16" washers, rubber side down, then use 5/16" locknuts. Do not completely tighten the nuts until the canopy is installed. Cover the exposed studs with the black acorn nuts after securing the nuts.



#### Step 4: Install the Rear Supports

Locate the green triangle that is below the seats, you may have to tilt the seat forward to access this area.



Use a 3/8" bolt and a 3/8" seal washer on the outside of the rear support. Place the PVC gasket on the backside of the rear support and fasten to the triangular bracket with a 3/8" sealing washer and a 3/8" lock nut on the backside of the bracket.

Secure the supports, but do not tighten all the way. Repeat this process for the other side's support and tilt the seats back if necessary. Make sure the rear supports are perpendicular to the ground.



### Step 5: Install the Canopy

Locate the seam on the black band around the canopy top, and position the canopy with the seam side towards the rear of the vehicle. Line up the rear supports with the corresponding pocket in the canopy.



Secure the front support to the canopy using 4 - 1.5"  $\frac{1}{4}$ "-20 loctite bolts, lock washers and flat washers. Secure the rear supports to the canopy using 4 - 2"  $\frac{1}{4}$ "-20 loctite bolts, lock washers and flat washers.

### Step 6: Final Alignment

With all bolts in place, align the canopy with the frame and then tighten all bolts. As a reminder, do not use power tools to secure any of the bolts.

### Step 7: Re-Install the Hood

Line up the slots on the hood with the carriage bolts on the front bracket.



Slowly lower the hood over the exposed studs until it latches back in place. The hood may need to be bent slightly to fit over the studs. When the hood is returned to its position make sure that both the studs and the nuts are exposed.