

PRODUCTION NOTES:
 1. ASSEMBLY TO BE DONE ON SITE
 BY THE CUSTOMER. ALL ITEMS TO
 BE SHIPPED LOOSE.

ITEM	QTY	PART #	DESCRIPTION
1	1	23367	FLANGE BOLT DISCHARGE
2	2	27928	UNDERBIN SUPPORT HEIGHT ADJUSTMENT
3	2	23590	UNDERBIN CONVEYOR SUPPORT UPRIGHT
4	2	38657	PIVOT ASSM FLOOR MOUNT RECEIVING END RED
5	16	19068	Plain Washer (Inch)Type A and B
6	10	19343	NUT, HEX 3/8-16 UNC
7	4	18486	1/2" Regular Helical Spring Lock Washers(Inch Series)
8	6	19618	BOLT, HEX, 3/8-16 UNC X 1.75 Steel, Mild
9	6	19369 MS	NUT, HEX 1/2-13 UNC Steel, Mild
10	2	18354	BOLT, HEX, 1/2-13 UNC X 3.75 Steel, Mild
11	4	18464	BOLT, HEX, 1/2-13 UNC X 1.5, Steel, Mild
12	4	18266	BOLT, HEX, 3/8-16 UNC X 3 Steel, Mild
13	2	18487	Washer, 1/2 - wide - Type A Steel, Mild
14	2	17131	PLUG, PLASTIC, 2x2x120 WALL SQ BLACK INSERT

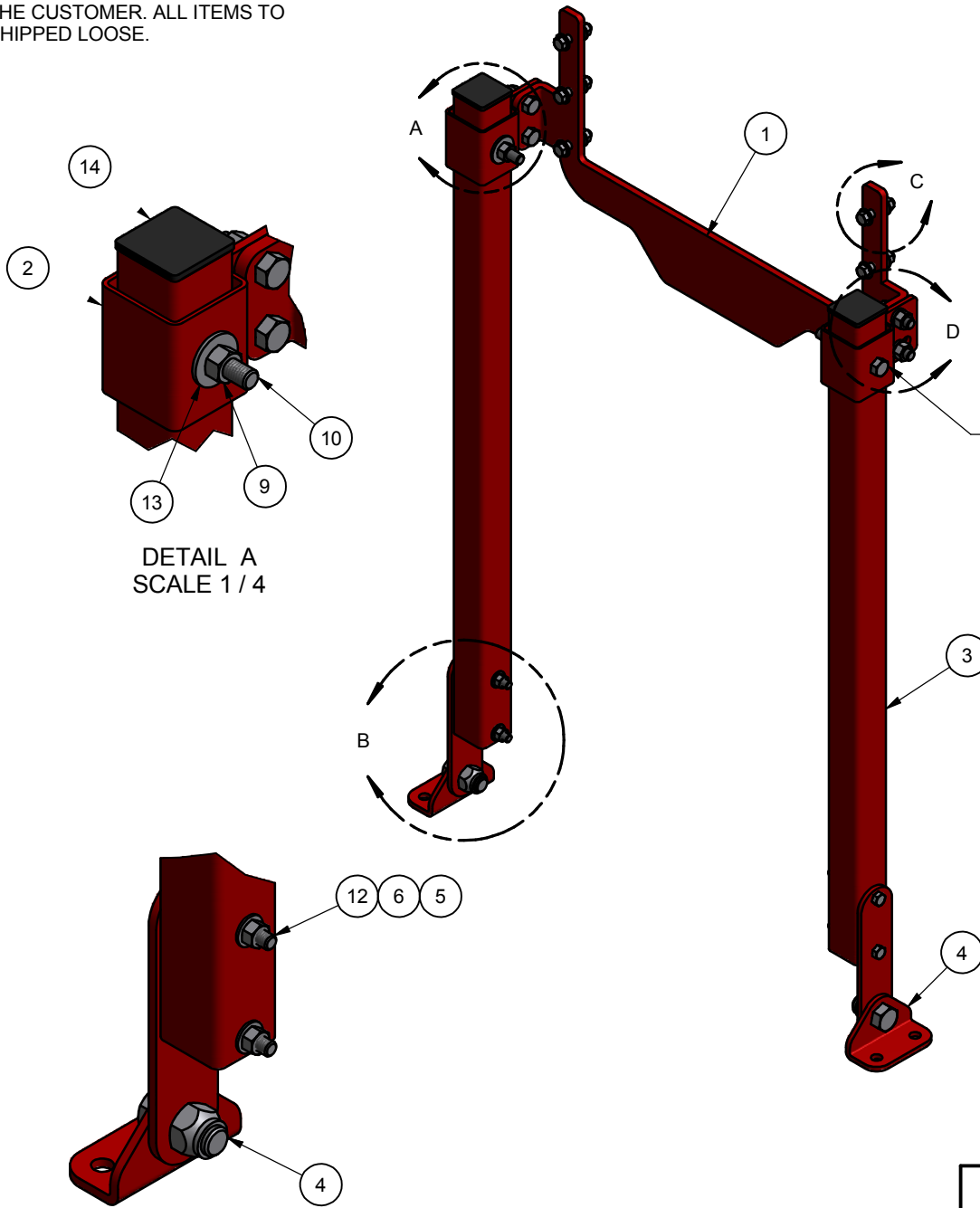

HOLE TO BE DRILLED ON SITE TO ADJUST THE HEIGHT

DETAIL A
SCALE 1 / 4

DETAIL C
SCALE 1 / 4

DETAIL D
SCALE 1 / 4

DETAIL B
SCALE 1 / 4

REVISION HISTORY			
REV	DESCRIPTION	DATE	DESIGNER
A	RELEASED	10/10/2013	BJ S
B	ADDED NOTES - ECO 1697	03/16/2015	GML

 www.meridianmfg.com		PROJECT/CUSTOMER NAME: CONVEYORS	
		PART DESCRIPTION: UNDERBIN SUPPORT FLOOR MOUNT	
<small>THIS DRAWING IS THE EXCLUSIVE PROPERTY OF MERIDIAN MFG INC. DUPLICATION BY ANY MEANS IS PROHIBITED WITHOUT PERMISSION FROM MERIDIAN MFG INC.</small>		MATERIAL:	WEIGHT: 38.21 lbmass
		FABRICATION:	
DRAWN BY: BJ S	DRAWN BY DATE: 10/04/2013	CHECKED BY: BJ S	PART/DRAWING NUMBER: 37496
REV: B	SCALE: 1 / 8	SHEET No: 1 OF 1	