

SCHULTE®

FX-520 *Fighter Series* Rotary Cutter



5 Rotor, Modular Domed Single Deck Design Available with Walking Axles



- Narrow Transport Width -

- 1** The five rotor design optimizes cutting performance, increases productivity and delivers extremely even distribution over competitive 20' models.
- 2** Unique 6 Gear Box layout, 260 hp divider box, 210 hp down boxes, 1000rpm driveline gives unsurpassed cutting performance with higher cut speeds.
- 3** 5 Slip Clutches, 1 at each down box protects the drive line. Also, shear pin at the input shaft on the divider box.
- 4** Continuously welded 7 ga modular deck design improves strength and appearance.
- 5** **Hitch Lift Assist** helps to lift the mower over obstacles so as to prevent undue stress on blades and down shafts.
- 6** A hydraulic phasing cylinder system ensures an accurate parallel lift across the cutter.
- 7** Available Fixed Knife Shredding system for unsurpassed shredding & spreading of cut material.

Quality • Service • Value • Trust

G O N U M B E R O N E . . . G O S C H U L T E !

FX-520 Features

North America's only 5 rotor 20' mower provides an excellent cut rate and improved spread of material

A hydraulic phasing system with integrated central spring suspension ensures a smooth and level cut

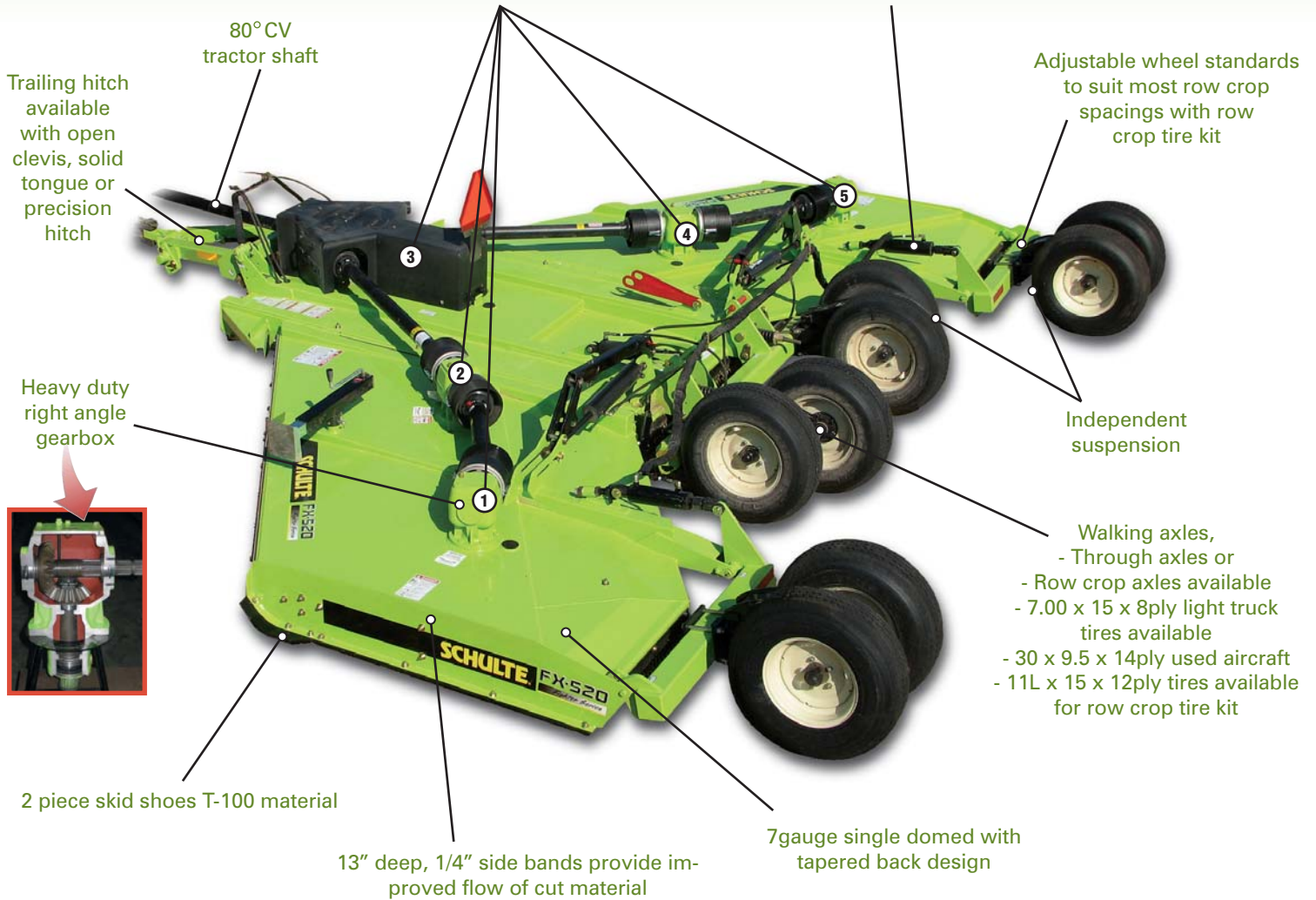

- Can accommodate 30", 32", 38", 40" and 1 meter row spacing. (With 4 tire row crop kit)
- Unparalleled stalk shredding with 5-rotor layout with fixed knives and high spindle speeds.
- Unique 2-rotor wing design reduces hitch load.
- Short inside wing drive shafts (less than 15 foot units) reduces drive line problems associated with long drive shafts on most competitive 3 rotor, 20' models
- Sloped back deck design improves material flow and distribution.

- Row Crop Tire Kit Shown -
Four 11L x 15 x 12ply tires



Quality • Service

FX-520 Features

- Non adjustable clutches have cooling fins for maximum clutch disc heat dissipation, which leads to longer life clutch linings. Clutches also have stops so the clutch body cannot be damaged if linings are severely worn.
- The tractor shaft is a Category 7, spline, 80 degree CV to ensure smooth power transfer to the cutter. The center rotor gearbox is driven by a Category 5 splined shaft. The inner wing rotor gearboxes are driven by Category 6 Tri-Lobe shafts. The outer wing rotor gearboxes are driven by Category 5 Tri-Lobe shafts. All shafts include a friction clutch which protects the drive system from a rotor overload or from an unexpected obstacle.
- The FX-520 is available in a Fixed Knife Shredder unit or Stump Jumper Pan unit.
- Floating Hitch provides excellent ground following capabilities.
- Spring steel bushings are installed at all vital pivot points.
- Deck protection rings stop blades from contacting the deck.
- A pentagon blade bolt design provides added strength and wear resistance on a pan unit.
- Easy to replace safety chains.
- Replaceable skid shoes.

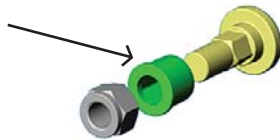

Tandem Walking Axles work great for Highway & Road-side mowing

Unsurpassed Cutting Performance; unparalleled Stalk & Straw Shredding & Spreading



Corn Stalks



Excellent Shredding and Distribution



Wheat Straw



Stationary Fixed Knife system and strategically placed baffles ensure proper chop and spread

Value • Trust

FX-520 Specifications

SPECIFICATIONS

Cutting Width	240" (6.1m)
Overall Width	247" (6.2m)
Overall Length	242" (6.15m)
Cutting Height	2" - 17.5" (51mm - 445mm) (depending upon tire size)
Transport Width	104" (2.64m)
Transport Height	120" (3.05m)
Weight	6525 lbs (2960kg) (single chain, 6 tires, pans)
Hitch Weight	2280 lbs (1034kg) (single chain, 6 tires, pans)
Cutting Capacity	2" (51mm) (Fixed Knife Unit) 4" (102mm) (Pan Unit)
Minimum Tractor Size	100 hp (75kw)
Blade Tip Speed	16000 ft/min (4900m/m)
Blade Overlap	6" (153mm)
Divider Box rating	260 hp (194kw)
Down Box rating	210 hp (157kw)
Deck Thickness	.180" (7 ga) (4.6mm)
Skirt Thickness	1/4" (6.4mm)
Wing Operating Range	20degrees down to 90 degrees up
Wing Float Range	20degrees down to 40 degrees up

* Divider box has 1.75" 20 spline input and output shafts.

* Down boxes have 1.75" 20 spline input shafts and 2.375" down shafts.



- Open Clevis Hitch -



- Solid Tongue Hitch -



- Precision Hitch -



- Fixed Knife unit shown -



- Pan unit with stump jumpers -



- Optional Deck Debris Fan Kit -

FX-520 OPTIONS

Tractor shafts 1 3/8" or 1 3/4"; Precision hitch; Clevis or solid tongue hitches; Pan unit with updraft blades or shredder blade kit; Fixed knife kit with updraft or flat bottom blades; Single or double chains; Half length front belting; 4 tire kit for row crop cutting; 6 or 8 tire kit with duals or walking axles, Cyclone Deck Debris Fan kit

SCHULTE



Schulte Industries Ltd.

P.O. Box 70, Englefeld, Saskatchewan, Canada S0K 1N0

Tel: (306) 287-3715 Fax: (306) 287-3355

E-Mail: info@schulte.ca

Visit our Web site at: www.schulte.ca

Schulte is a registered trademark of Alamo Group Inc.

Schulte Industries Ltd. reserves the right to change the design, specification of its products without notice. Illustrations may include optional equipment and accessories, and may not include all standard equipment.



Sold By:

PRINTED IN CANADA

PREPARED by NELSON GRAPHIC DESIGN

201108